

Unprecedented Side Cable Type

2mm Pitch Crimp Connector

FBC SERIES

Sideways-drawing-type cable

- No excessive stress applied cable
- Reduces wasted space

E-lock mechanism

- One-touch connection
- Easy withdrawal

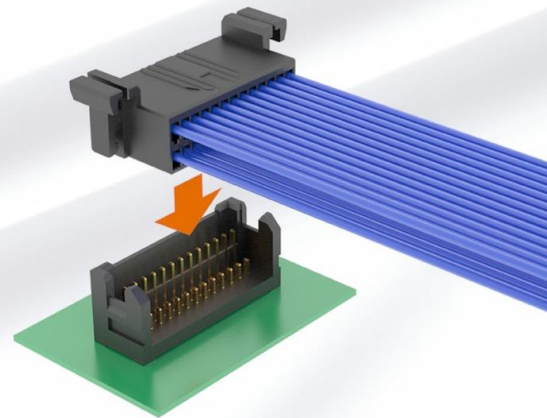

Outline of FBC Series products

Pitch	2 mm
Connection type	Board to cable connection Board side DIP solder
Cable connection	Crimp cables (AWG#22, 24, 26)
Number of pins	26, 36, 40 pins
Environmentally friendly	RoHS-compliant product

Stack connection, Side cable type

Stacked mating and side cable type prevents disconnection and removes stress from cables

Conventional products

FBC Series

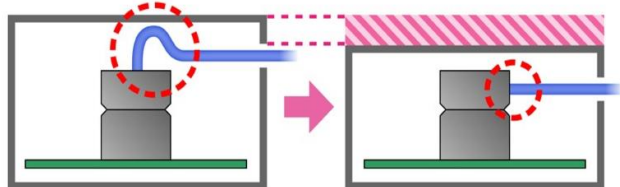

Excessive stress applied to cable

No excessive stress applied to cable and reduces wasted space

Conventional products

FBC Series

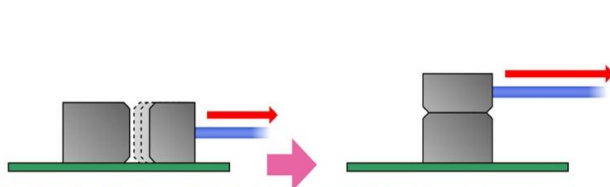

Mating from the side, thus unintended disconnection can easily occur

Mating from the top, thus prevents unintended disconnection

E-lock Mechanism improves operability and connection stability

Insertion

Align and mate from straight above and push top of connector until "Click" can be felt.

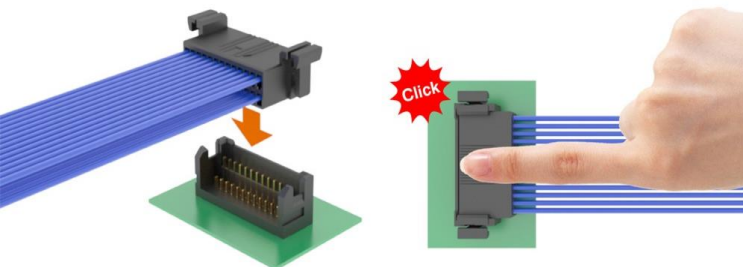

Withdrawal

Hold both sides of the E-Lock, press and pull up for withdrawal

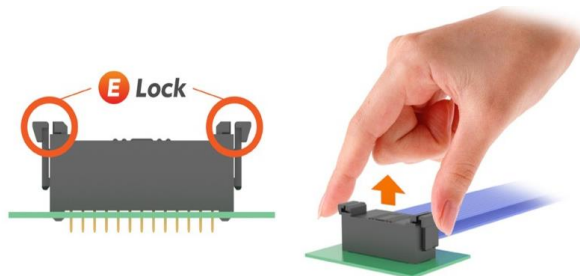

B.C.E. s.r.l.
Via Regina Pacis, 54/c - 41049 SASSUOLO (MO) Italy
Tel. +39 0536 811.616 r.a. - Fax +39 0536 811.500
www.bce.it - E-mail: bce@bce.it

