



IP67



● SA Series IP67

● Push-pull coupling

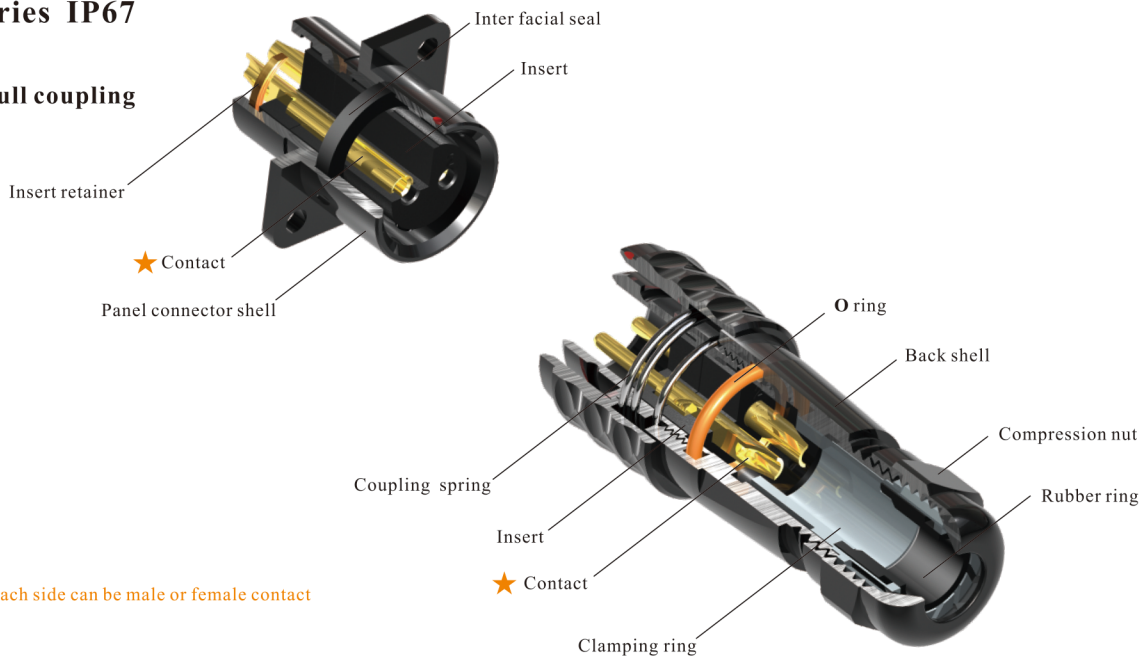

★ Each side can be male or female contact

Material and spec

Coupling	Push-pull		
Shell material	Anodized aluminium		
Insert material	PPS, max temperature 260 °C		
Contact material	Brass with gold plating		
Termination	Solder: SA6, SA8, SA10, SA12, SA16, SA20, SA28 Crimp: SA16, SA20, SA28 Screw: SA20, SA28		
Cable outer diameter range	SA6: 3.5-4mm SA8: 4-5mm SA10: 4-6.5mm	SA12: I: 4-6.5mm, II: 5-8mm SA16: I: 5-8mm, II: 8-12mm SA20: 8-12mm	SA28: 13-16mm
IP rating	IP67		
Mating cycle	500		
Temperature range	-40°C ~ +85°C		
Insulation resistance	2000 MΩ		

**SA6 Series**



Cable connector  
Mate with SA611, SA612,  
SA615

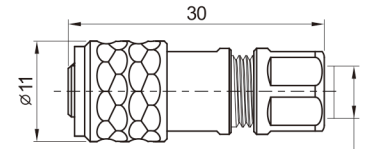
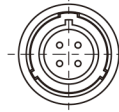

Cable outer diameter range: 3.5-4mm

**SA610 / P** — **SA610 / S** —  
Male contact

Colour:  
B: Black  
S: Silver  
L: Blue (special order)  
G: Green (special order)  
R: Red (special order)  
Number of contact  
Female contact



In-line cable connector  
Mate with SA610

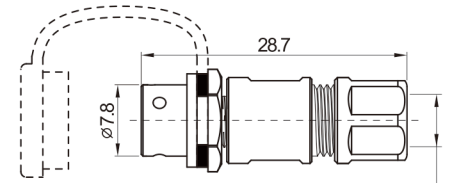

Cable outer diameter range: 3.5-4mm

**SA611 / P** — **SA611 / S** —



Rear-nut mount  
Mate with SA610

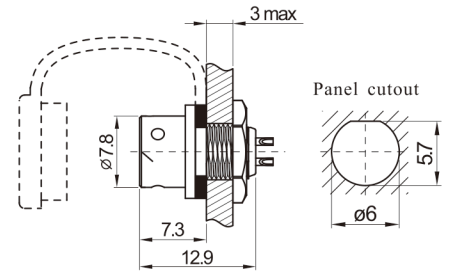
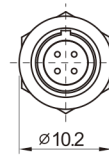

**SA612 / P** — **SA612 / S** —



Front-nut mount  
Mate with SA610

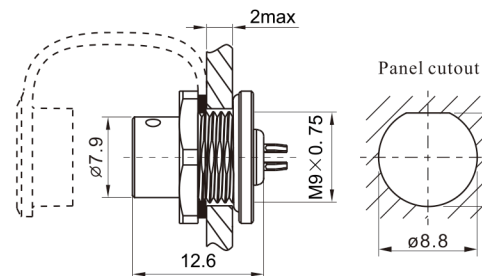
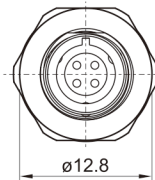

**SA615 / P** — **SA615 / S** —

**Solder contact spec**

Number of contact	2	3	4	5
Male contact face view				
Rated current (A)	3	3	3	3
Contact diameter(mm)	∅0.6×2	∅0.6×3	∅0.6×4	∅0.6×5
Rated voltage (AC.V)	30	30	30	30
Test voltage(AC.V) 1 min	500	500	500	500
Contact resistance(mΩ)	10	10	10	10
Wire size (mm <sup>2</sup> /AWG)	≤0.5/20	≤0.5/20	≤0.5/20	≤0.5/20

## SA8 Series



Cable connector  
Mate with SA811, SA812,  
SA815

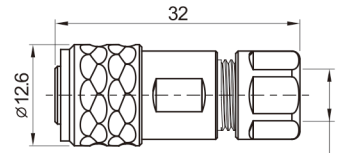
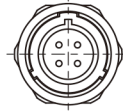

Cable outer diameter range: 4-5mm

SA810 / P

SA810 / S

Male contact

Colour:  
B: Black  
S: Silver  
L: Blue (special order)  
G: Green (special order)  
R: Red (special order)

Number of contact

Female contact



In-line cable connector  
Mate with SA810

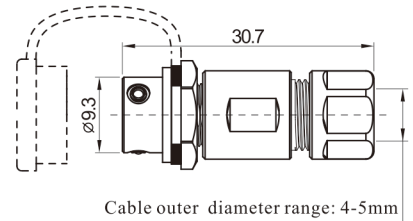
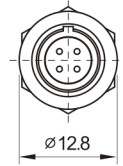

Cable outer diameter range: 4-5mm

SA811 / P

SA811 / S



Rear-nut mount  
Mate with SA810

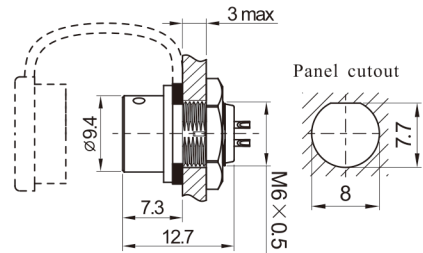
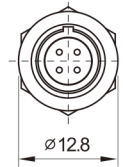

SA812 / P

SA812 / S



Front-nut mount  
Mate with SA810

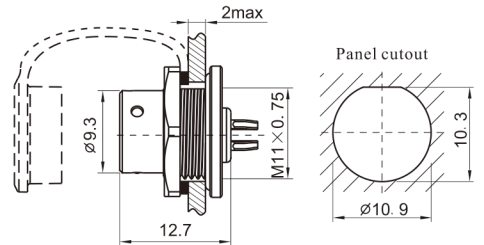
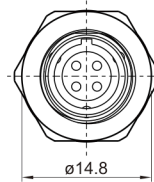

SA815 / P

SA815 / S

## Solder contact spec

Number of contact	2	3	4	6	8
Male contact face view					
Rated current (A)	5	5	3	3	3
Contact diameter(mm)	∅1×2	∅1×3	∅0.6×4	∅0.6×6	∅0.6×8
Rated voltage (AC.V)	125	125	30	30	30
Test voltage(AC.V) 1 min	1000	1000	500	500	500
Contact resistance(mΩ)	5	5	10	10	10
Wire size(mm <sup>2</sup> /AWG)	≤0.75/18	≤0.75/18	≤0.5/20	≤0.5/20	≤0.5/20

**SA10 Series**



Cable connector  
Mate with SA1011, SA1012,  
SA1015

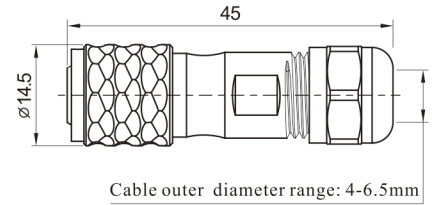
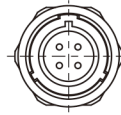

SA1010 / P\_\_

SA1010 / S\_\_

Male contact

- Colour:
- B: Black
- S: Silver
- L: Blue (special order)
- G: Green (special order)
- R: Red (special order)
- Number of contact
- Female contact



In-line cable connector  
Mate with SA1010

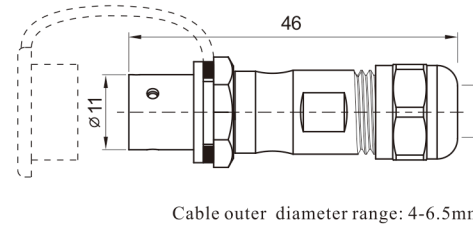
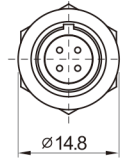

SA1011 / P\_\_

SA1011 / S\_\_



Rear-nut mount  
Mate with SA1010

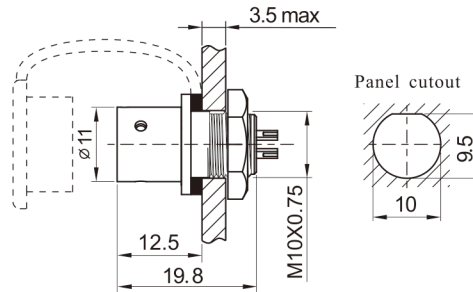

SA1012 / P\_\_

SA1012 / S\_\_



Front-nut mount  
Mate with SA1010

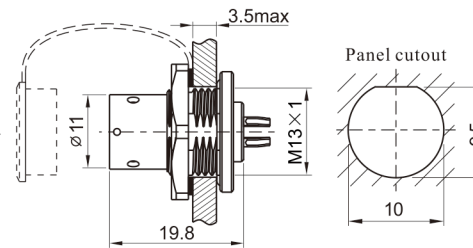

SA1015 / P\_\_

SA1015 / S\_\_

**Solder contact spec**

Number of contact	2	3	4	5
Male contact face view				
Rated current (A)	5	5	3	3
Contact diameter(mm)	Ø1×2	Ø1×3	Ø0.7×4	Ø0.7×5
Rated voltage (AC.V)	180	180	125	125
Test voltage(AC.V) 1 min	1000	1000	1000	1000
Contact resistance(mΩ)	5	5	10	10
Wire size(mm <sup>2</sup> /AWG)	≤0.75/18	≤0.75/18	≤0.5/20	≤0.5/20



Cable connector  
Mate with SA1211, SA1212, SA1213, SA1215

SA1210/P — SA1210/S

Male contact  
Number of contact  
Female contact

Colour:  
B: Black  
S: Silver  
L: Blue (special order)  
G: Green (special order)  
R: Red (special order)  
Cable outer diameter  
I : 4-6.5mm, II : 5-8mm

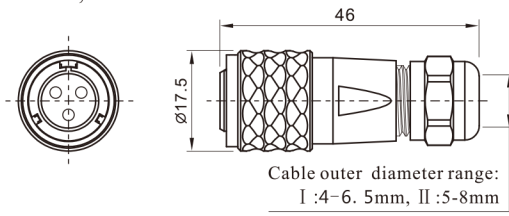

In-line cable connector  
Mate with SA1210

SA1211/P — SA1211/S

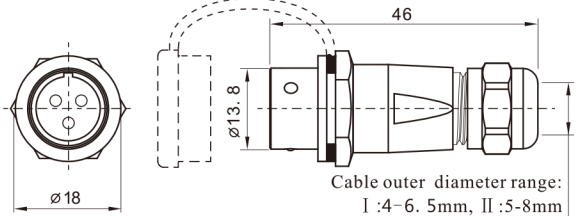

Rear-nut mount  
Mate with SA1210

SA1212/P — SA1212/S

Number of contact

Colour:  
B: Black  
S: Silver  
L: Blue (special order)  
G: Green (special order)  
R: Red (special order)

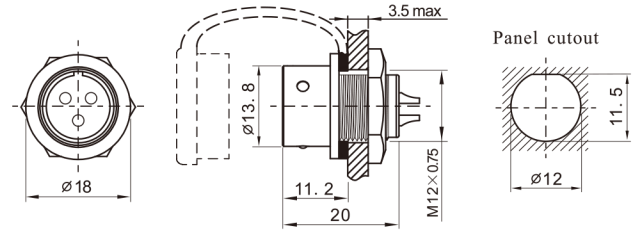

Square flange  
Mate with SA1210

SA1213/P — SA1213/S

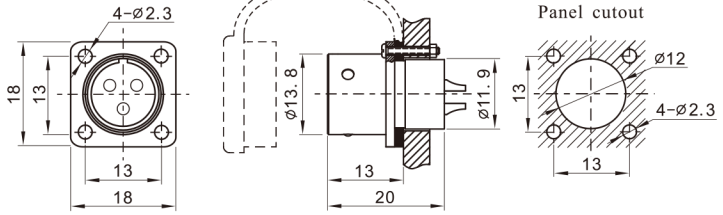

Front-nut mount  
Mate with SA1210

SA1215/P — SA1215/S

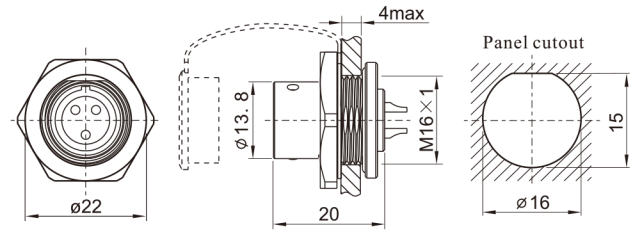

**Solder contact spec**

Number of contact	2	3	4	5	6	7	9
Male contact face view							
Rated current (A)	13	13	5	5	5	5	3
Contact diameter	Ø1.6X2	Ø1.6X3	Ø1X4	Ø1X5	Ø1X6	Ø1X7	Ø0.7X9
Rated voltage (AC.V)	250	250	200	180	125	125	125
Test voltage(AC.V) 1 min	1500	1500	1500	1000	1000	1000	1000
Contact resistance (mΩ)	2.5	2.5	5	5	5	5	10
Wire size (mm <sup>2</sup> /AWG)	≤2/14	≤2/14	≤0.75/18	≤0.75/18	≤0.75/18	≤0.75/18	≤0.5/20



Cable connector  
Mate with SA1611, SA1612, SA1613, SA1615

SA1610/P --- SA1610/S

Male contact

Female contact

Number of contact

Cable outer diameter  
I: 5-8mm, II: 8-12mm

1: solder, 3: crimp

Colour:  
B: Black  
S: Silver  
L: Blue (special order)  
G: Green (special order)  
R: Red (special order)

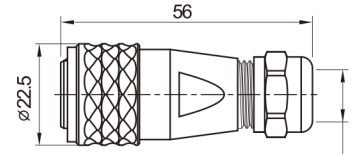
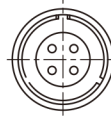

Cable outer diameter range:  
I: 5-8mm, II: 8-12mm



In-line cable connector  
Mate with SA1610

SA1611/P --- SA1611/S

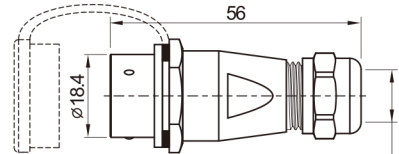

Cable outer diameter range:  
I: 5-8mm, II: 8-12mm



Rear-nut mount  
Mate with SA1610

SA1612/P --- SA1612/S

Number of contact

1: solder, 3: crimp

Colour

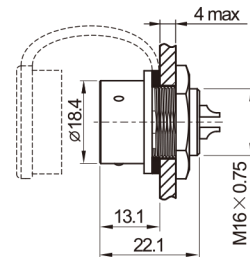

Panel cutout

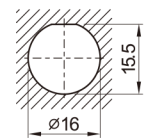

Square flange  
Mate with SA1610

SA1613/P --- SA1613/S

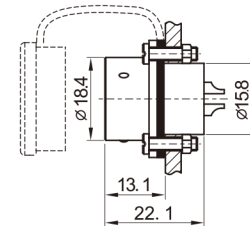
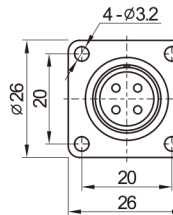

Panel cutout

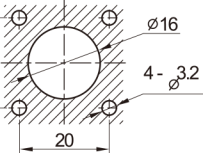

Front-nut mount  
Mate with SA1610

SA1615/P --- SA1615/S

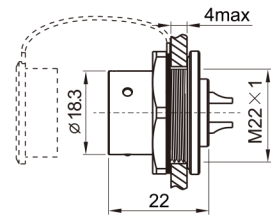
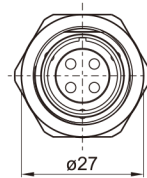

Panel cutout

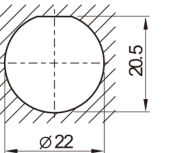

**Solder contact spec**

★ Crimp contact spec see P107-P110

Number of contact	2	3	4	2B	3B	4B	5	7	9	10
Male contact face view										
Rated current (A)	10	10	5	15	15	15	5	5	5	5
Contact diameter(mm)	ø1.5X2	ø1.5X3	ø1X4	ø2X2	ø2X3	ø2X4	ø1X5	ø1X7	ø1X9	ø1X10
Rated voltage (AC.V)	500	500	500	500	500	500	500	400	400	400
Test voltage(AC.V) 1 min	1500	1500	1500	1500	1500	1500	1500	1200	1200	1200
Contact resistance (mΩ)	2.5	2.5	5	2.5	2.5	2.5	5	5	5	5
Wire size (mm <sup>2</sup> /AWG)	≤2/14	≤2/14	≤0.75/18	≤2/14	≤2/14	≤2/14	≤0.75/18	≤0.75/18	≤0.75/18	≤0.75/18

# SA20 Series

**SA  
20**



Cable connector  
Mate with SA2011, SA2012, SA2013, SA2015

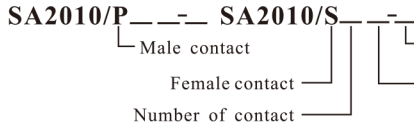

1: solder, 2: screw, 3: crimp  
Colour:  
B: Black  
S: Silver  
L: Blue (special order)  
G: Green (special order)  
R: Red (special order)

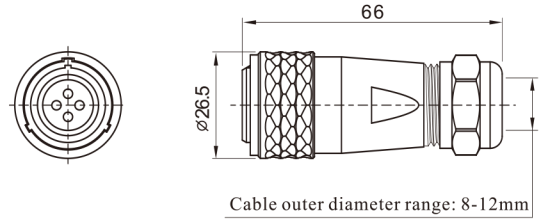

In-line cable connector  
Mate with SF2010

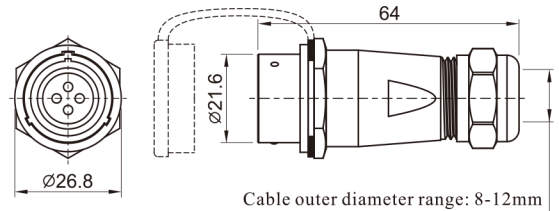

Rear-nut mount  
Mate with SA2010

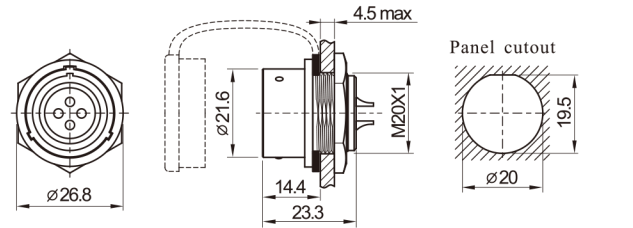

Square flange  
Mate with SA2010

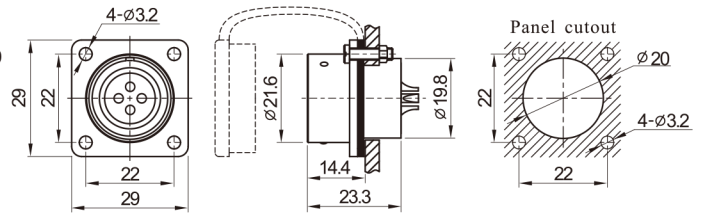

Front-nut mount  
Mate with SA2010

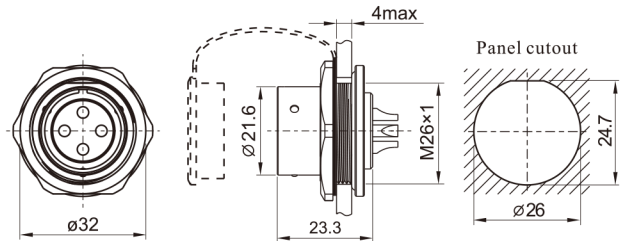

## Solder contact spec

★ Crimp contact spec see P107-P110 ★ Screw contact spec see P111-P112

Number of contact	2	3	4	5	6	6B	7	8	9	12	15
Male contact face view											
Rated current (A)	25	25	25	10	25 5	30 5	10	10	5	5	5
Contact diameter(mm)	∅2.5X2	∅2.5X3	∅2.5X4	∅1.5X5	∅2.5X4 ∅1X2	∅3X2 ∅1X4	∅1.5X7	∅1.5X8	∅1X9	∅1X12	∅1X15
Rated voltage (AC.V)	500	500	500	500	500	500	500	500	400	400	400
Test voltage(AC.V) 1 min	1500	1500	1500	1500	1500	1500	1500	1500	1200	1200	1200
Contact resistance (mΩ)	1	1	1	2.5	1 5	1 5	2.5	2.5	5	5	5
Termination	solder / screw	solder / screw	solder / screw	solder	solder	solder	solder	solder	solder	solder	solder
Wire size for solder (mm <sup>2</sup> / AWG)	≤4/11	≤4/11	≤4/11	≤2/14	≤4/11 ≤0.75/18	≤4/11 ≤0.75/18	≤2/14	≤2/14	≤0.75/18	≤0.75/18	≤0.75/18
Wire size for screw termination (mm <sup>2</sup> / AWG)	≤1.5/15	≤1.5/15	≤1.5/15	/	/	/	/	/	/	/	/



# SA28 Series

**SA  
28**



**Cable connector**  
Mate with SA2811, SA2812,  
SA2813, SA2815

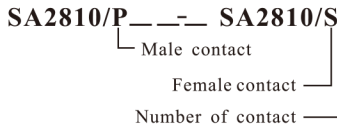

1: solder, 2: screw, 3: crimp  
Colour:  
B: Black  
S: Silver  
L: Blue (special order)  
G: Green (special order)  
R: Red (special order)

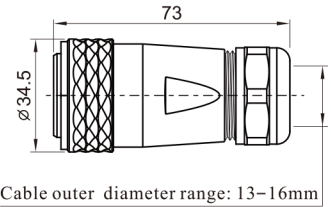
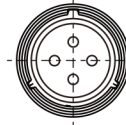

**In-line cable connector**  
Mate with SA2810

SA2811/P --- SA2811/S ---

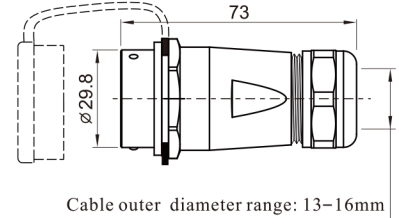
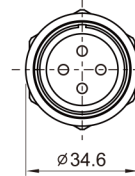

**Rear-nut mount**  
Mate with SA2810

SA2812/P --- SA2812/S ---

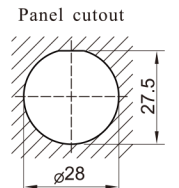
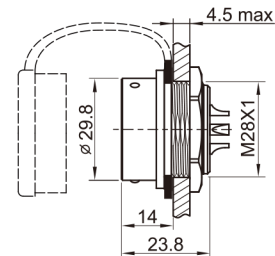
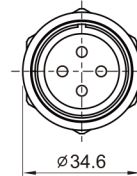

**Square flange**  
Mate with SA2810

SA2813/P --- SA2813/S ---

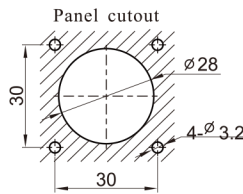
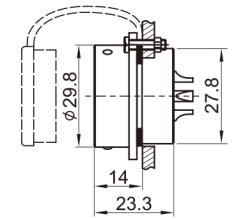
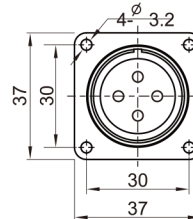

**Front-nut mount**  
Mate with SA2810

SA2815/P --- SA2815/S ---

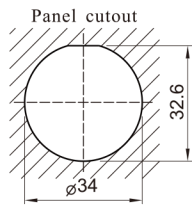
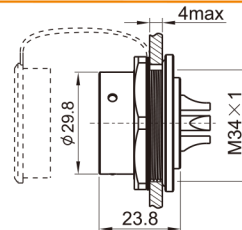
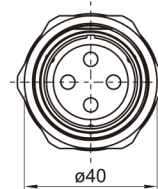

## Solder contact spec

★ Crimp contact spec see P107-P110    ★ Screw contact spec see P111-P112

Number of contact	2	3	4	7	8	8B	9	10	10B	12	16	17	20	24	26	35
Male contact face view																
Rated current (A)	50	50	25	25	25	60, 5	25, 5	25	10	10	10	10	5	5	5	5
Contact diameter(mm)	φ3.5X2	φ3.5X3	φ2.5X4	φ2.5X7	φ2.5X8	φ5X2 φ1X6	φ2.5X4 φ1X5	φ2.5X10	φ1.5X10	φ1.5X12	φ1.5X16	φ1.5X17	φ1X20	φ1X24	φ1X26	φ1X35
Rated voltage (AC.V)	500	500	500	500	500	500 400	500	500	500	500	500	500	400	400	400	400
Test voltage(AC.V) 1 min	1500	1500	1500	1500	1500	1500	1500	1500	1500	1500	1500	1500	1200	1200	1200	1200
Contact resistance(mΩ)	0.5	0.5	1	1	1	5, 0.5	1, 5	1	2.5	2.5	2.5	2.5	5	5	5	5
Termination	solder / screw	solder / screw	solder / screw	solder / screw	solder / screw	solder	solder	solder / screw	solder	solder	solder	solder	solder	solder	solder	solder
Wire size (mm <sup>2</sup> /AWG)	≤10/7	≤10/7	≤4/11	≤4/11	≤4/11	≤16/5 ≤0.75/18	≤4/11 ≤0.75/18	≤4/11	≤2/14	≤2/14	≤2/14	≤2/14	≤2/14	≤0.75/18	≤0.75/18	≤0.75/18
Wire size for screw termination	≤6/10	≤6/10	≤1.5/15	≤1.5/15	≤1.5/15	/	/	≤1.5/15	/	/	/	/	/	/	/	/



**IP67**

**SA Series**





**B.C.E. s.r.l.**  
Via Regina Pacis, 54/c - 41049 SASSUOLO (MO) Italy  
Tel. +39 0536 811.616 r.a. - Fax +39 0536 811.500  
www.bce.it - E-mail: bce@bce.it

