

PROPRIETARY AND CONFIDENTIAL  
 THE INFORMATION CONTAINED IN THIS DRAWING IS THE SOLE PROPERTY OF HTP ASIA TECHNOLOGY CO., LTD. .  
 ANY REPRODUCTION IN PART OR AS A WHOLE WITHOUT THE WRITTEN PERMISSION OF HTP ASIA TECHNOLOGY CO., LTD. IS PROHIBITED.

**RoHS**  
**IP66-68**

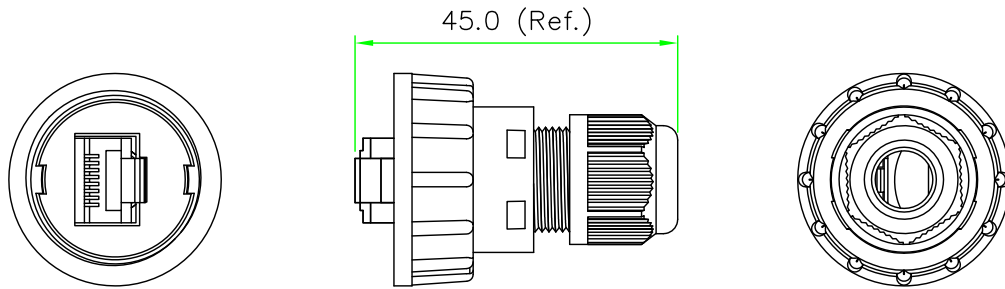

REV.	DESCRIPTION	DATE
A	ISSUE	Jun/06/2014
A1	Add Electrical Characteristics	Dec/08/2015

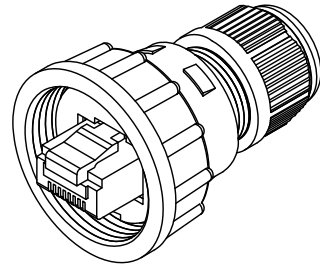

NOTES:

1. Current Rating: 1A
2. Voltage Rating: 150 VAC Max.
3. Connector Temperature Range: -25°C to 85°C
4. Contact Resistance: ≤30mΩ
5. Insulation Resistance: ≥100MΩ
6. Dielectric Withstanding Voltage:  
 1KVrms at 60Hz, 1 minute between adjacent contacts.  
 1.5KVrms at 60Hz, 1 minute between shield and contacts.
7. Panel Thickness Max. 4.0

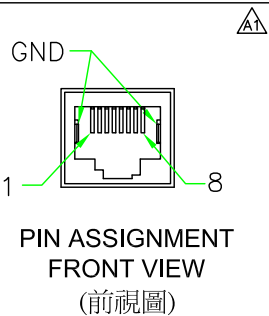

原型號為:RJ45D-P108SAS  
(OLD NO.)

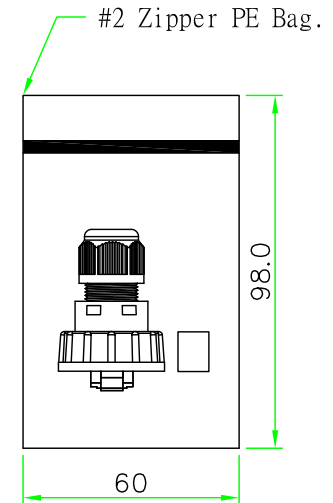

No.	PART NAME	DESCRIPTION	COLOR	Q'TY	REMARKS
6	CLAMP NUT	Pressing Screw, NYLON+GF.	BLACK	1	
5	TUBE	Rubber ( OD= 5.0 & 8.0mm)	BLACK	2	
4	SCREW NUT	Screw Nut, NYLON+GF.	BLACK	1	
3	SLEEVE	Cable Sleeve, NYLON.	BLACK	1	
2	GASKET	RUBBER	BLACK	1	
1	RJ-45 PLUG	RJ-45 8P8C Shielded Plug.		1	

**HOLIN®** HTP ASIA TECHNOLOGY CO., LTD.  
 禾凌科技股份有限公司

UNIT: mm	TITLE :	RJ45 Plug D Size Screw Type Field Installable Plug
SCALE	1:1	
UNLESS OTHERWISE SPECIFIED TOLERANCES: x ±0.5 xx ±0.25 xxx ±0.1 ANGLE ± 1' REV.	P/N:	RJ45D-P4SAS
SHEET	DWG.NO:	RJ45D-P4SAS
A1	1/1	

DR. Patty  
 CH. ERIC  
 AP.