

RECOMMEND  
PANEL CUT OUT

RoHS

IP66-68

HDMI  
HIGH-DEFINITION MULTIMEDIA INTERFACE

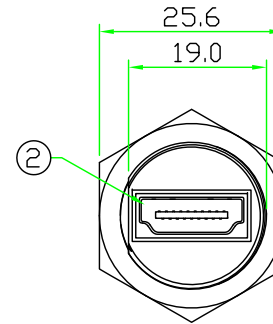
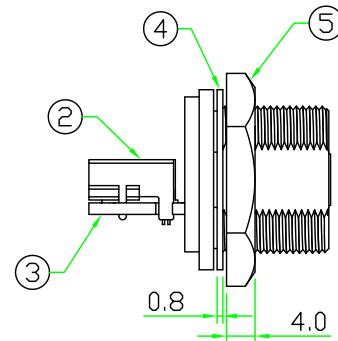
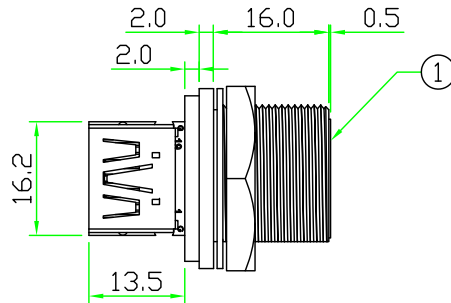
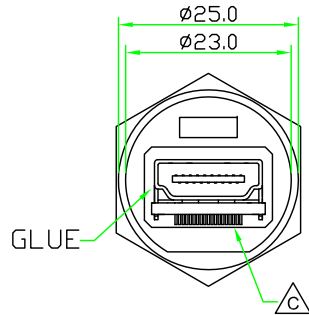

FRONT VIEW  
(前視圖)

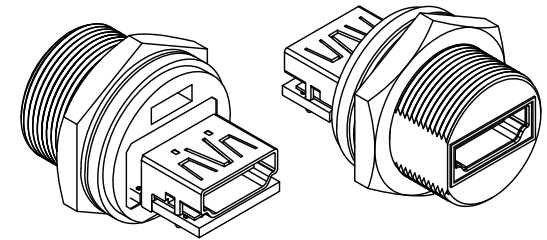

NOTES:

- ELECTRICAL CHARACTERISTICS:  
CURRENT RATING: 0.5A  
CONNECTOR TEMPERATURE RANGE: -25°C TO +85°C  
DIELECTRIC WITHSTANDING VOLTAGE:  
500V AC FOR ONE MINUTE
- PANEL THICKNESS MAX. 6.0mm

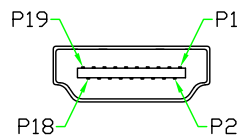

PIN ASSIGNMENT  
FRONT VIEW  
(前視圖)

OLD P/N:HDMIAC-P3CRJ  
(原型號)

5	HEX NUT	Nylon+GF.	BLACK	1	
4	GASKET	EPDM.	BLACK	1	
3	PCB	FR4 . Double Side, 1.6mm Thickness.		1	
2	CONNECTOR	HDMI A Type Female S/T PCB Connector.		2	
1	BODY	HDMI A Type Female Connector Body. Nylon+GF.	BLACK	1	
No.	PART NAME	DESCRIPTION	COLOR	Q'TY	REMARKS

<b>HOLIN®</b> HTP ASIA TECHNOLOGY CO., LTD. 禾凌科技股份有限公司		TITLE : HDMI A Type Female C Size Screw Type Circular Flange Panel With HDMI A Type Female	
UNIT: mm	SCALE 1:1	P/N: HDMIAC-P3CSJ	DR. Patty
UNLESS OTHERWISE SPECIFIED TOLERANCES: x ± 0.5 xx ± 0.25 xxx ± 0.1 ANGLE ± 1'		△ B	CH. ERIC
REV. C1	SHEET 1/1	DWG.NO: △ B HDMIAC-P3CSJ	AP.