

PROPRIETARY AND CONFIDENTIAL
 THE INFORMATION CONTAINED IN THIS DRAWING IS THE SOLE PROPERTY OF HTP ASIA TECHNOLOGY CO., LTD. .
 ANY REPRODUCTION IN PART OR AS A WHOLE WITHOUT THE WRITTEN PERMISSION OF HTP ASIA TECHNOLOGY CO., LTD. IS PROHIBITED.

RoHS

REV.	DESCRIPTION	DATE
A	ISSUE	Aug/14/2014

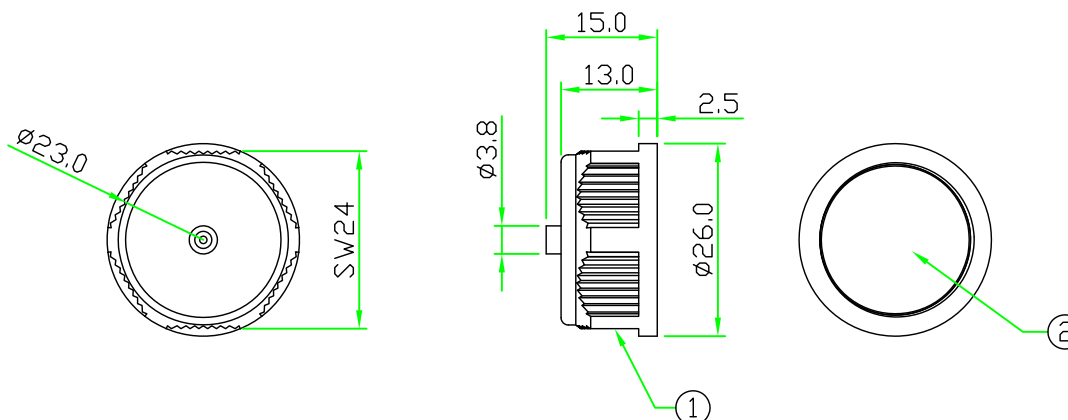
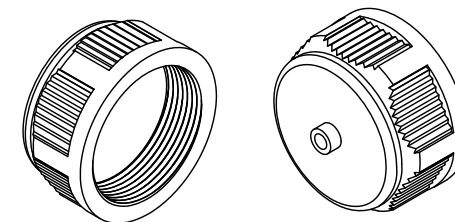
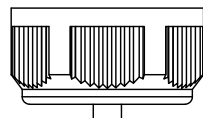

NOTE:
 Maximum panel thickness:(mm)
 (適用面板最大厚度)

Connector Type	With Waterproof Cap
C SIZE-SCREW	1.9
C SIZE-LOCK	1.9
HDMI-SCREW	3.9
RJ45-SCREW	4.0
RJ45-LOCK	4.0
USB-SCREW	3.9
USB-LOCK	4.0

OLD P/N:CCRJUSBP-WCAP-MA
 (原型号)

No.	PART NAME	DESCRIPTION	COLOR	Q'TY	REMARKS
2	GASKET	RUBBER.	BLACK	1	
1	SCREW CAP	NYLON+GF.	BLACK	1	

HOLIN[®] HTP ASIA TECHNOLOGY CO., LTD.
 禾凌科技股份有限公司

	UNIT: mm	TITLE : WATERPROOF CAP SCREW TYPE FOR RJ45 ,C SIZE ,USB PANEL CONNECTOR
SCALE	1:1	
UNLESS OTHERWISE SPECIFIED TOLERANCES: .X ± 0.25 .XX ± 0.1 .XXX ± 0.05 ANGLE ± 1°		P/N: CCX-WCAP-MA
REV. A	SHEET 1/1	DWG.NO: CCX-WCAP-MA
		DR. Patty CH. ERIC AP.