

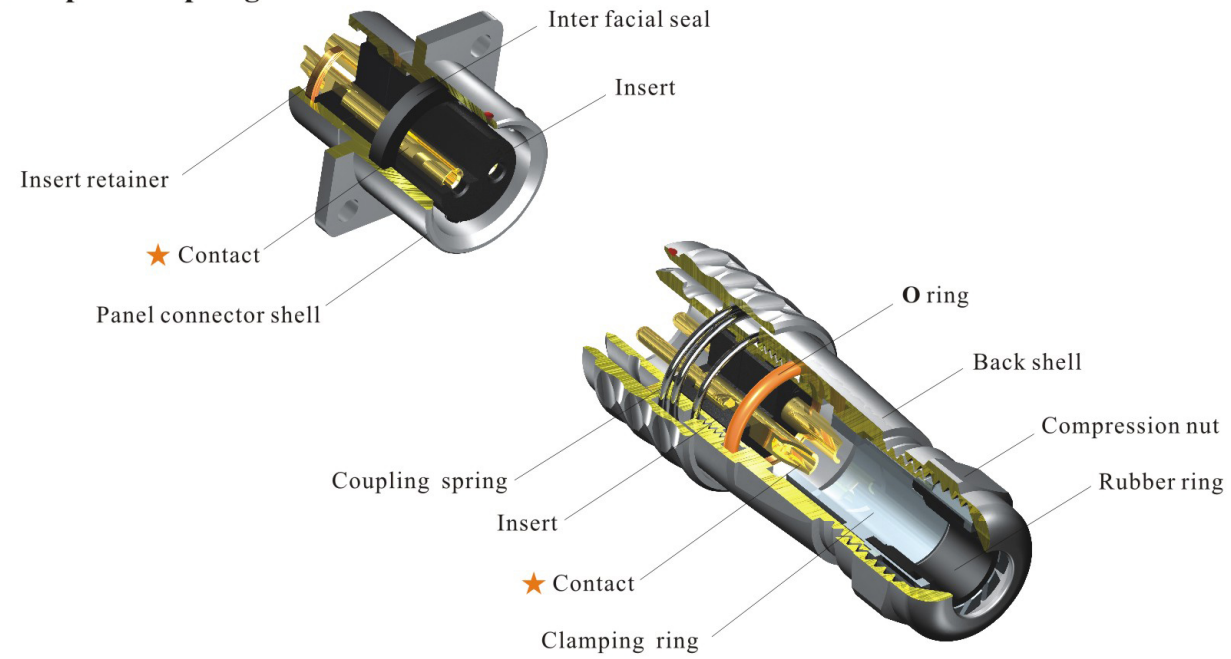



- SF Series IP67
- Push-pull coupling



★ Each side can be male or female contact

**Material and spec**

Coupling	Push-pull
Shell material	Brass with chrome plating
Insert material	PPS, max temperature 260 °C
Contact material	Brass with gold plating
Termination	Solder: SF6, SF8, SF10, SF12, SF16, SF20 Crimp: SF16, SF20 Screw: SF20 (∅2.5mm contact)
IP rating	IP67
Mating cycle	500
Temperature range	-40°C~+85°C
Insulation resistance (MΩ)	2000

**SF6 Series**



SF610/P\_\_\_ SF610/S\_\_\_

**Cable connector**  
Mate with SF611, SF612

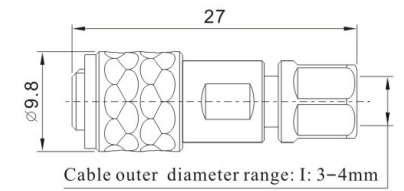
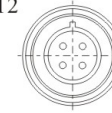

Cable outer diameter: I: 3-4mm  
Number of contact



SF611/P\_\_\_ SF611/S\_\_\_

**In-line cable connector**  
Mate with SF610

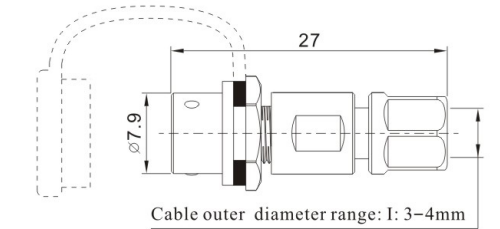

SF612/P\_\_\_ SF612/S\_\_\_

**Rear-nut mount**  
Mate with SF610

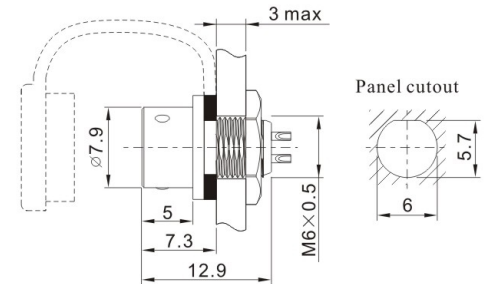

Number of contact

**Solder contact spec**

Number of contact	2	3	4	5
Male contact face view				
Rated current (A)	3	3	3	3
Contact diameter (mm)	0.6	0.6	0.6	0.6
Rated voltage (AC.V)	30	30	30	30
Test voltage(AC.V) 1 min	500	500	500	500
Contact resistance (mΩ)	10	10	10	10
Wire size (mm <sup>2</sup> / AWG)	≤0.785/18	≤0.785/18	≤0.785/18	≤0.785/18

# SF8

## SF8 Series



**Cable connector**  
Mate with SF811, SF812

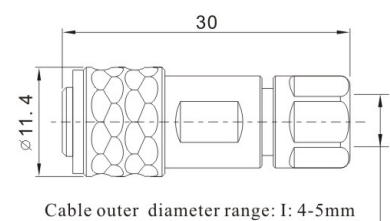
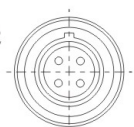

Cable outer diameter range: I: 4-5mm

SF810/P

SF810/S

Cable outer diameter: I: 4-5mm  
Number of contact



**In-line cable connector**  
Mate with SF810

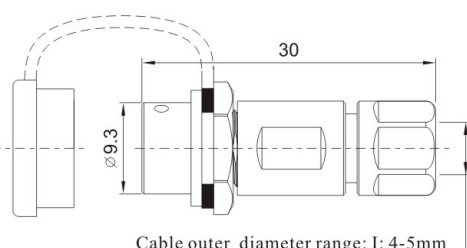
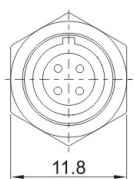

Cable outer diameter range: I: 4-5mm

SF811/P

SF811/S



**Rear-nut mount**  
Mate with SF810

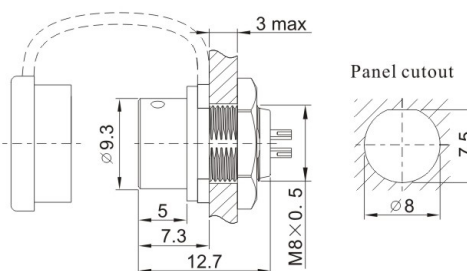

Panel cutout

SF812/P

SF812/S

Number of contact

### Solder contact spec

Number of contact	2	3	4	6	8
Male contact face view					
Rated current (A)	5	5	3	3	3
Contact diameter (mm)	1	1	0.6	0.6	0.6
Rated voltage (AC.V)	125	125	30	30	30
Test voltage(AC.V) 1 min	1000	1000	500	500	500
Contact resistance (mΩ)	5	5	10	10	10
Wire size (mm <sup>2</sup> / AWG)	≤0.785/18	≤0.785/18	≤0.785/18	≤0.785/18	≤0.785/18

# SF10

## SF10 Series



**Cable connector**  
Mate with SF1011, SF1012

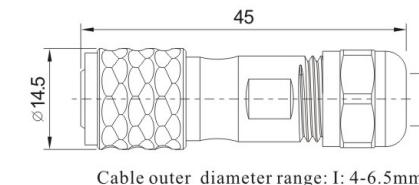
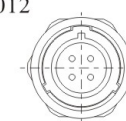

Cable outer diameter range: I: 4-6.5mm

SF1010/P

SF1010/S

Cable outer diameter: I: 4-6.5mm  
Number of contact



**In-line cable connector**  
Mate with SF1010

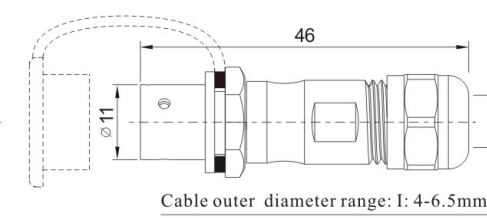
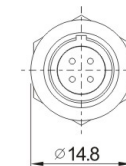

Cable outer diameter range: I: 4-6.5mm

SF1011/P

SF1011/S



**Rear-nut mount**  
Mate with SF1010

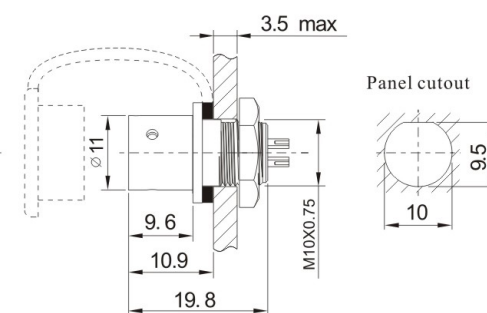
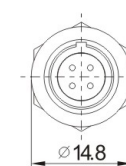

Panel cutout

SF1012/P

SF1012/S

Number of contact

### Solder contact spec

Number of contact	2	3	4	5
Male contact face view				
Rated current (A)	5	5	3	3
Contact diameter (mm)	1	1	0.7	0.7
Rated voltage (AC.V)	180	180	125	125
Test voltage(AC.V) 1 min	1000	1000	1000	1000
Contact resistance (mΩ)	5	5	10	10
Wire size (mm <sup>2</sup> / AWG)	≤0.785/18	≤0.785/18	≤0.785/18	≤0.785/18

## SF12 Series

SF  
12



SF1210 / P — SF1210 / S

**Cable connector**  
Mate with SF1211, SF1212,  
SF1213

Cable outer diameter  
I: 4-6.5mm, II: 5-8mm  
Number of contact

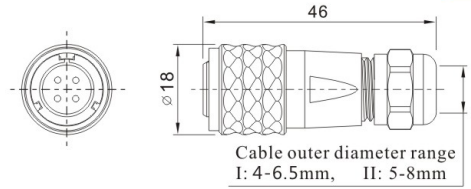

SF1211 / P — SF1211 / S

**In-line cable connector**  
Mate with SF1210

Number of contact

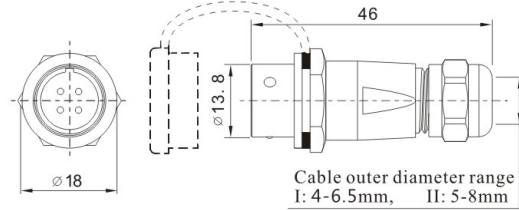

SF1212 / P — SF1212 / S

**Rear-nut mount**  
Mate with SF1210

Number of contact

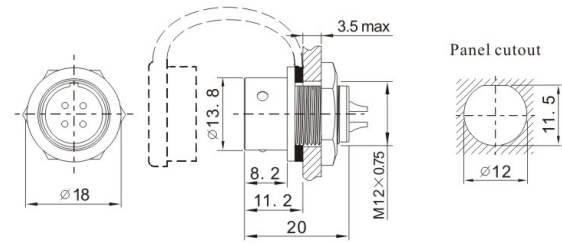

SF1213 / P — SF1213 / S

**Square flange**  
Mate with SF1210

Number of contact

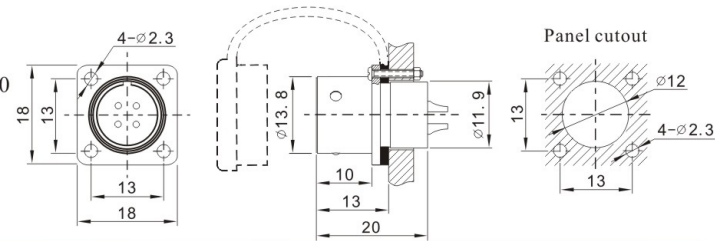

SF1214 / P — II SF1214 / S — II

**Angled cable connector**  
Mate with SF1211, SF1212, SF1213

Number of contact

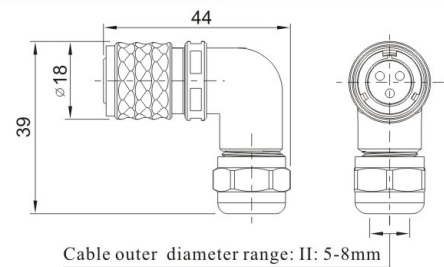

### Solder contact spec

Number of contact	2	3	4	5	6	7	9
Male contact face view							
Rated current (A)	13	13	5	5	5	5	3
Contact diameter (mm)	1.6	1.6	1	1	1	1	0.7
Rated voltage (AC.V)	250	250	200	180	125	125	125
Test voltage(AC.V) 1 min	1500	1500	1500	1000	1000	1000	1000
Contact resistance (mΩ)	2	2	5	5	5	5	10
Wire size (mm <sup>2</sup> / AWG)	≤2/14	≤2/14	≤0.785/18	≤0.785/18	≤0.785/18	≤0.785/18	≤0.785/18

## SF16 Series

SF  
16



SF1610 / P — SF1610 / S

**Cable connector**  
Mate with SF1611, SF1612,  
SF1613

Number of contact  
I: solder, 3: crimp  
Cable outer diameter  
I: 5-8mm, II: 8-12mm

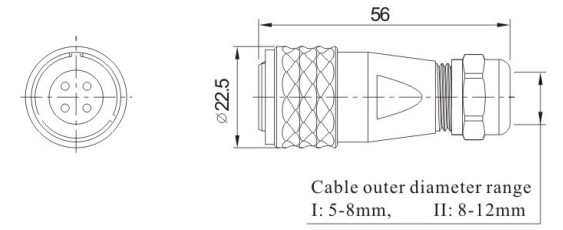

SF1611 / P — SF1611 / S

**In-line cable connector**  
Mate with SF1610

Number of contact

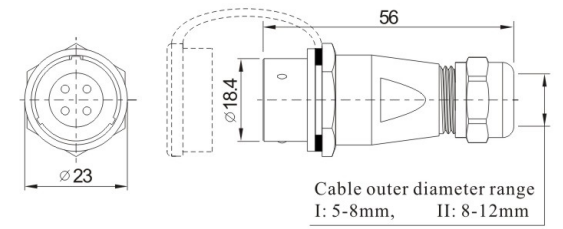

SF1612 / P — SF1612 / S

**Rear-nut mount**  
Mate with SF1610

Number of contact  
I: solder, 3: crimp

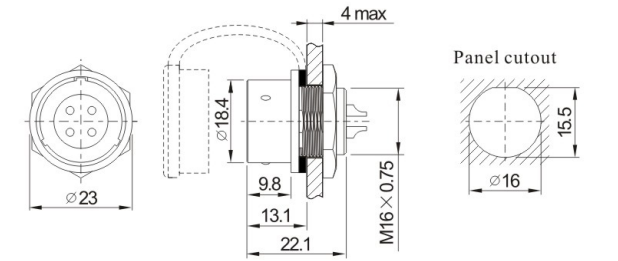

SF1613 / P — SF1613 / S

**Square flange**  
Mate with SF1610

Number of contact

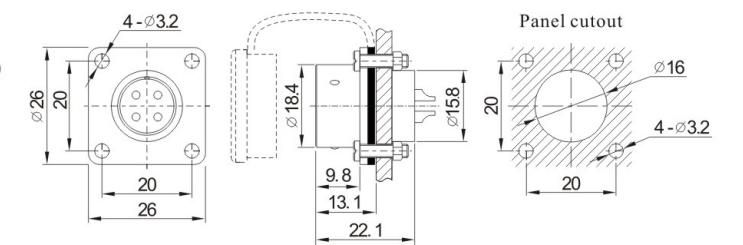

### Solder contact spec

★ Crimp contact spec see page 77-80

Number of contact	2	3	4	5	7	9	10
Male contact face view							
Rated current (A)	10	10	5	5	5	5	5
Contact diameter (mm)	1.5	1.5	1	1	1	1	1
Rated voltage (AC.V)	500	500	500	500	400	400	400
Test voltage(AC.V) 1 min	1500	1500	1500	1500	1200	1200	1200
Contact resistance (mΩ)	2.5	2.5	5	5	5	5	5
Wire size (mm <sup>2</sup> / AWG)	≤2/14	≤2/14	≤0.785/18	≤0.785/18	≤0.785/18	≤0.785/18	≤0.785/18

## SF20 Series

**SF  
20**



**Cable connector**  
Mate with SF2011, SF2012,  
SF2013

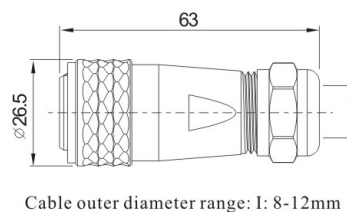
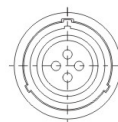

SF2010 / P --- SF2010 / S ---  
Number of contact

1: solder, 2: screw, 3: crimp  
Cable outer diameter range: I: 8-12mm



**In-line cable connector**  
Mate with SF2010

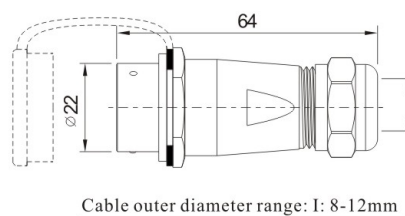

SF2011 / P --- SF2011 / S ---

Cable outer diameter range: I: 8-12mm



**Rear-nut mount**  
Mate with SF2010

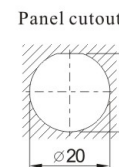
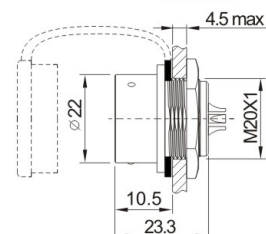
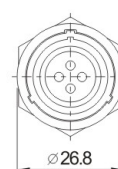

SF2012 / P --- SF2012 / S ---

1: solder, 2: screw, 3: crimp  
Number of contact



**Square flange**  
Mate with SF2010

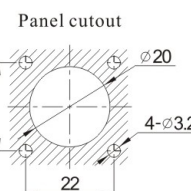
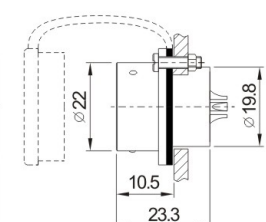
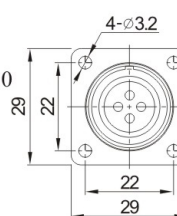

SF2013 / P --- SF2013 / S ---

### Solder contact spec

★ Crimp contact spec see page 77-80

Number of contact	2	3	4	5	6	7	9	12
Male contact face view								
Rated current (A)	25	25	25	10	25 5	10	5	5
Contact diameter (mm)	2.5	2.5	2.5	1.5	2.5X4 1X2	1.5	1	1
Rated voltage (AC.V)	500	500	500	500	500	500	500	400
Test voltage(AC.V) 1 min	1500	1500	1500	1500	1500	1500	1500	1200
Contact resistance (mΩ)	1	1	1	2.5	1 5	2.5	5	5
Termination	solder / screw	solder / screw	solder / screw	solder	solder	solder	solder	solder
Wire size for solder (mm <sup>2</sup> / AWG)	≤4/11	≤4/11	≤4/11	≤2/14	≤4/11 ≤0.785/18	≤2/14	≤0.785/18	≤0.785/18
Wire size for screw termination (mm <sup>2</sup> / AWG)	≤1.5/15	≤1.5/15	≤1.5/15	/	/	/	/	/





**B.C.E. S.r.l.** - Via Regina Pacis, 54/c - I 41049 Sassuolo (MO), Italy

Tel: (+39) 0536 811616 Fax: (+39) 0536 811500 E-mail: [bce@bce.it](mailto:bce@bce.it) Web: [www.bce.it](http://www.bce.it)

