





IP67

M23  
Power



● M23 for power

Material and spec

Shell material	Zinc alloy with nickel plating
Contact material	Brass with gold plating
Insert material	PA66
Insulation resistance	$>10^{13} \text{ m}\Omega$
Termination	Crimp
Temperature range	$-40^{\circ}\text{C} \sim +125^{\circ}\text{C}$
Mating cycle	1000
Cable outer diameter range	I: 4-8mm (Special order) II: 8-13mm (Standard) III: 12-17mm (Special order)
IP rating	IP67
Coupling	Threaded coupling

If more than one M23-for-power connector is used on same device, 6 different colored rubber rings are designed to avoid mismatching and mismating.



**Male contact cable connector**  
M23DJ\_TK

Number of contact —

- Colour
- Gray: GY (Standard)
- Black: BK (Special order), Orange: OG (Special order)
- Blue: BU (Special order), Green: GN (Special order)
- Purple: PL (Special order)
- Cable outer diameter range
- I: 4-8mm (Special order) II: 8-13mm (Standard)
- III: 12-17mm (Special order)
- S: Shield
- U: Unshielded

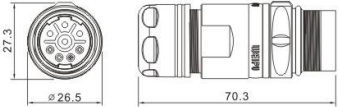

---



**Female contact cable connector**  
M23DK\_TK\_

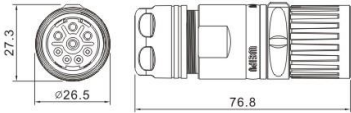



Male contact square flange receptacle

M23DJ\_Z\_

Number of contact

Colour

Gray: GY (Standard)

Black: BK (Special order), Orange: OG (Special order)

Blue: BU (Special order), Green: GN (Special order)

Purple: PL (Special order)

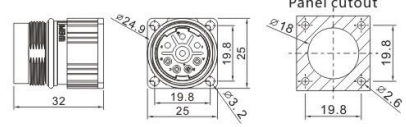

Female contact square flange receptacle

M23DK\_Z\_

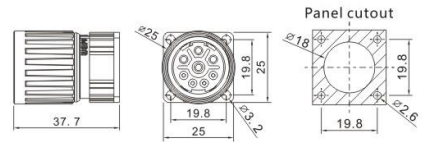

Male contact angled cable connector

M23DJ\_TL\_ \_ \_

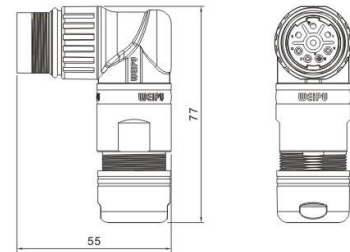

Female contact angled cable connector

M23DK\_TL\_ \_ \_

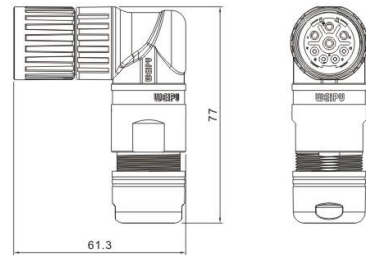

Male contact angled square flange receptacle

M23DJ\_ZL\_

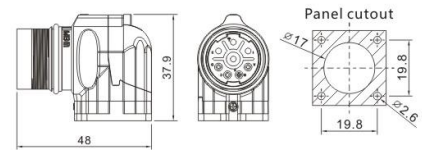

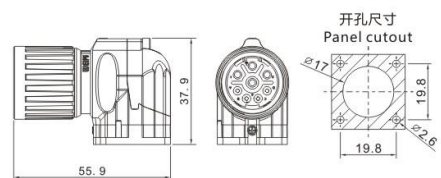

Female contact angled square flange receptacle

M23DK\_ZL\_



M23 for power contact arrangement and spec

Male contact face view	Number of contact	Contact diameter (mm)	Rated voltage (AC.V)	Rated current (A)	Wire size (mm <sup>2</sup> /AWG)	Test voltage (AC.V)1min
	6(5+PE)	∅2	600	28	≤4/11	4000
	8(3+4+PE)	∅1×4 ∅2×4	300	8 28	≤0.5/20 ≤4/11	2500

## M23 contact spec

### 8A Crimp contact

※ Contact diameter:  $\varnothing 1$

※ Material: Brass with gold plating

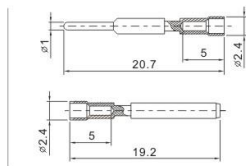

#### 8A Male crimp contact

Wire size	Stripping length	Male crimp contact p/n	Crimping tool p/n
0.25-1.0mm <sup>2</sup> AWG 23-17	4mm	YJ1-20.7-1.0AU	CT-W26/12

#### 8A Female crimp contact

Wire size	Stripping length	Female crimp contact p/n	Crimping tool p/n
0.25-1.0mm <sup>2</sup> AWG 23-17	4mm	YK1-19.4-1.0AU	CT-W26/12

### 28A压接插针 28A Crimp contact

※ 接触直径:  $\varnothing 2$

Contact diameter:  $\varnothing 2$

※ 材料: 铜镀金

Material: Brass with gold plating

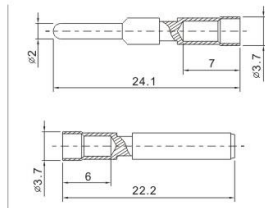

#### 28A Male crimp contact

Wire size	Stripping length	Female crimp contact p/n	Crimping tool p/n
0.75-2.5mm <sup>2</sup> AWG 18-13	7mm	YJ2-24.1-2.5AU	CT-W26/12
2.5-4mm <sup>2</sup> AWG 13-11	7mm	YJ2-24.1-4.0AU	CT-W26/12

#### 28A Female crimp contact

Wire size	Stripping length	Female crimp contact p/n	Crimping tool p/n
0.75-2.5mm <sup>2</sup> AWG 18-13	7mm	YK2-22.2-2.5AU	CT-W26/12
2.5-4mm <sup>2</sup> AWG 13-12	7mm	YK2-22.2-4.0AU	CT-W26/12

### Crimp tool

For crimping the male / female contacts



Part number	Crimping wire range
CT-W26/12	0.13-3.33mm <sup>2</sup>



IP 67

M23  
Signal



● M23 for signal

Material and spec

Shell material	Zinc alloy with nickel plating
Contact material	Brass with gold plating
Insert material	PA66
Insulation resistance	9、12 pins: $>10^{10}\Omega$ 17、19 pins: $>10^6\Omega$
Termination	Crimp
Temperature range	-40℃~+125℃
Mating cycle	1000
Cable outer diameter range	I: 4-8mm (Special order) II: 8-13mm (Standard) III: 12-17mm (Special order)
IP rating	IP67
Coupling	Threaded coupling



**Male contact cable connector**  
M23SJ\_TK

Number of contact

Coded chuck (See P7)  
N: Gray (Standard), S:Black (Special order)  
H: Orange (Special order), X: Blue (Special order)  
Y: Green (Special order), Z: Purple (Special order)

Cable outer diameter range  
I: 4-8mm (Special order) II: 8-13mm (Standard)  
III: 12-17mm (Special order)

S:Shield  
U:Unshielded

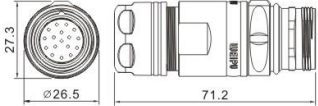

---



**Female contact cable connector**  
M23SK\_TK\_

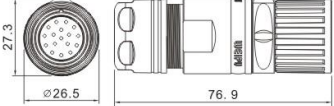



Male contact square flange receptacle

M23SJ\_Z

Number of contact

Coded chuck (See P7)  
 N: Gray (Standard), S: Black (Special order)  
 H: Orange (Special order), X: Blue (Special order)  
 Y: Green (Special order), Z: Purple (Special order)

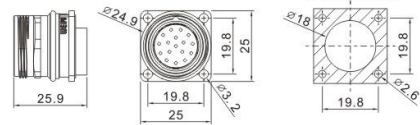

Female contact square flange receptacle

M23SK\_Z

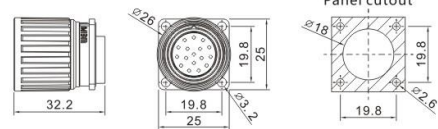

Male contact angled cable connector

M23SJ\_TL

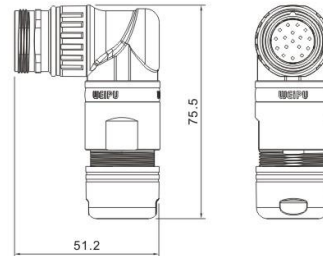

Female contact angled cable connector

M23SK\_TL

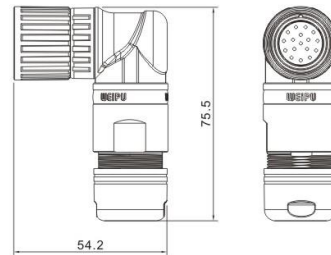

Male contact angled square flange receptacle

M23SJ\_ZL

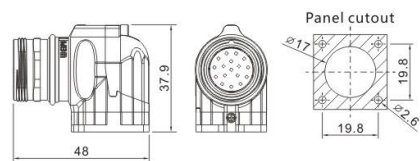

Female contact angled square flange receptacle

M23SK\_ZL

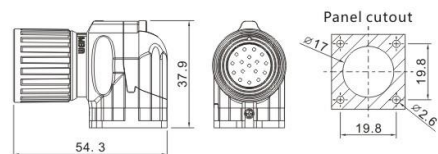

### M23 for signal contact arrangement and spec

Male contact face view	Number of contact	Contact diameter (mm)	Rated voltage (AC.V)	Rated current (A)	Wire size (mm <sup>2</sup> /AWG)	Test voltage (AC.V)1 min
	9(8+1)	∅1×8 ∅2×1	300	8 20	≤0.5/20 ≤4/11	2500
	12	∅1×12	300	8	≤0.5/20	2500
	17	∅1×17	150	8	≤0.5/20	1500
	19(16+3)	∅1×16 ∅1.5×3	150	8 10	≤0.5/20	1500

Number of Contact	Key-ways	Key-way position	
9	N, S, H, X, Y		<p>If more than one M23-for-signal connector is used on same device, in order to avoid mismatching and mismating, 6 different colored rubber rings are designed to associate with 6 different key-way positions on insert.</p> <p>Gray is standard color, other colors are special order.</p>
12	N, S, H, X, Y, Z		
17	N, S, H, X, Y, Z		
19	N, S, H, X, Y		

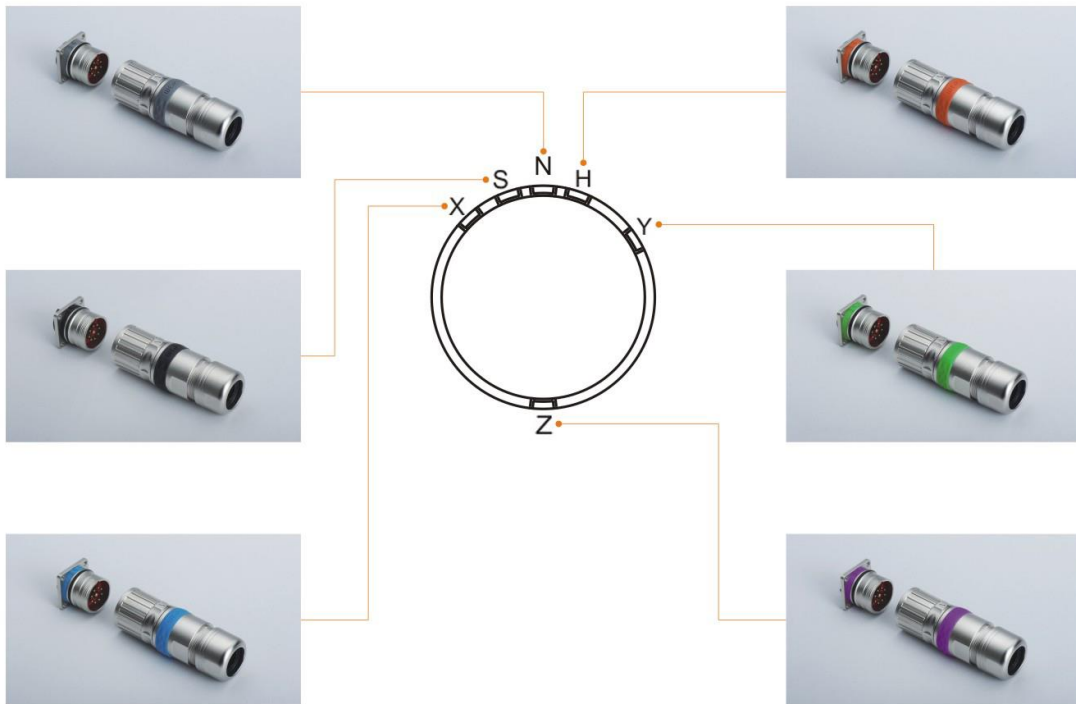



## M23 for signal contact spec

### 8A Crimp contact

- ※ Contact diameter:  $\varnothing 1$
- ※ Material: Brass with gold plating

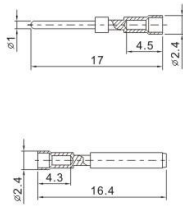

#### 8A Male crimp contact

Wire size	Stripping length	Male crimp contact p/n	Crimping tool p/n
0.08-0.56mm <sup>2</sup> AWG 28-19	4mm	YJ1-17-0.56AU	CT-W32/20
0.14-1mm <sup>2</sup> AWG 26-17	4mm	YJ1-17-1.0AU	CT-W26/12
1-1.5mm <sup>2</sup> AWG 17-16	4mm	YJ1-17-1.5AU	CT-W26/12

#### 8A Female crimp contact

Wire size	Stripping length	Male crimp contact p/n	Crimping tool p/n
0.08-0.56mm <sup>2</sup> AWG 28-19	4mm	YK1-16.4-0.56AU	CT-W32/20
0.14-1mm <sup>2</sup> AWG 26-17	4mm	YK1-16.4-1.0AU	CT-W26/12
1-1.5mm <sup>2</sup> AWG 17-16	4mm	YK1-16.4-1.5AU	CT-W26/12

### 10A Crimp contact

- ※ Contact diameter:  $\varnothing 1.5$
- ※ Material: Brass with gold plating

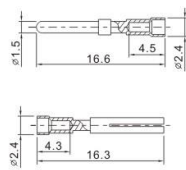

#### 10A Male crimp contact

Wire size	Stripping length	Male crimp contact p/n	Crimping tool p/n
0.14-1mm <sup>2</sup> AWG 26-17	4mm	YJ1.5-16.6-1.0AU	CT-W26/12

#### 10A Female crimp contact

Wire size	Stripping length	Male crimp contact p/n	Crimping tool p/n
0.14-0.56mm <sup>2</sup> AWG 26-19	4mm	YK1.5-16.3-0.56AU	CT-W26/12
0.56-1mm <sup>2</sup> AWG 19-17	4mm	YK1.5-16.3-1.0AU	CT-W26/12

### 20A Crimp contact

- ※ Contact diameter:  $\varnothing 2$
- ※ Material: Brass with gold plating

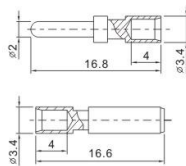

#### 20A Male crimp contact

Wire size	Stripping length	Male crimp contact p/n	Crimping tool p/n
0.75-2.5mm <sup>2</sup> AWG 18-13	4mm	YJ2-16.8-2.5AU	CT-W26/12

#### 20A Female crimp contact

Wire size	Stripping length	Male crimp contact p/n	Crimping tool p/n
0.75-2.5mm <sup>2</sup> AWG 18-13	4mm	YK2-16.6-2.5AU	CT-W26/12

### Crimp tool

For crimping the male / female contacts



Part number	Crimping wire range
CT-W26/12	0.13-3.33mm <sup>2</sup>
CT-W32/20	0.03-0.52mm <sup>2</sup>



**IP67**

**M23 Series**





**B.C.E. s.r.l.**  
Via Regina Pacis, 54/c - 41049 SASSUOLO (MO) Italy  
Tel. +39 0536 811.616 r.a. - Fax +39 0536 811.500  
[www.bce.it](http://www.bce.it) - E-mail: [bce@bce.it](mailto:bce@bce.it)

