

GHz BGA DIRECT MOUNT, SOLDERLESS SOCKET FOR TEST APPLICATIONS

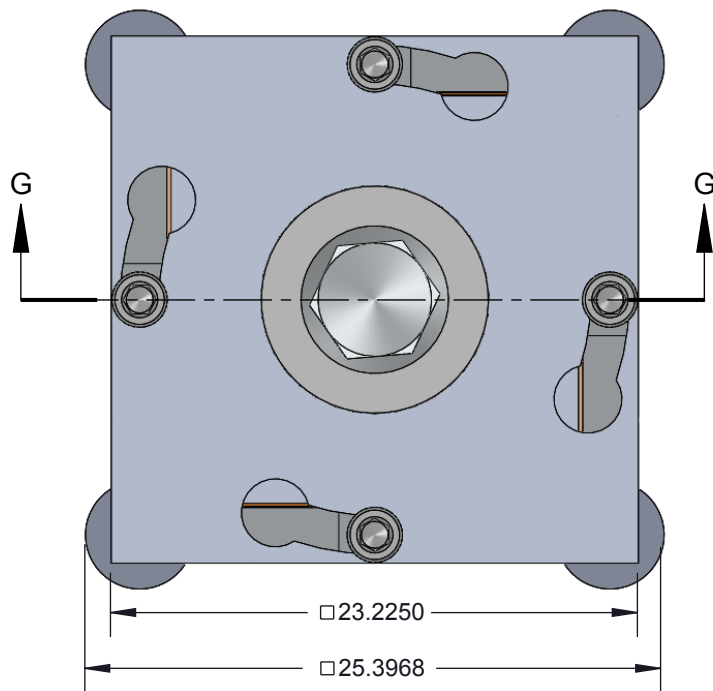

FEATURES:

- Directly mounts to target PCB (needs tooling holes) with hardware.
- High speed, reliable Elastomer connection
- Minimum real estate required
- Compression plate distributes forces evenly
- Easily removable swivel socket lid

Recommended torque = 0.45 in-lbs

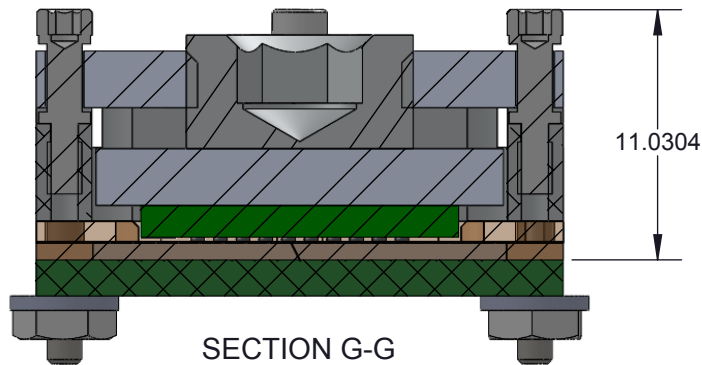
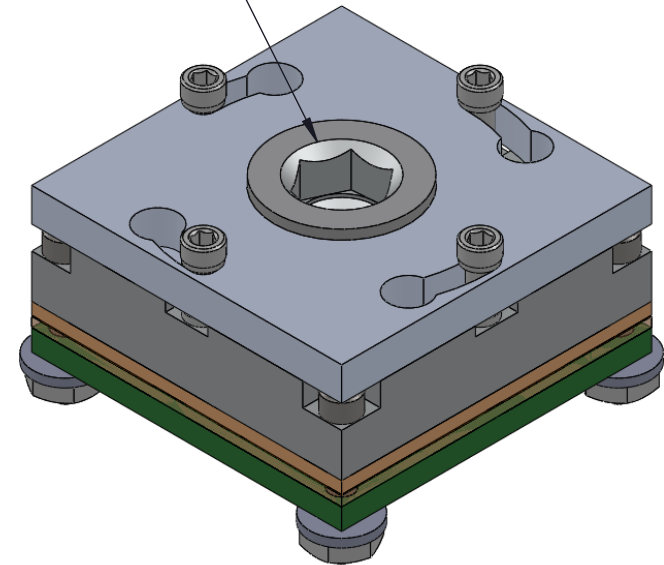

SECTION G-G
SCALE 2 : 1

DESCRIPTION: SG-BGA107 for 14x18mm IC 1.0mm pitch 10x14 array

Primary dimension units are millimeters, Secondary dimension units are [inches].

Tolerances: diameters $\pm 0.03\text{mm}$ [$\pm 0.001\text{"}]$, all other tolerances $\pm 0.13\text{mm}$ [$\pm 0.005\text{"}]$ unless stated otherwise.

Materials and specifications are subject to change without notice.

SG-BGA-6361 Drawing

STATUS: Released

SHEET: 1 of 4

REV. A

DRAWN BY: S. Huang

SCALE: 3:1

File: SG-BGA-6361

DATE: 5/24/2012



Ironwood Electronics, Inc.
Tele: (800) 404-0204
www.ironwoodelectronics.com

WEIGHT: 12.62
MATERIAL: N/A
FINISH: N/A

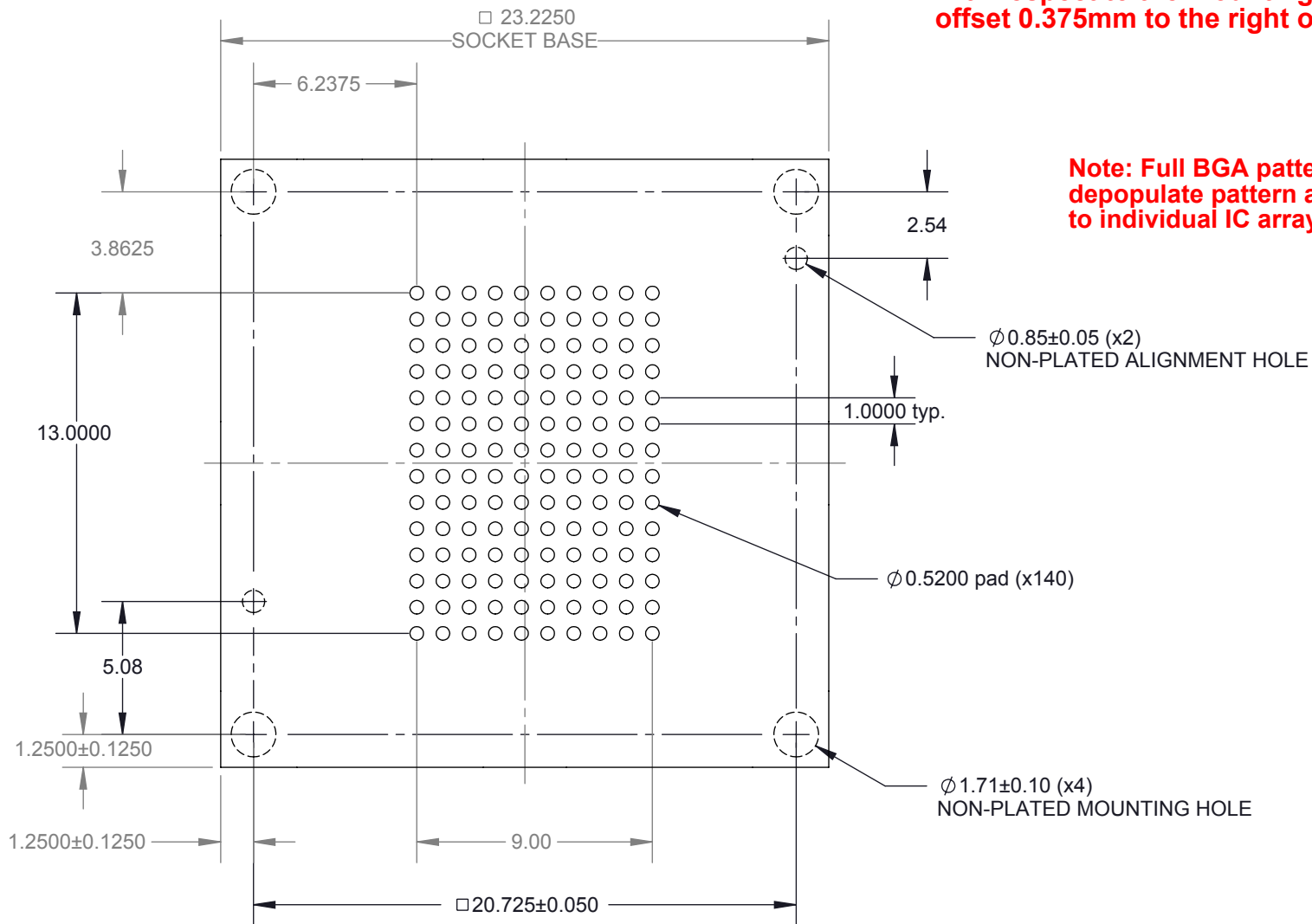

Note: BGA pattern is not symmetrical with respect to the mounting holes. It is offset 0.375mm to the right of center.

Note: Full BGA pattern shown depopulate pattern according to individual IC array.

Ø0.85±0.05 (x2)
NON-PLATED ALIGNMENT HOLE

1.0000 typ.

Ø0.5200 pad (x140)

Ø1.71±0.10 (x4)
NON-PLATED MOUNTING HOLE

Target PCB Recommendations

Total thickness: 1.6mm min.

Plating: Gold or Solder finish

PCB Pad height: same or higher than solder mask

DESCRIPTION: Recommended PCB Layout Top View.

Primary dimension units are millimeters, Secondary dimension units are [inches].

Tolerances: diameters ±0.03mm [±0.001"], all other tolerances ±0.025mm [±0.001"] unless stated otherwise.

Materials and specifications are subject to change without notice.

SG-BGA-6361 Drawing

STATUS: Released

SHEET: 2 of 4

REV. A



Ironwood Electronics, Inc.
Tele: (800) 404-0204
www.ironwoodelectronics.com

WEIGHT: 12.62
MATERIAL: N/A
FINISH: N/A

DRAWN BY: S. Huang

SCALE: 4:1

File: SG-BGA-6361

DATE: 5/24/2012

TOP VIEW

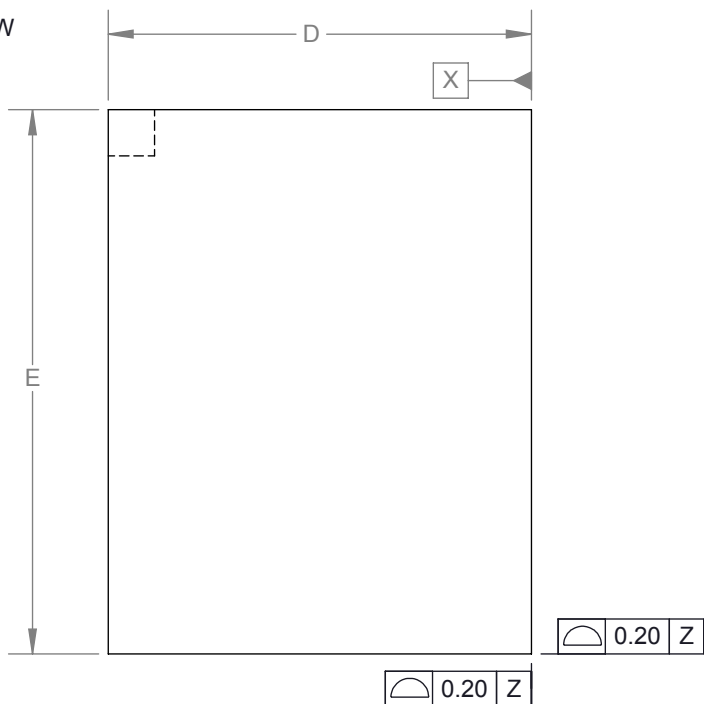

BOTTOM VIEW

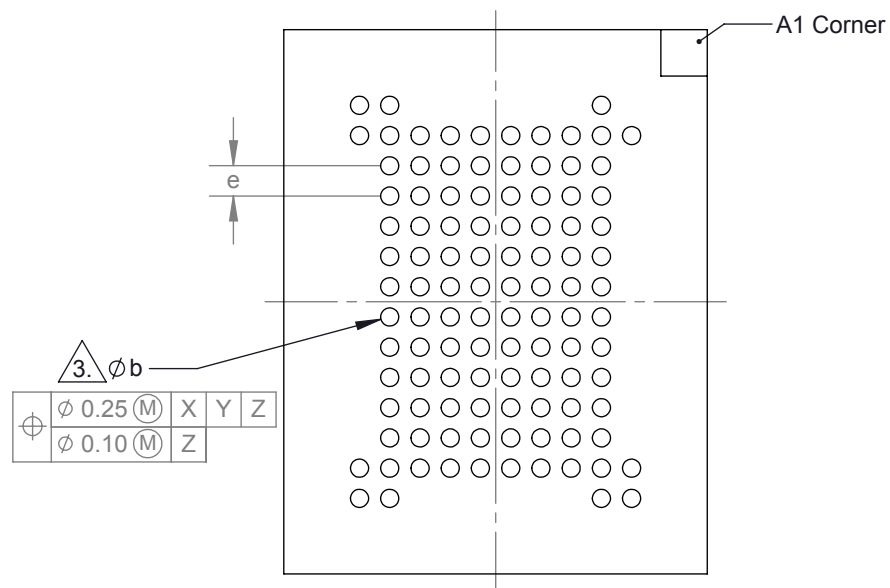

ϕ	ϕ 0.25 (M)	X	Y	Z
	ϕ 0.10 (M)	Z		

SIDE VIEW

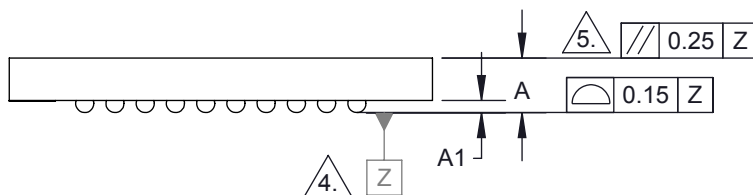

DIM	Minimum	Maximum
A		1.80
A1	0.40	
b	0.50	0.70
D	14.0 BSC	
E	18.0 BSC	
e	1.00 BSC	

Array: 10x14

- Dimensions are in millimeters.
- Interpret dimensions and tolerances per ASME Y14.5M-1994.
- Dimension b is measured at the maximum solder ball diameter, parallel to datum plane Z.
- Datum Z (seating plane) is defined by the spherical crowns of the solder balls.
- Parallelism measurement shall exclude any effect of mark on top surface of package.

DESCRIPTION: Compatible IC

Primary dimension units are millimeters, Secondary dimension units are [inches].

Tolerances: diameters $\pm 0.03\text{mm}$ [$\pm 0.001"$], all other tolerances $\pm 0.13\text{mm}$ [$\pm 0.005"$] unless stated otherwise. Materials and specifications are subject to change without notice.

SG-BGA-6361 Drawing



Ironwood Electronics, Inc.
 Tele: (800) 404-0204
 www.ironwoodelectronics.com

WEIGHT: 12.62
 MATERIAL: N/A
 FINISH: N/A

STATUS: Released

DRAWN BY: S. Huang

File: SG-BGA-6361

SHEET: 3 of 4

SCALE: 4:1

DATE: 5/24/2012

REV. A

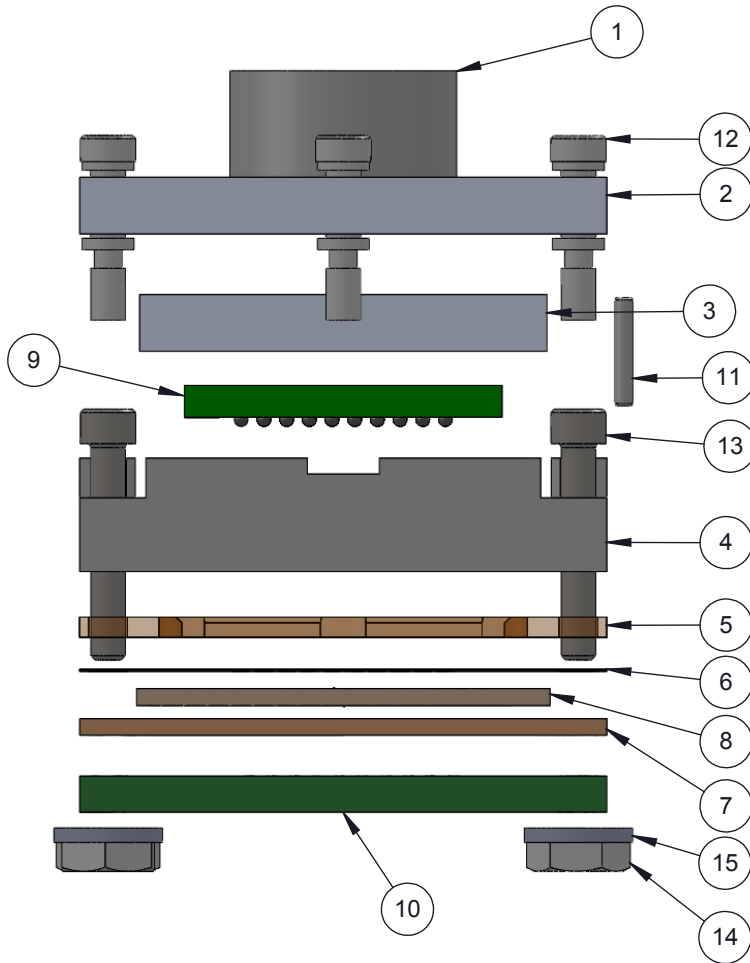

ITEM NO.	DESCRIPTION	Material
1	Compression Screw M10	7075-T6 Alumium Alloy
2	Socket Lid	7075-T6 Aluminum Alloy
3	Compression Plate	7075-T6 Aluminum Alloy
4	Socket Base 18mm	7075-T6 (SN)
5	IC Guide 14x18mm	Ultem 1000
6	Ball Guide 10x14 array 1mm pitch	Kapton Polyimide/Cirlex
7	Elastomer Guide	Ultem 1000
8	0.75mm thick 0.1mm pitch 63 deg angled elastomer	Silicon Rubber
9	BGA107 IC 1mm pitch	Material <not specified>
10	Test PCB	High Temp FR4
11	Dowel Pin, 1/32" x 3/16", SS	Chrome Stainless Steel
12	#0-80 Shoulder Screw, 0.090" thread length	Stainless Steel (303)
13	#0-80 X .375 LG, SOC HD CAP SCREW, ALLOY STL, BLK OXIDE	Alloy Steel
14	Nut, #0-80, SS	Stainless Steel (18-8)
15	Washer, #0 x .025", Nylon	Nylon 6/6

DESCRIPTION: Socket Assy

Primary dimension units are millimeters, Secondary dimension units are [inches]. All tolerances $\pm 0.13\text{mm}$ [$\pm 0.005"$] unless stated otherwise. Materials and specifications are subject to change without notice.

SG-BGA-6361 Drawing

Ironwood Electronics, Inc.
 Tele: (800) 404-0204
 www.ironwoodelectronics.com

WEIGHT: 12.62
 MATERIAL: N/A
 FINISH: N/A

STATUS: Released	SHEET: 4 of 4	REV. A
DRAWN BY: S. Huang	SCALE: 3:1	
File: SG-BGA-6361	DATE: 5/24/2012	

