

FBC SERIES

RoHS
Compliant

2mm PITCH CONNECTOR FOR DISCRETE CABLE/ CRIMP TYPE

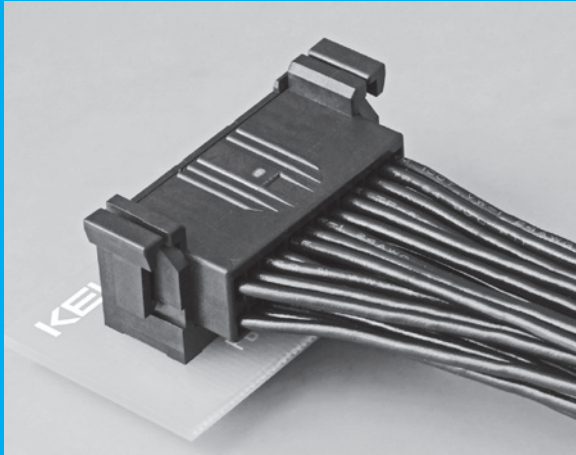

FEATURES

- ▶ Side cable-entry type connector with stacked mating structure.
- ▶ Provided with an E-Lock type locking mechanism with high operability.
- ▶ The E-Lock mechanism prevents accidental disengagement, maintaining stable contact performance.
- ▶ With a twin-leaf pinching 2 point contact structure adopted as a contact mechanism, improved reliability based on stable contact performance is ensured.
- ▶ Three sizes : 26, 36 and 40 pins.
- ▶ For discrete cable. (#22 AWG, #24 AWG and #26 AWG)

ORDER CODE

FBC02- **-1**

① ② ③

*Please order in multiples of the quantity per package.

① **[Type]** **FBC02** : Plug (Cable side connector)

③ **[Housing Color]** **1** : Black

② **[Number of contacts]** **026** : 26 pin **036** : 36 pin **040** : 40 pin

*Above order code FBC02-□□□-1 is for the housing only, contact terminals are sold separately. About #587 order code, Please refer to the bottom of this page.

ORDER CODE

FBC11- **-1-B**

① ② ③ ④

*Please order in multiples of the quantity per package.

① **[Type]** **FBC11** : Receptacle (PCB side connector)

③ **[Insulator Color]** **1** : Black

② **[Number of contacts]** **026** : 26 pin **036** : 36 pin **040** : 40 pin

④ **[Height]** **B** : 3.5mm

SPECIFICATIONS

Material and plating		Electrical Characteristics	
Insulator material	Glass-filled Nylon 66(UL94V-0)	Current rating	3A per contact
Contact material	[FBC02]Copper alloy	Contact resistance	40mΩ max.
	[FBC11]Brass	Dielectric withstanding voltage	650V AC for 1 minute
Contact plating	[FBC02] (Contact area)Gold over Nickel	Insulation resistance	1000MΩ min. at 500V DC
	(Crimping area)Tin over Nickel	Operating temperature	-40°C to +85°C
	[FBC11] Gold over Nickel	Recommended cable	#22/24/26 AWG Discrete wire cables (Insulation Dia.: φ1.0~φ1.5mm)

Contact Terminal

Unit : mm (inch)

◆ Contact terminal for FBC02-□□□-1 plug (Cable side connector)

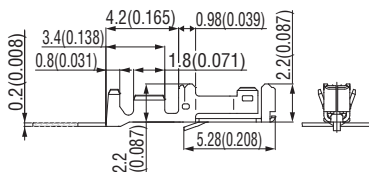

▶ Product Table

Part Number	Number of packaging
#587	10,000

Packaging style
Tape&Reel

ORDER CODE

#587

①

*Please order in multiples of the quantity per package.

① **[Contact]** **#587** : Crimping type contact for FBC02

Assembly Tool

Unit : mm (inch)

▶ Crimping Machine

Mating Contact	#587	Crimping Machine	LPC220S
Manufacturer	JAPAN AUTOMATIC MACHINE CO., LTD	Applicator	EFS841800

A crimping machine and applicator are available for purchase from Japan Automatic Machine Co., Ltd.

B.C.E. S.r.l.

Via Regina Pacis, 54/c - I 41049 Sassuolo (MO)
Tel.: (+39) 0536 811616 - Fax.: (+39) 0536 811500

e-mail: bce@bce.it - Website: www.bce.it

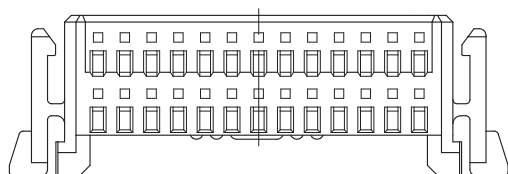
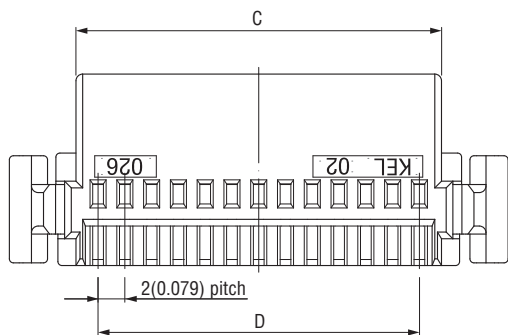
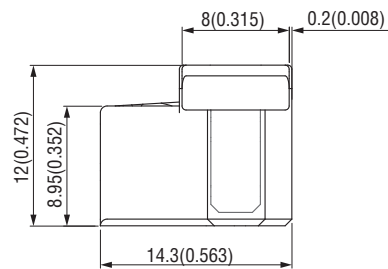
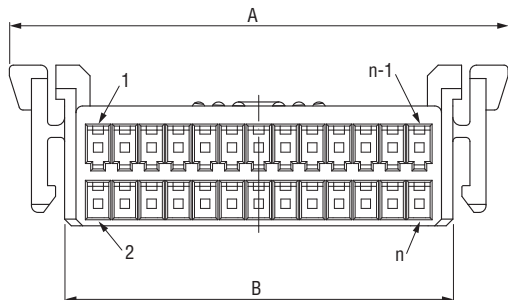
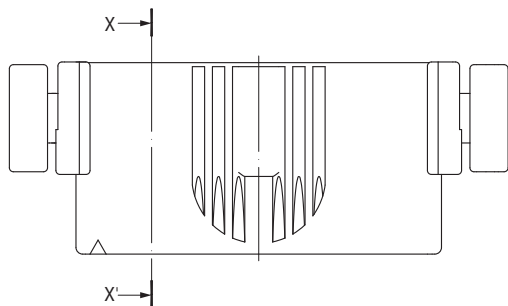
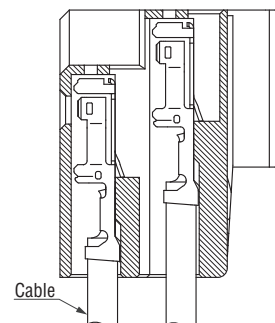
X-X' Cross Section

"n" is number of contacts.

Packaging style

Tray

Product Table / Dimensions

No. of contacts	Part Number	A	B	C	D	Number of packaging
26	FBC02-026-1	37.25 (1.467)	29.0 (1.142)	27.3 (1.075)	24.0 (0.945)	125
36	FBC02-036-1	47.25 (1.860)	39.0 (1.535)	37.3 (1.469)	34.0 (1.339)	100
40	FBC02-040-1	51.25 (2.018)	43.0 (1.693)	41.3 (1.626)	38.0 (1.496)	100

FBC11-□□□-1-B (Receptacle, PCB side connector)

Unit : mm(inch)

▶ Printed Circuit Board Layout (Component Side View)

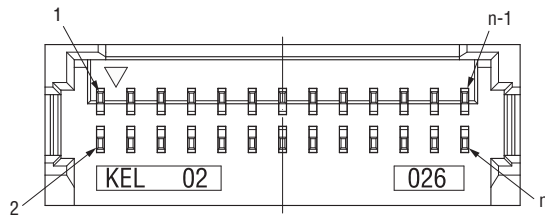
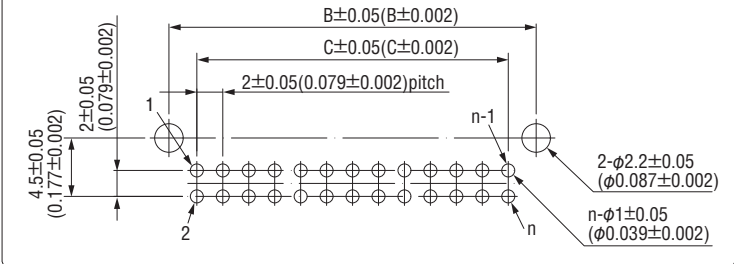

X-X' Cross Section

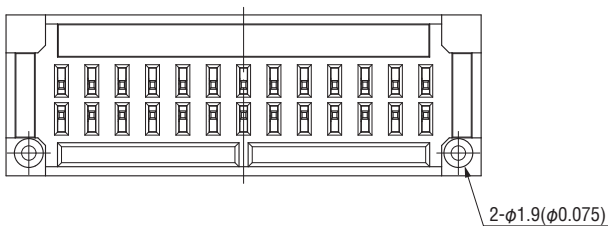
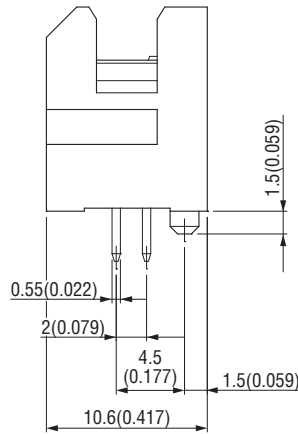
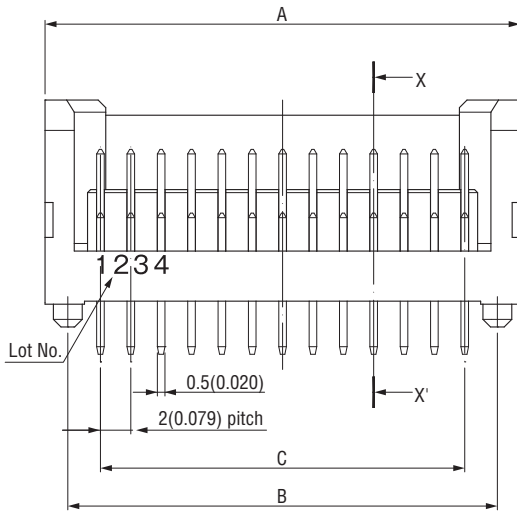
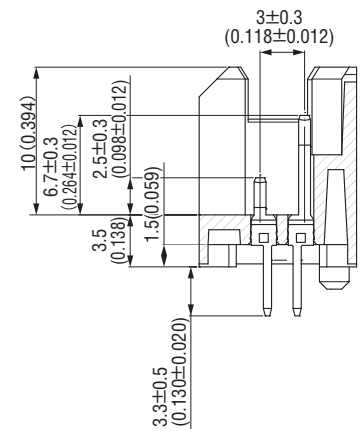

Packaging style

Pipe

▶ Product Table / Dimensions

No. of contacts	Part Number	A	B	C	Number of packaging
26	FBC11-026-1-B	31.3 (1.232)	28.3 (1.114)	24.0 (0.945)	16
36	FBC11-036-1-B	41.3 (1.626)	38.3 (1.508)	34.0 (1.339)	12
40	FBC11-040-1-B	45.3 (1.783)	42.3 (1.665)	38.0 (1.496)	11