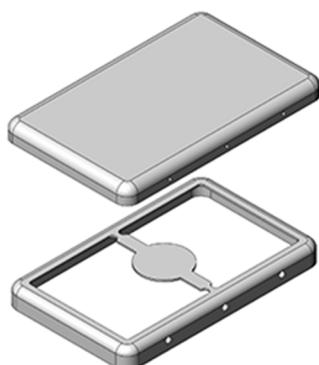

MS On-Board
[See More](#)

Introducing: MS345-20

Standard Drawn EMI/RFI Shield
Seamless Protective Cage!

Two-piece RF Shield **34.5 x 21.5 x 3.2 mm**, EMI Shielded Can, RF Shielding Cabinet for PCB, Board Level Shielding, Tin Plated Steel

Complimentary **CAD files** downloads are available online for immediate implementation.

[Download CAD files](#)

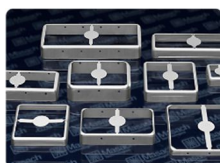

Check out our wide range of standard shields

Pick out your required shield

[Available Now Online!](#)

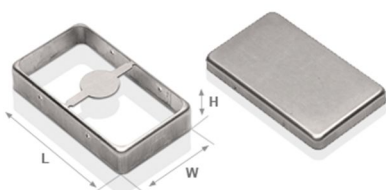

MS Drawn EMI/RFI Shields Features & Benefits:

Seamless Protective Cage

For higher shielding effectiveness.

Solid Construction

To resist dents and warps.

Optimal Planarity

For higher yield on reflow soldering.

Two-piece Shield Design

enables to repair components without removing the shield, saving time and reducing repair damage.

You may also like:



MASACH ENGINEERING SAMPLE KIT
[Product Page](#)



MASACH CATALOGUE
[Download](#)