



POWER Connector

1. Specifications	275
2. How to Order	276
3. Contact Pin Arrangement	277
4. Item List	278

Power Connector(8A) for Panel, Molded with Cable,Field Installable

Power Connector(12A) for Panel, Molded with Cable,Field Installable

Power Connector(20A) Molded with Cable



SPECIFICATIONS

POWER CONNECTOR

No.	SPECIFICATIONS	STANDARD VALUE
01	Manufacturer Identifications	Power Connector
02	Description	Panel Mount, Molded with Cable and Field Installable
03	Current Rating	8A, 12A, 20A
04	Pin Configuration	2 to 7 Contacts
05	Material	Contacts: Copper Alloy, Gold Plated Connector Body: Nylon + GF, UL Recognized
06	Temperature Range	Cable: -20°C to +80°C Connector Body: -40°C to +105°C
07	Waterproof Rating	IP 67
08	Contact Resistance	≤ 20 mΩ
09	Insulation Resistance	≥ 100 MΩ at 250V DC
10	Durability	1000 Times
11	Breakdown Voltage	≥ AC 1000V / 1 Minute

HOW TO ORDER

POWER CONNECTOR

LTW 1 2 - 3 4 5 6 7 - 8 9 10 11 12

LT : Liang Tei

W : Waterproof

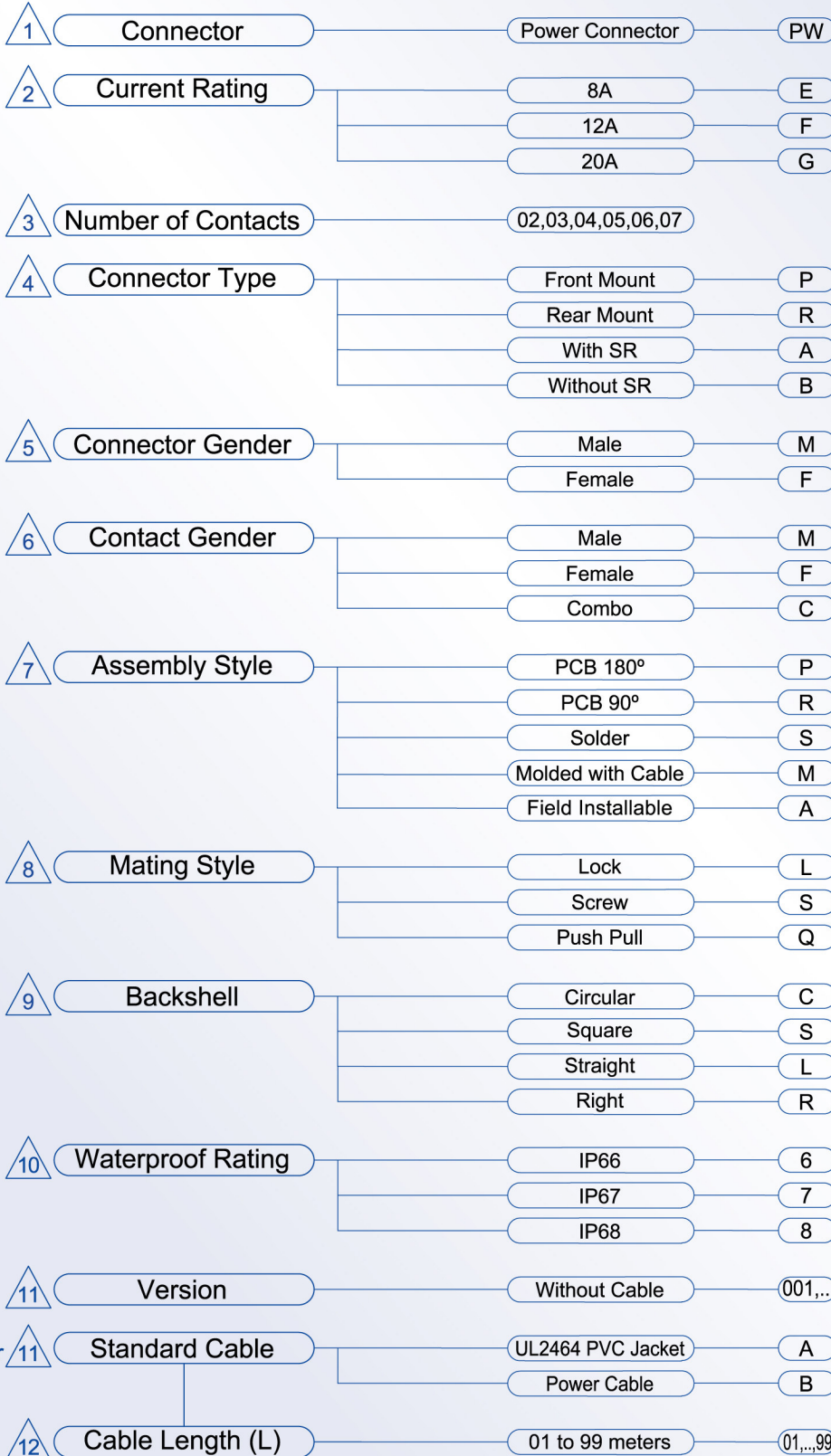
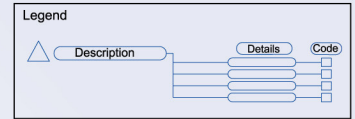

POWER

CONTACT PIN ARRANGEMENTS

POWER CONNECTOR

8A Current

5 Contact

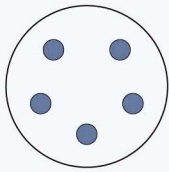

6 Contact

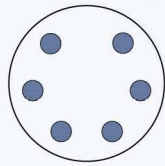

7 Contact

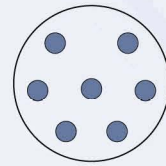

12A Current

2 Contact

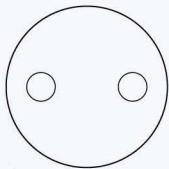

3 Contact

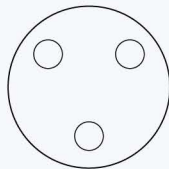

4 Contact

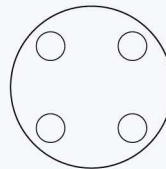

20A Current



3 Contact

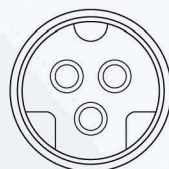

POWER CONNECTOR

Current Rating	Item Number	Number of Contacts	DESCRIPTION	Page	Old Item Number
8A	Panel				
	LTWPWE-3\PMMS-SC7001	05 to 07	Front Mount. Solder. Male Connector. Circular Backshell.	279	LTWPWE-3\PMMS-SC
	LTWPWE-3\PFFS-SC7001	05 to 07	Front Mount. Solder. Female Connector. Circular Backshell.	280	LTWPWE-3\PFFS-SC
	Molded with Cable				
	LTWPWE-3\AMMM-SL7A12	05 to 07	With SR. Molded with Cable. Male Connector. Straight.	281	LTWPWE-3\AMMM-S180
	LTWPWE-3\AFFM-SL7A12	05 to 07	With SR. Molded with Cable. Female Connector. Straight.	282	LTWPWE-3\AFFM-S180
	Field Installable				
	LTWPWE-3\BMMA-SL7001	05 to 07	Without SR. Field Installable (Solder Pins). Male Connector. Straight.	283	LTWPWE-3\BMMA-S180
	LTWPWE-3\BFFA-SL7001	05 to 07	Without SR. Field Installable (Solder Pins). Female Connector. Straight.	284	LTWPWE-3\BFFA-S180
	12A	Panel			
LTWPWF-3\PMMS-SC7001		02 to 04	Front Mount. Solder. Male Connector. Circular Backshell.	285	LTWPWF-3\PMMS-SC
LTWPWF-3\PFFS-SC7001		02 to 04	Front Mount. Solder. Female Connector. Circular Backshell.	286	LTWPWF-3\PFFS-SC
Molded with Cable					
LTWPWF-3\AMMM-SL7A12		02 to 04	With SR. Molded with Cable. Male Connector. Straight.	287	LTWPWF-3\AMMM-S180
LTWPWF-3\AFFM-SL7A12		02 to 04	With SR. Molded with Cable. Female Connector. Straight.	288	LTWPWF-3\AFFM-S180
Field Installable					
LTWPWF-3\BMMA-SL7001		02 to 04	Without SR. Field Installable (Solder Pins). Male Connector. Straight.	289	LTWPWF-3\BMMA-S180
LTWPWF-3\BFFA-SL7001		02 to 04	Without SR. Field Installable (Solder Pins). Female Connector. Straight.	290	LTWPWF-3\BFFA-S180
20A		Molded with Cable			
	LTWPWG-03BMMM-SL6B12	03	Without SR. Molded with Cable. Male Connector. Straight.	291	New Product
	LTWPWG-03BFFM-SL6B12	03	Without SR. Molded with Cable. Female Connector. Straight.	292	New Product

Power Connector Screw Type Series (8A): Panel Mount (Male)



LTWPWE-³PMMS-SC7001

Old Part Number: LTWPWE-³PMMS-SC



Specifications

DESCRIPTION	DETAILS	CODE
1 Connector	Power Connector	PW
2 Current Rating	8A	E
³ Number of Contacts	5, 6, 7	05,06,07
4 Connector Type	Front Mount	P
5 Connector Gender	Male	M
6 Contact Gender	Male	M
7 Assembly Style	Solder	S
8 Mating Style	Screw	S
9 Backshell	Circular	C
10 Waterproof Rating	IP67	7
11 Version		001

10, 11 Excluded in Old Part Number

Material

Pin : Copper Alloy, 6u" Gold Plated
 Connector Body : Nylon + GF, UL Recognized
 Temperature Range : -40 °C to 105 °C

Recommended Panel Cut-Out

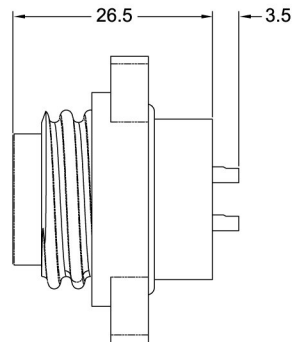
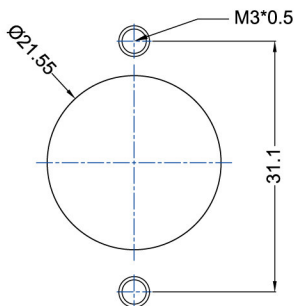

Pin Configurations

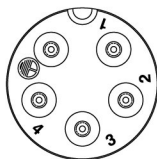

05 pins

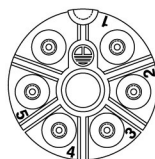

06 pins

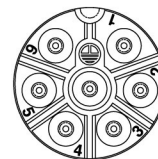

07 pins

Mating Parts



LTWPWE-³AFFM-SL7A¹²

See Item List



LTWPWE-³BFFA-SL7001

See Item List

Power Connector Screw Type Series (8A): Panel Mount (Female)



LTWPWE-³PFFS-SC7001

Old Part Number: LTWPWE-³PFFS-SC



Specifications

DESCRIPTION	DETAILS	CODE
1 Connector	Power Connector	PW
2 Current Rating	8A	E
³ Number of Contacts	5, 6, 7	05,06,07
4 Connector Type	Front Mount	P
5 Connector Gender	Female	F
6 Contact Gender	Female	F
7 Assembly Style	Solder	S
8 Mating Style	Screw	S
9 Backshell	Circular	C
10 Waterproof Rating	IP67	7
11 Version		001

10, 11 Excluded in Old Part Number

Material

Pin : Copper Alloy, 6u" Gold Plated
 Connector Body : Nylon + GF, UL Recognized
 Temperature Range : -40 °C to 105 °C

Recommended Panel Cut-Out

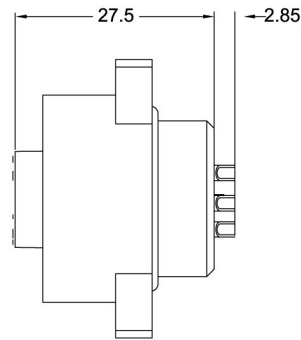
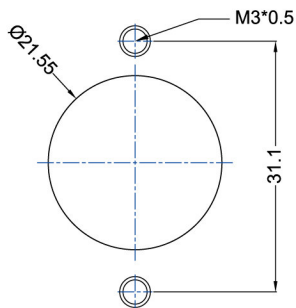

Pin Configurations



05 pins



06 pins

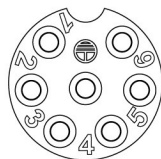

07 pins

Mating Parts



LTWPWE-³AMMM-SL7A¹²

See Item List



LTWPWE-³BMMA-SL7001

See Item List

Power Connector Screw Type Series (8A): Molded with Cable (Male)

LTWPWE-³AMMM-SL7A¹²

Old Part Number: LTWPWE-³AMMM-S180



Specifications

DESCRIPTION	DETAILS	CODE
1 Connector	Power Connector	PW
2 Current Rating	8A	E
³ Number of Contacts	5, 6, 7	05,06,07
4 Connector Type	With SR	A
5 Connector Gender	Male	M
6 Contact Gender	Male	M
7 Assembly Style	Molded with Cable	M
8 Mating Style	Screw	S
9 Backshell	Straight	L
10 Waterproof Rating	IP67	7
11 Standard Cable	UL2464 PVC Jacket	A
¹² Cable Length (L)	1 to 99 meters	01,...,99

10, 11, ¹² Excluded in Old Part Number

Material

Pin : Copper Alloy, 6u" Gold Plated
 Connector Body : Nylon + GF, UL Recognized
 Cable Temperature : -20 °C to 80 °C

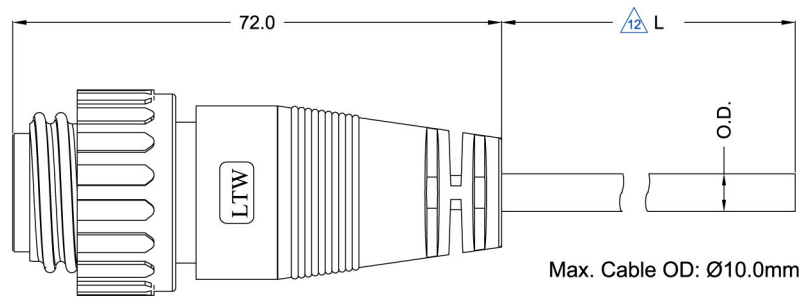

Pin Configurations

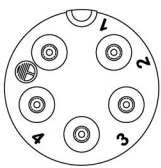

05 pins

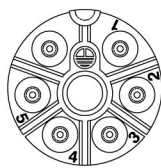

06 pins

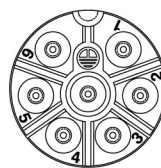

07 pins

LTW Standard Cable:

No. of Pins	Cable Part no.	Type	Color	OD(mm)
05	WCA0576UV01	PVC	Black	6.5
06	WCA0577UV01	PVC	Black	6.5
07	WCA0521UV01	PVC	Black	6.5

Note: Please see Cable Index for further details

Mating Parts



LTWPWE-³PFFS-SC7001

See Item List



LTWPWE-³AFFM-SL7A¹²

See Item List



LTWPWE-³BFFA-SL7001

See Item List

Power Connector Screw Type Series (8A): Molded with Cable (Female)

LTWPWE-³AFFM-SL7A¹²

Old Part Number: LTWPWE-³AFFM-S180



Specifications

DESCRIPTION	DETAILS	CODE
1 Connector	Power Connector	PW
2 Current Rating	8A	E
³ Number of Contacts	5, 6, 7	05,06,07
4 Connector Type	With SR	A
5 Connector Gender	Female	F
6 Contact Gender	Female	F
7 Assembly Style	Molded with Cable	M
8 Mating Style	Screw	S
9 Backshell	Straight	L
10 Waterproof Rating	IP67	7
11 Standard Cable	UL2464 PVC Jacket	A
¹² Cable Length (L)	1 to 99 meters	01,...,99

10, 11, ¹² Excluded in Old Part Number

Material

Pin : Copper Alloy, 6u" Gold Plated
 Connector Body : Nylon + GF, UL Recognized
 Cable Temperature : -20 °C to 80 °C

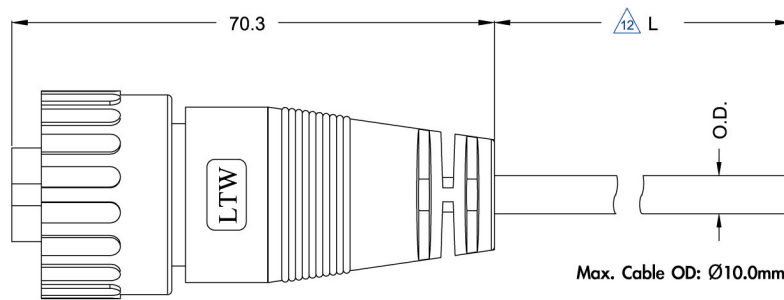

Pin Configurations



05 pins



06 pins

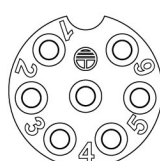

07 pins

LTW Standard Cable:

No. of Pins	Cable Part no.	Type	Color	OD(mm)
05	WCA0576UV01	PVC	Black	6.5
06	WCA0577UV01	PVC	Black	6.5
07	WCA00010049	PVC	Black	6.5

Note: Please see Cable Index for further details

Mating Parts



LTWPWE-³PMMS-SC7001

See Item List



LTWPWE-³AMMM-SL7A¹²

See Item List



LTWPWE-³BMMA-SL7001

See Item List

Power Connector Screw Type Series (8A): Field Installable (Male)

LTWPWE-³BMMA-SL7001

Old Part Number: LTWPWE-³BMMA-S180



Specifications

DESCRIPTION	DETAILS	CODE
1 Connector	Power Connector	PW
2 Current Rating	8A	E
³ Number of Contacts	5, 6, 7	05,06,07
4 Connector Type	Without SR	B
5 Connector Gender	Male	M
6 Contact Gender	Male	M
7 Assembly Style	Field Installable (Solder Pins)	A
8 Mating Style	Screw	S
9 Backshell	Straight	L
10 Waterproof Rating	IP67	7
11 Version	Without Cable	001

Material

Pin : Copper Alloy, 6u" Gold Plated
 Connector Body : Nylon + GF, UL Recognized
 Temperature Range : -40 °C to 105 °C

10, 11 Excluded in Old Part Number

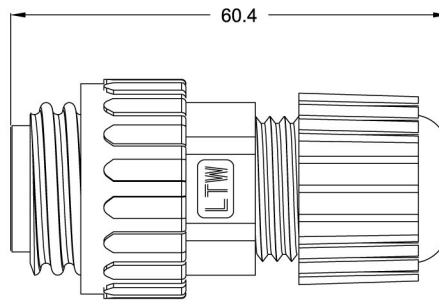

Seals for Cable OD: Ø5.5mm-Ø10.8mm

Pin Configurations

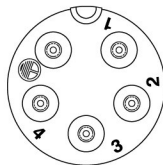

05 pins

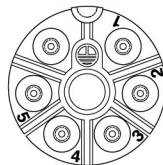

06 pins

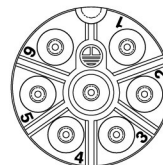

07 pins

Mating Parts



LTWPWE-³PFFS-SC7001

See Item List



LTWPWE-³AFFM-SL7A¹²

See Item List



LTWPWE-³BFFA-SL7001

See Item List

Power Connector Screw Type Series (8A): Field Installable (Female)

LTWPWE-³BFFA-SL7001

Old Part Number: LTWPWE-³BFFA-S180



Specifications

DESCRIPTION	DETAILS	CODE
1 Connector	Power Connector	PW
2 Current Rating	8A	E
³ Number of Contacts	5, 6, 7	05,06,07
4 Connector Type	Without SR	B
5 Connector Gender	Female	F
6 Contact Gender	Female	F
7 Assembly Style	Field Installable (Solder Pins)	A
8 Mating Style	Screw	S
9 Backshell	Straight	L
10 Waterproof Rating	IP67	7
11 Version	Without Cable	001

10, 11 Excluded in Old Part Number

Material

Pin : Copper Alloy, 6u" Gold Plated
 Connector Body : Nylon + GF, UL Recognized
 Temperature Range : -40 °C to 105 °C

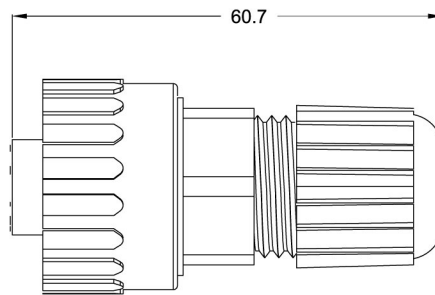

Seals for Cable OD: Ø5.5m~Ø10.8mm

Pin Configurations



05 pins



06 pins

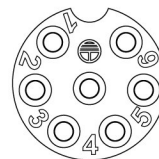

07 pins

Mating Parts



LTWPWE-³PMMS-SC7001

See Item List



LTWPWE-³AMMM-SL7A¹²

See Item List



LTWPWE-³BMMA-SL7001

See Item List

Power Connector Screw Type Series (12A): Panel Mount (Male)



LTWPWF-³PMMS-SC7001

Old Part Number: LTWPWF-³PMMS-SC



Specifications

DESCRIPTION	DETAILS	CODE
1 Connector	Power Connector	PW
2 Current Rating	12A	F
³ Number of Contacts	2, 3, 4	02,03,04
4 Connector Type	Front Mount	P
5 Connector Gender	Male	M
6 Contact Gender	Male	M
7 Assembly Style	Solder	S
8 Mating Style	Screw	S
9 Backshell	Circular	C
10 Waterproof Rating	IP67	7
11 Version		001

10, 11 Excluded in Old Part Number

Material

Pin : Copper Alloy, 6u" Gold Plated
 Connector Body : Nylon + GF, UL Recognized
 Temperature Range : -40 °C to 105 °C

Recommended Panel Cut-Out

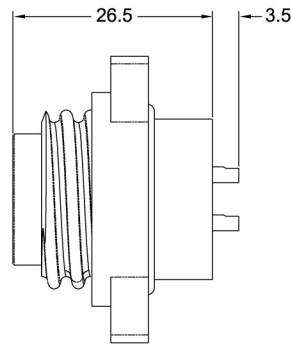
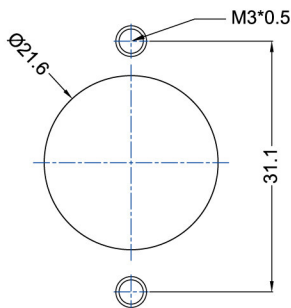

Pin Configurations

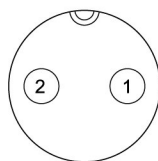

02 pins

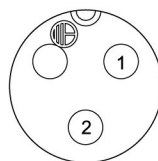

03 pins

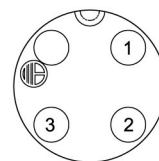

04 pins

Mating Parts



LTWPWF-³AFFM-SL7A-¹²

See Item List



LTWPWF-³BFFA-SL7001

See Item List

Power Connector Screw Type Series (12A): Panel Mount (Female)



LTWPWF-³PFFS-SC7001

Old Part Number: LTWPWF-³PFFS-SC



Specifications

DESCRIPTION	DETAILS	CODE
1 Connector	Power Connector	PW
2 Current Rating	12A	F
³ Number of Contacts	2, 3, 4	02,03,04
4 Connector Type	Front Mount	P
5 Connector Gender	Female	F
6 Contact Gender	Female	F
7 Assembly Style	Solder	S
8 Mating Style	Screw	S
9 Backshell	Circular	C
10 Waterproof Rating	IP67	7
11 Version		001

10, 11 Excluded in Old Part Number

Material

Pin : Copper Alloy, 6u" Gold Plated
 Connector Body : Nylon + GF, UL Recognized
 Temperature Range : -40 °C to 105 °C

Recommended Panel Cut-Out

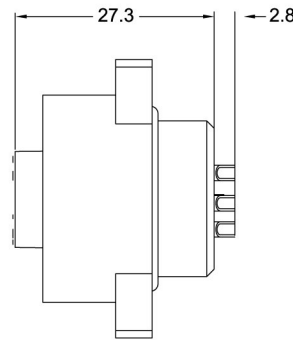
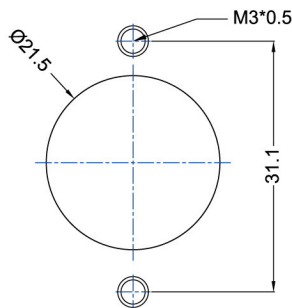

Pin Configurations

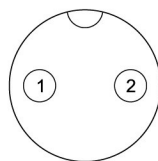

02 pins

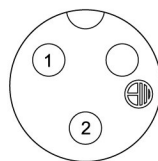

03 pins

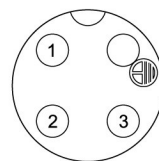

04 pins

Mating Parts



LTWPWF-³AMMM-SL7A¹²

See Item List



LTWPWF-³BMMA-SL7001

See Item List

Power Connector Screw Type Series (12A): Molded with Cable (Male)

LTWPWF-³AMMM-SL7A¹²

Old Part Number: LTWPWF-³AMMM-S180



Specifications

DESCRIPTION	DETAILS	CODE
1 Connector	Power Connector	PW
2 Current Rating	12A	F
³ Number of Contacts	2, 3, 4	02,03,04
4 Connector Type	With SR	A
5 Connector Gender	Male	M
6 Contact Gender	Male	M
7 Assembly Style	Molded with Cable	M
8 Mating Style	Screw	S
9 Backshell	Straight	L
10 Waterproof Rating	IP67	7
11 Standard Cable	UL2464 PVC Jacket	A
¹² Cable Length (L)	1 to 99 meters	01,...,99

Material

Pin : Copper Alloy, 6u" Gold Plated
 Connector Body : Nylon + GF, UL Recognized
 Cable Temperature : -20 °C to 80 °C

10, 11, ¹² Excluded in Old Part Number

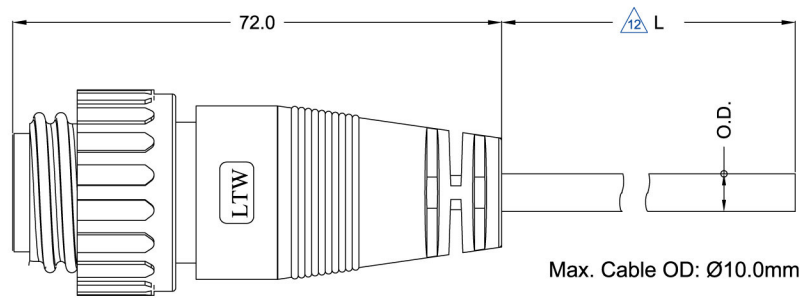

Pin Configurations

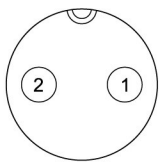

02 pins

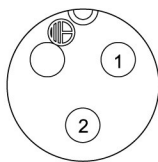

03 pins

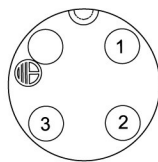

04 pins

LTW Standard Cable:

No. of Pins	Cable Part no.	Type	Color	OD(mm)
02	WCA0264UV01	PVC	Black	7.5
03	WCA0579UV01	PVC	Black	7.5
04	WCA0285UV01	PVC	Black	7.5

Note: Please see Cable Index for further details

Mating Parts



LTWPWF-³PFFS-SC7001

See Item List



LTWPWF-³AFFM-SL7A¹²

See Item List



LTWPWF-³BFFA-SL7001

See Item List

Power Connector Screw Type Series (12A): Molded with Cable (Female)

LTWPWF-³AFFM-SL7A¹²

Old Part Number: LTWPWF-³AFFM-S180



Specifications

DESCRIPTION	DETAILS	CODE
1 Connector	Power Connector	PW
2 Current Rating	12A	F
³ Number of Contacts	2, 3, 4	02,03,04
4 Connector Type	With SR	A
5 Connector Gender	Female	F
6 Contact Gender	Female	F
7 Assembly Style	Molded with Cable	M
8 Mating Style	Screw	S
9 Backshell	Straight	L
10 Waterproof Rating	IP67	7
11 Standard Cable	UL2464 PVC Jacket	A
¹² Cable Length (L)	1 to 99 meters	01,...,99

10, 11, ¹² Excluded in Old Part Number

Material

Pin : Copper Alloy, 6u" Gold Plated
 Connector Body : Nylon + GF, UL Recognized
 Cable Temperature : -20 °C to 80 °C

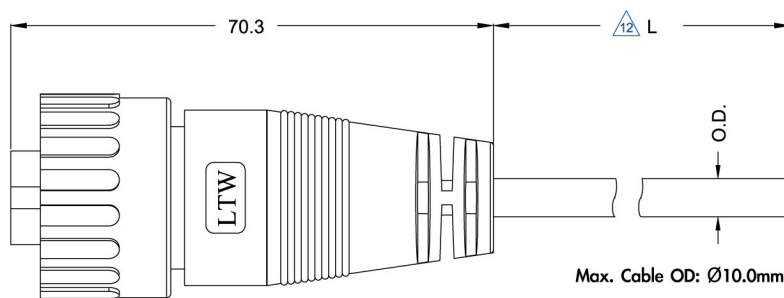

Pin Configurations

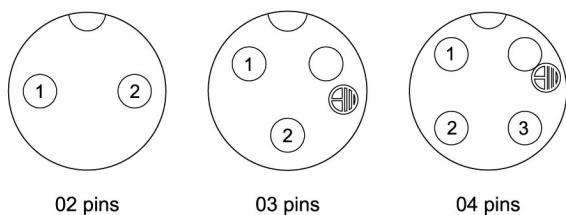

LTW Standard Cable:

No. of Pins	Cable Part no.	Type	Color	OD(mm)
02	WCA0264UV01	PVC	Black	7.5
03	WCA0579UV01	PVC	Black	7.5
04	WCA0285UV01	PVC	Black	7.5

Note: Please see Cable Index for further details

Mating Parts



LTWPWF-³PMMS-SC7001
See Item List



LTWPWF-³AMMM-SL7A¹²
See Item List



LTWPWF-³BMMA-SL7001
See Item List

Power Connector Screw Type Series (12A): Field Installable (Male)

LTWPWF-³BMMA-SL7001

Old Part Number: LTWPWF-³BMMA-S180



Specifications

	DESCRIPTION	DETAILS	CODE
1	Connector	Power Connector	PW
2	Current Rating	12A	F
³	Number of Contacts	2, 3, 4	02,03,04
4	Connector Type	Without SR	B
5	Connector Gender	Male	M
6	Contact Gender	Male	M
7	Assembly Style	Field Installable (Solder Pins)	A
8	Mating Style	Screw	S
9	Backshell	Straight	L
10	Waterproof Rating	IP67	7
11	Version	Without Cable	001

10, 11 Excluded in Old Part Number

Material

Pin : Copper Alloy, 6u" Gold Plated
 Connector Body : Nylon + GF, UL Recognized
 Temperature Range : -40 °C to 105 °C

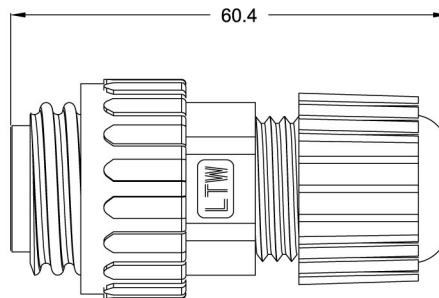

Seals for Cable OD: Ø5.5mm-Ø10.8mm

Pin Configurations

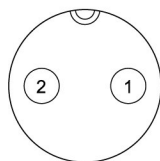

02 pins

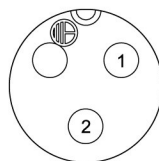

03 pins

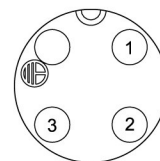

04 pins

Mating Parts



LTWPWF-³PFFS-SC7001

See Item List



LTWPWF-³AFFM-SL7A¹²

See Item List



LTWPWF-³BFFA-SL7001

See Item List

Power Connector Screw Type Series (12A): Field Installable (Female)

LTWPWF-³BFFA-SL7001

Old Part Number: LTWPWF-³BFFA-S180



Specifications

DESCRIPTION	DETAILS	CODE
1 Connector	Power Connector	PW
2 Current Rating	12A	F
³ Number of Contacts	2, 3, 4	02,03,04
4 Connector Type	Without SR	B
5 Connector Gender	Female	F
6 Contact Gender	Female	F
7 Assembly Style	Field Installable (Solder Pins)	A
8 Mating Style	Screw	S
9 Backshell	Straight	L
10 Waterproof Rating	IP67	7
11 Version	Without Cable	001

10, 11 Excluded in Old Part Number

Material

Pin : Copper Alloy, 6u" Gold Plated
 Connector Body : Nylon + GF, UL Recognized
 Temperature Range : -40 °C to 105 °C

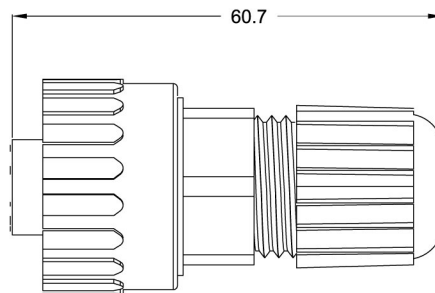

Seals for Cable OD: Ø5.5m~Ø10.8mm

Pin Configurations

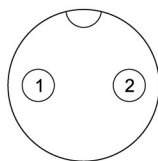

02 pins

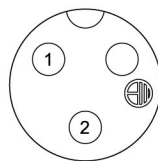

03 pins

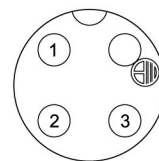

04 pins

Mating Parts



LTWPWF-³PMMS-SC7001

See Item List



LTWPWF-³AMMM-SL7A¹²

See Item List



LTWPWF-³BMMA-SL7001

See Item List