



SENSOR Connector

1. Specifications	164
2. How to Order	165
3. Contact Pin Arrangement	166
4. Item List	
Sensor M8(5A) · M105(2A) for Panel, Molded with Cable	167
Sensor M12(2A & 5A) for Panel, Molded with Cable, Field Installable	177
Sensor M12 B-Code(5A) for Panel, Molded with Cable, Field Installable	193
Sensor M12 D-Code(5A) for Panel, Molded with Cable, Field Installable	206
Sensor M12 I-Style(5A) for Panel, Molded with Cable, Field Installable	219



B.C.E. S.r.l.

Via Regina Pacis, 54/c - I 41049 Sassuolo - (MO)

Tel: (+39) 0536 811616 - Fax: (+39) 0536 811500

E-mail.: bce@bce.it • Home Page : www.bce.it

SPECIFICATIONS

SENSOR SERIES

No.	SPECIFICATIONS	STANDARD VALUE
01	Manufacturer Identifications	M8, M10.5, M12, M12 B-Coded, M12 D-Coded, M12 I-Style
02	Description	Panel Mount, Molded with Cable and Field Installable
03	Current Rating	M8: 5A M10.5: 2A M12: 2A, 5A M12 B-Coded: 5A M12 D-Coded: 5A M12 I-Style: 5A
04	Pin Configuration	M8: 3 to 4 Contacts M10.5: 2 to 5 Contacts M12: 3 to 5, 8 Contacts M12 B-Coded: 4 to 5 Contacts M12 D-Coded: 4 to 5 Contacts M12 I-Style: 5 Contacts
05	Material	Contacts: Copper Alloy, Gold Plated Connector Body: Nylon + GF or PU, UL Recognized Shield: Zinc Alloy or Copper Alloy, Nickel Plated
06	Temperature Range	Cable: -25°C to +90°C (PU), -20°C to +80°C (PVC) Connector Body: -25°C to +90°C
07	Waterproof Rating	IP65, IP66, IP67, IP68
08	Contact Resistance	≤ 10 mΩ
09	Insulation Resistance	≥ 100MΩ at DC 500V
10	Breakdown Voltage	≥ AC 500V/1 Minute

HOW TO ORDER

SENSOR CONNECTOR

LTW 1 - 2 3 4 5 6 - 7 8 9 10 11

LT : Liang Tei

W : Waterproof













1	Connector Size	M8	8	M12 B-Coded LED SBL M12 B-Coded Plastic SBP M12 B-Coded Shielded SBS M12 D-Coded 12D M12 D-Coded LED SDL M12 D-Coded Plastic SDP M12 D-Coded Shielded SDS
		M8 Plastic	8P	
		M10.5	105	
		M12, M12 (I-Style)	12	
		M12 LED	12L	
		M12 Plastic, M12 I-Style Plastic	12P	
		M12 Shielded	12S	
		M12 B-Coded	12B	
2	Number of Contacts	02, 03, ..., 08		
3	Connector Type	Panel	P	
		With SR	A	
		Without SR	B	
4	Connector Gender	Male	M	
		Female	F	
5	Contact Gender	Male	M	
		Female	F	
		I-Style	I	
6	Assembly Style	PCB 180°	P	
		PCB 90°	R	
		Solder	S	
		Molded with Cable	M	
		Field Installable (Solder Pins)	A	
		Field Installable (Screw Pins)	B	
		Field Installable (IDC Pins)	C	
7	Mating Style	Lock	L	
		Screw	S	
		Quick	Q	
8	Backshell	Circular	C	
		Front Mount Hexagonal Flange	F	
		Rear Mount Hexagonal Flange	H	
		Straight	L	
		Right	R	
9	Waterproof Rating	IP66	6	
		IP67	7	
		IP68	8	
10	Version	Without Cable	001, ...	
or 10	Standard Cable	UL2464 PVC Jacket	A	
		PU	B	
11	Cable Length (L)	01 to 99 meters	01, ... 99	

CONTACT PIN ARRANGEMENTS

SENSOR CONNECTOR

SENSOR

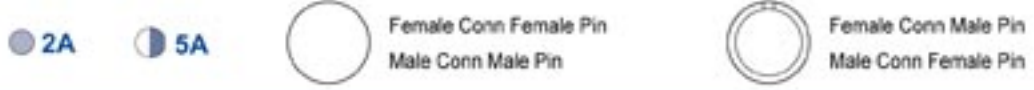
M8	3 Contact	4 Contact		
				
M10.5	2 Contact	3 Contact	4 Contact	5 Contact
				
M12	3 Contact	4 Contact	5 Contact	8 Contact
				
				

SENSOR CONNECTOR: M12 D-CODE

Current Rating	Item Number	Number of Contacts	DESCRIPTION	Page	Old Item Number
5A	Panel				
	LTW12D-PMMS-SH8001	04 to 05	D-Code. Rear Mount. Solder. Male Connector. Hexagonal Backshell.	207	New Product
	LTW12D-PFFS-SH8001	04 to 05	D-Code. Rear Mount. Solder. Female Connector. Hexagonal Backshell.	208	New Product
	LTW12D-PMM-SF8001	04 to 05	D-Code. Front Mount. Solder. Male Connector. Hexagonal Backshell.	209	New Product
	LTW12D-PFF-SF8001	04 to 05	D-Code. Front Mount. Solder. Female Connector. Hexagonal Backshell.	210	New Product
	Molded with Cable				
	LTW12D-BFFM-S	04 to 05	D-Code. Without SR. Molded with Cable. Female Connector. Straight or Right.	211	New Product
	LTW12D-BMMM-S	04 to 05	D-Code. Without SR. Molded with Cable. Male Connector. Straight or Right.	212	New Product
	LTWSDP-BFFM-S	04 to 05	D-Code Plastic. Without SR. Molded with Cable. Female Connector. Straight or Right.	213	New Product
	LTWSDP-BMMM-S	04 to 05	D-Code Plastic. Without SR. Molded with Cable. Male Connector. Straight or Right.	214	New Product
	Field Installable				
	LTW12D-BFFA-SL8001	04 to 05	D-Code. Without SR. Solder. Screw Pins. Female Connector. Straight.	215	New Product
	LTW12D-BMMA-SL8001	04 to 05	D-Code. Without SR. Solder. Screw Pins. Male Connector. Straight.	216	New Product
	LTWSDP-BFFA-SL8001	04 to 05	D-Code Plastic. Without SR. Solder. Screw Pins. Female Connector. Straight.	217	New Product
	LTWSDP-BMMA-SL8001	04 to 05	D-Code Plastic. Without SR. Solder. Screw Pins. Male Connector. Straight.	218	New Product

D-Coded Sensor Connector (5A) : Panel Mount (Male)

LTW12D- Δ 2 PMMS-SH8001

New Product



Specifications

DESCRIPTION	DETAILS	CODE
1 Connector Size	M12 D-Coded	12D
Δ 2 Number of Contacts	4 to 5	04 to 05
3 Connector Type	Panel	P
4 Connector Gender	Male	M
5 Contact Gender	Male	M
6 Assembly Style	Solder	S
7 Mating Style	Screw	S
8 Backshell	Hexagonal Rear Mount	H
9 Waterproof Rating	IP68	8
10 Version	Without Cable	001

Material

Pin : Copper Alloy, 6u" Gold Plated
 Connector Body : Nylon + GF, UL Recognized
 Shield : Zn Alloy or Copper Alloy, Nickel Plated
 Temperature Range : -25 °C to 90 °C

Recommended Panel Cut-Out

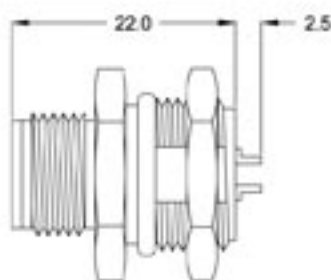
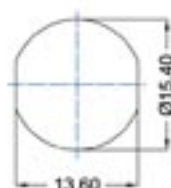

*Waterproof Rating: IP68 (unmated)

Pin Configurations



04 pins



05 pins

Mating Parts



LTW12D- Δ BFFM-S Δ 8 Δ 8 Δ

See Item List



LTW12D- Δ BFFA-SL8001

See Item List

Accessories



See Item List

Sensor D-Code

D-Coded Sensor Connector (5A) : Panel Mount (Female)

LTW12D- Δ 2 PFFS-SH8001

New Product



Material

Pin : Copper Alloy, 6u" Gold Plated
 Connector Body : Nylon + GF, UL Recognized
 Shield : Zn Alloy or Copper Alloy, Nickel Plated
 Temperature Range : -25 °C to 90 °C

Specifications

DESCRIPTION	DETAILS	CODE
1 Connector Size	M12 D-Coded	12D
Δ 2 Number of Contacts	4 to 5	04 to 05
3 Connector Type	Panel	P
4 Connector Gender	Female	F
5 Contact Gender	Female	F
6 Assembly Style	Solder	S
7 Mating Style	Screw	S
8 Backshell	Hexagonal Rear Mount	H
9 Waterproof Rating	IP68	8
10 Version	Without Cable	001

Recommended Panel Cut-Out

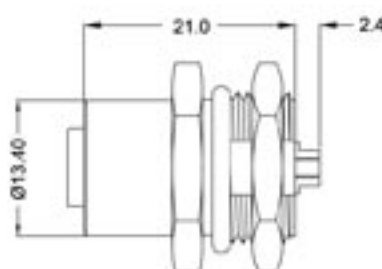
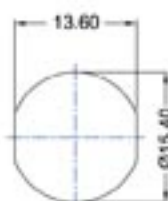

*Waterproof Rating: IP68 (unmated)

Pin Configurations



04 pins



05 pins

Mating Parts



LTW12D- Δ 8BMM-S Δ 8 Δ Δ

See Item List



LTW12D- Δ 8BMA-SL8001

See Item List

Accessories



See Item List

D-Coded Sensor Connector (5A) : Panel Mount (Male)

LTW12D- Δ 2PMM Δ 6-SF8001

New Product



Material

Pin : Copper Alloy, 6u" Gold Plated
 Connector Body : Nylon + GF, UL Recognized
 Shield : Zn Alloy or Copper Alloy, Nickel Plated
 Temperature Range : -25 °C to 90 °C

Specifications

DESCRIPTION	DETAILS	CODE
1 Connector Size	M12 D-Coded	12D
Δ Number of Contacts	4 to 5	04 to 05
3 Connector Type	Panel	P
4 Connector Gender	Male	M
5 Contact Gender	Male	M
Δ Assembly Style	PCB 180° or Solder	P or S
7 Mating Style	Screw	S
8 Backshell	Hexagonal Front Mount	F
9 Waterproof Rating	IP68	8
10 Version	Without Cable	001

Recommended Panel Cut-Out

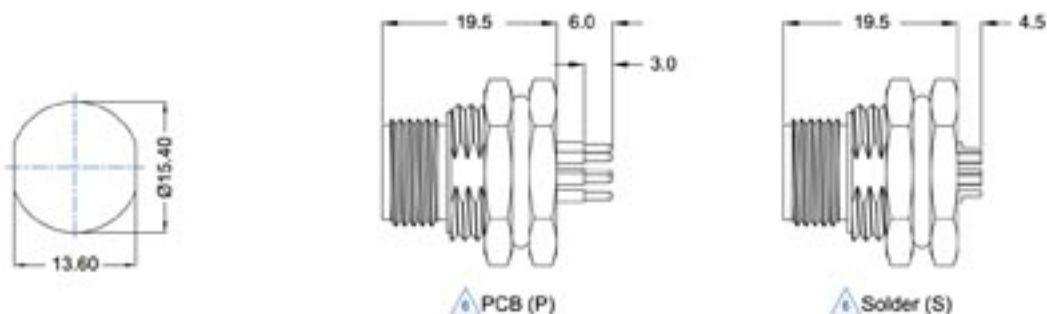

*Waterproof Rating: IP68 (unmated)

*Waterproof Rating: IP68 (unmated)

Pin Configurations and PCB Layouts



04 pins

05 pins

Mating Parts



LTW12D- Δ BFFM-S Δ 8 Δ Δ

See Item List



LTW12D- Δ BFFA-SL8001

See Item List

Accessories



See Item List

D-Coded Sensor Connector (5A) : Panel Mount (Female)

LTW12D- Δ 2PFF Δ 6-SF8001

New Product



Specifications

DESCRIPTION	DETAILS	CODE
1 Connector Size	M12 D-Coded	12D
Δ 2 Number of Contacts	4 to 5	04 to 05
3 Connector Type	Panel	P
4 Connector Gender	Female	F
5 Contact Gender	Female	F
Δ 6 Assembly Style	PCB 180° or Solder	P or S
7 Mating Style	Screw	S
8 Backshell	Hexagonal Front Mount	F
9 Waterproof Rating	IP68	8
10 Version	Without Cable	001

Material

Pin : Copper Alloy, 6u" Gold Plated
 Connector Body : Nylon + GF, UL Recognized
 Shield : Zn Alloy or Copper Alloy, Nickel Plated
 Temperature Range : -25 °C to 90 °C

Recommended Panel Cut-Out

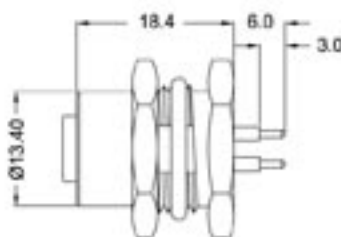
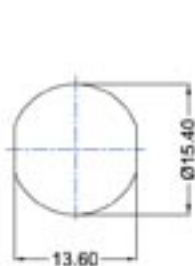

Δ 6 PCB (P)

*Waterproof Rating: IP68 (unmated)

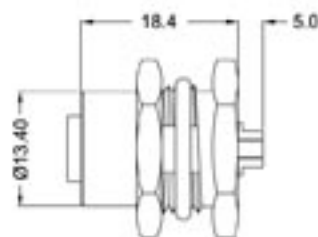

Δ 6 Solder (S)

*Waterproof Rating: IP68 (unmated)

Pin Configurations and PCB Layouts

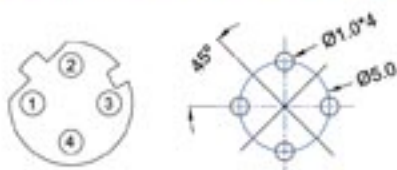

04 pins

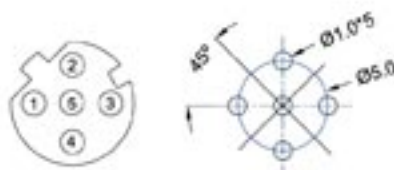

05 pins

Mating Parts



LTW12D- Δ BMMM-S Δ 8 Δ Δ

See Item List



LTW12D- Δ BMMA-SL8001

See Item List

Accessories



See Item List

D-Coded Sensor Connector (5A) : Molded with Cable (Female)

LTW12D-²BFFM-S⁸8¹⁰11

New Product



Material

Pin : Copper Alloy, 6u" Gold Plated
 Connector Body : PU, UL Recognized
 Cable Temperature : -25 °C to 90 °C (PU)
 : -20 °C to 80 °C (PVC)

Specifications

DESCRIPTION	DETAILS	CODE
1 Connector Size	M12 D-Coded	12D
² Number of Contacts	4 to 5	04 to 05
3 Connector Type	Without SR	B
4 Connector Gender	Female	F
5 Contact Gender	Female	F
6 Assembly Style	Molded with Cable	M
7 Mating Style	Screw	S
⁸ Backshell	Straight or Right	L or R
9 Waterproof Rating	IP68	8
¹⁰ Standard Cable	UL2464 or PU	A or B
¹¹ Cable Length (L)	1 to 99	01,...,99

SR= Strain Relief

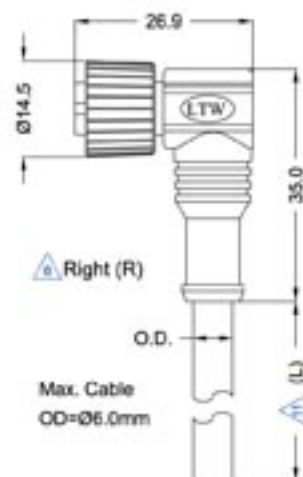
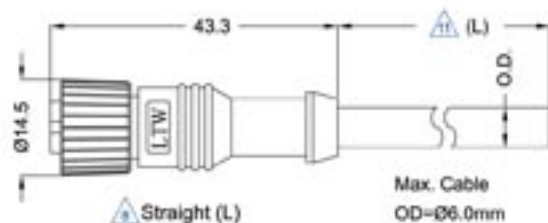

Pin Configurations



04 pins



05 pins

¹⁰ LTW Standard Cable:

No. of Pins	Part no.	Type	Color	OD(mm)
04	WCA0571UV01	PVC	Black	5.0
	WCA00010062	PU	Black	4.8
05	WCA0521UV01	PVC	Black	5.5
	WCA00010061	PU	Black	5.0

Note: Please see Cable Index for further details

Mating Parts



LTW12D-²PMMS-SH8001
See Item List



LTW12D-²PMM-⁸SF8001
See Item List



LTW12D-²BMMA-SL8001
See Item List



LTW12D-²BMMM-S⁸8¹⁰11
See Item List

Accessories



See Item List

D-Coded Sensor Connector (5A) : Molded with Cable (Male)

LTW12D- Δ 2BMMM-S Δ 8 Δ 8 Δ 10 Δ 11

New Product



Material

Pin : Copper Alloy, 6u" Gold Plated
 Connector Body : PU, UL Recognized
 Cable Temperature : -25 °C to 90 °C (PU)
 : -20 °C to 80 °C (PVC)

Specifications

DESCRIPTION	DETAILS	CODE
1 Connector Size	M12 D-Coded	12D
Δ 2 Number of Contacts	4 to 5	04 to 05
3 Connector Type	Without SR	B
4 Connector Gender	Male	M
5 Contact Gender	Male	M
6 Assembly Style	Molded with Cable	M
7 Mating Style	Screw	S
Δ 8 Backshell	Straight or Right	L or R
9 Waterproof Rating	IP68	8
Δ 10 Standard Cable	UL2464 or PU	A or B
Δ 11 Cable Length (L)	1 to 99	01,...,99

SR= Strain Relief

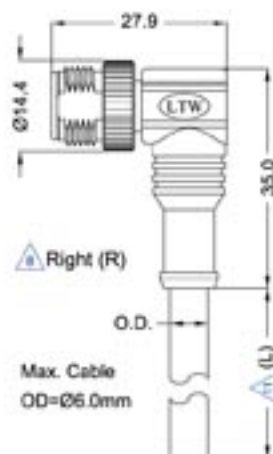
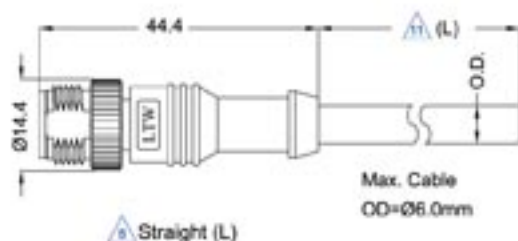

Pin Configurations



Δ 10 LTW Standard Cable:

No. of Pins	Part no.	Type	Color	OD(mm)
04	WCA0571UV01	PVC	Black	5.0
	WCA00010062	PU	Black	4.8
05	WCA0521UV01	PVC	Black	5.5
	WCA00010061	PU	Black	5.0

Note: Please see Cable Index for further details

Mating Parts



Accessories



See Item List

Plastic D-Coded Sensor Connector (5A) : Molded with Cable (Female)

LTWSDP-²BFFM-S⁸8¹⁰¹¹

New Product



Material

Pin : Copper Alloy, 6u" Gold Plated
 Connector Body : PU, UL Recognized
 Cable Temperature : -25 °C to 90 °C (PU)
 : -20 °C to 80 °C (PVC)

Specifications

DESCRIPTION	DETAILS	CODE
1 Connector Size	M12 D-Coded (Plastic)	SDP
² Number of Contacts	4 to 5	04 to 05
3 Connector Type	Without SR	B
4 Connector Gender	Female	F
5 Contact Gender	Female	F
6 Assembly Style	Molded with Cable	M
7 Mating Style	Screw	S
⁸ Backshell	Straight or Right	L or R
9 Waterproof Rating	IP68	8
¹⁰ Standard Cable	UL2464 or PU	A or B
¹¹ Cable Length (L)	1 to 99	01,...,99

SR= Strain Relief

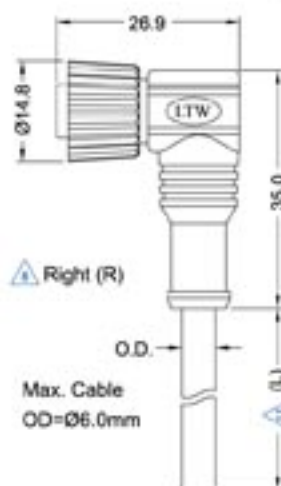
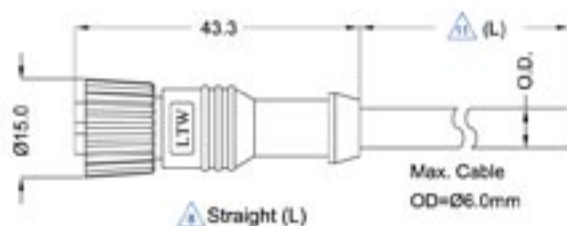

Pin Configurations



04 pins



05 pins

¹⁰ LTW Standard Cable:

No. of Pins	Part no.	Type	Color	OD(mm)
04	WCA0571UV01	PVC	Black	5.0
	WCA00010062	PU	Black	4.8
05	WCA0521UV01	PVC	Black	5.5
	WCA00010061	PU	Black	5.0

Note: Please see Cable Index for further details

Mating Parts



LTWSDP-²BMMM-S⁸8¹⁰¹¹
See Item List



LTWSDP-²BMMA-SL8001
See Item List



See Item List

Accessory

Plastic D-Coded Sensor Connector (5A) : Molded with Cable (Male)

LTWSDP-²BMMM-S⁸8¹⁰¹¹

New Product



Material

Pin : Copper Alloy, 6u" Gold Plated
 Connector Body : PU, UL Recognized
 Cable Temperature : -25 °C to 90 °C (PU)
 : -20 °C to 80 °C (PVC)

Specifications

DESCRIPTION	DETAILS	CODE
1 Connector Size	M12 D-Coded (Plastic)	SDP
² Number of Contacts	4 to 5	04 to 05
3 Connector Type	Without SR	B
4 Connector Gender	Male	M
5 Contact Gender	Male	M
6 Assembly Style	Molded with Cable	M
7 Mating Style	Screw	S
⁸ Backshell	Straight or Right	L to R
9 Waterproof Rating	IP68	8
¹⁰ Standard Cable	UL2464 or PU	A or B
¹¹ Cable Length (L)	1 to 99 meters	01,...,99

SR = Strain Relief

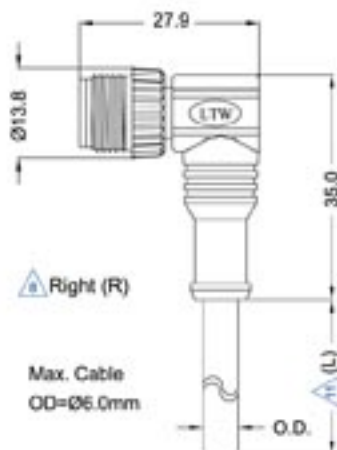
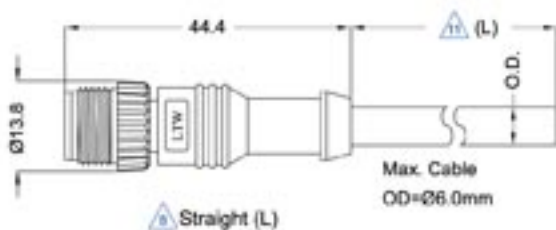

Pin Configurations



04 pins



05 pins

¹⁰ LTW Standard Cable:

No. of Pins	Part no.	Type	Color	OD(mm)
04	WCA0571UV01	PVC	Black	5.0
	WCA00010062	PU	Black	4.8
05	WCA0521UV01	PVC	Black	5.5
	WCA00010061	PU	Black	5.0

Note: Please see Cable Index for further details

Mating Parts



LTWSDP-²BFFM-S⁸8¹⁰¹¹
See Item List



LTWSDP-²BFFA-SL8001
See Item List



See Item List

Accessory

D-Coded Sensor Connector (5A) : Field Installable (Female)

LTW12D- BFFA-SL8001

New Product



Specifications

DESCRIPTION	DETAILS	CODE
1 Connector Size	M12 D-Coded	12D
 Number of Contacts	4 to 5	04 to 05
3 Connector Type	Without SR	B
4 Connector Gender	Female	F
5 Contact Gender	Female	F
6 Assembly Style	Field Installable (Solder Pin)	A
7 Mating Style	Screw	S
8 Backshell	Straight	L
9 Waterproof Rating	IP68	8
10 Version	Without Cable	001

Material

Pin : Copper Alloy, 6u" Gold Plated
 Connector Body : Nylon + GF, UL Recognized
 Temperature Range : -25 °C to 90 °C

SR= Strain Relief

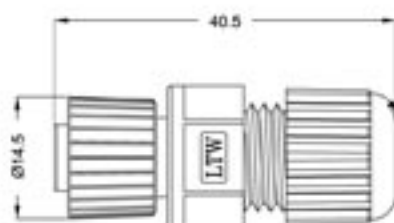

Seals for Cable OD: Ø4.5mm-Ø6.5mm

Pin Configurations



04 pins



05 pins

Mating Parts



LTW12D- PMMS-SH8001

See Item List



LTW12D- BMMA-SL8001

See Item List



LTW12D- PMM- SF8001

See Item List



LTW12D- BMMM-S- 8-

See Item List

Accessories



See Item List

Sensor D-Code

D-Coded Sensor Connector (5A) : Field Installable (Male)

LTW12D- BMMA-SL8001

New Product



Specifications

DESCRIPTION	DETAILS	CODE
1 Connector Size	M12 D-Coded	12D
 Number of Contacts	4 to 5	04 to 05
3 Connector Type	Without SR	B
4 Connector Gender	Male	M
5 Contact Gender	Male	M
6 Assembly Style	Field Installable (Solder Pin)	A
7 Mating Style	Screw	S
8 Backshell	Straight	L
9 Waterproof Rating	IP68	8
10 Version	Without Cable	001

Material

Pin : Copper Alloy, 6u" Gold Plated
 Connector Body : Nylon + GF, UL Recognized
 Temperature Range : -25 °C to 90 °C

SR= Strain Relief

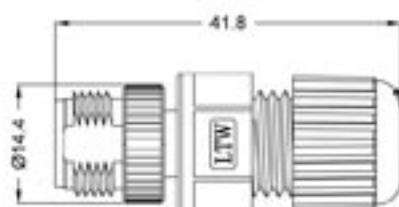

Seals for Cable OD: $\varnothing 4.5\text{mm}$ ~ $\varnothing 6.5\text{mm}$

Pin Configurations



04 pins



05 pins

Mating Parts



LTW12D- PFFS-SH8001
See Item List



LTW12D- BFFA-SL8001
See Item List



LTW12D- PFF- SF8001
See Item List



LTW12D- BFFM-S- 8- 8- 8
See Item List

Accessories



See Item List

Plastic D-Coded Sensor Connector (5A) : Field Installable (Female)

LTWSDP-2 BFFA-SL8001

New Product



Specifications

DESCRIPTION	DETAILS	CODE
1 Connector Size	M12 D-Coded Plastic	SDP
 Number of Contacts	4 to 5	04 to 05
3 Connector Type	Without SR	B
4 Connector Gender	Female	F
5 Contact Gender	Female	F
6 Assembly Style	Field Installable (Solder Pin)	A
7 Mating Style	Screw	S
8 Backshell	Straight	L
9 Waterproof Rating	IP68	8
10 Version	Without Cable	001

Material

Pin : Copper Alloy, 6u" Gold Plated
 Connector Body : Nylon + GF, UL Recognized
 Temperature Range : -25 °C to 90 °C

SR= Strain Relief

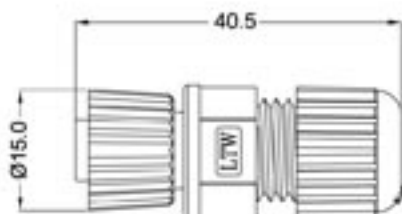

Seals for Cable OD: Ø4.5mm-Ø6.5mm

Pin Configurations



04 pins



05 pins

Mating Parts



LTWSDP-8 BMMM-S
See Item List



LTWSDP-8 BMMA-SL8001
See Item List

Accessory



See Item List

Plastic D-Coded Sensor Connector (5A) : Field Installable (Male)

LTWSDP- \triangle ₂BMMA-SL8001

New Product



Specifications

DESCRIPTION	DETAILS	CODE
1 Connector Size	M12 D-Coded Plastic	SDP
\triangle 2 Number of Contacts	4 to 5	04 to 05
3 Connector Type	Without SR	B
4 Connector Gender	Male	M
5 Contact Gender	Male	M
6 Assembly Style	Field Installable (Solder Pin)	A
7 Mating Style	Screw	S
8 Backshell	Straight	L
9 Waterproof Rating	IP68	8
10 Version	Without Cable	001

Material

Pin : Copper Alloy, 6u" Gold Plated
 Connector Body : Nylon + GF, UL Recognized
 Temperature Range : -25 °C to 90 °C

SR= Strain Relief

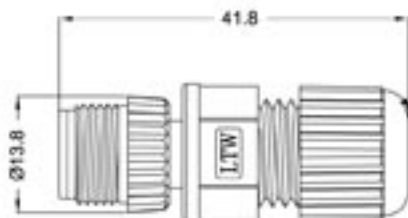

Seals for Cable OD: \varnothing 4.5mm- \varnothing 6.5mm

Pin Configurations



04 pins



05 pins

Mating Parts



LTWSDP- \triangle ₂BFFM-S \triangle ₈ \triangle ₈ \triangle ₈

See Item List



LTWSDP- \triangle ₂BFFA-SL8001

See Item List

Accessory



See Item List