



SENSOR Connector

1. Specifications	164
2. How to Order	165
3. Contact Pin Arrangement	166
4. Item List	
Sensor M8(5A) - M105(2A) for Panel, Molded with Cable	167
Sensor M12(2A & 5A) for Panel, Molded with Cable, Field Installable	177
Sensor M12 B-Code(5A) for Panel, Molded with Cable, Field Installable	193
Sensor M12 D-Code(5A) for Panel, Molded with Cable, Field Installable	206
Sensor M12 I-Style(5A) for Panel, Molded with Cable, Field Installable	219



SPECIFICATIONS

SENSOR SERIES

No.	SPECIFICATIONS	STANDARD VALUE
01	Manufacturer Identifications	M8, M10.5, M12, M12 B-Coded, M12 D-Coded, M12 I-Style
02	Description	Panel Mount, Molded with Cable and Field Installable
03	Current Rating	M8: 5A M10.5: 2A M12: 2A, 5A M12 B-Coded: 5A M12 D-Coded: 5A M12 I-Style: 5A
04	Pin Configuration	M8: 3 to 4 Contacts M10.5: 2 to 5 Contacts M12: 3 to 5, 8 Contacts M12 B-Coded: 4 to 5 Contacts M12 D-Coded: 4 to 5 Contacts M12 I-Style: 5 Contacts
05	Material	Contacts: Copper Alloy, Gold Plated Connector Body: Nylon + GF or PU, UL Recognized Shield: Zinc Alloy or Copper Alloy, Nickel Plated
06	Temperature Range	Cable: -25°C to +90°C (PU), -20°C to +80°C (PVC) Connector Body: -25°C to +90°C
07	Waterproof Rating	IP65, IP66, IP67, IP68
08	Contact Resistance	≤ 10 mΩ
09	Insulation Resistance	≥ 100MΩ at DC 500V
10	Breakdown Voltage	≥ AC 500V/1 Minute

HOW TO ORDER

SENSOR CONNECTOR

LTW 1 - 2 3 4 5 6 - 7 8 9 10 11

LT : Liang Tei

W : Waterproof













1	Connector Size	<ul style="list-style-type: none"> <li style="margin-bottom: 5px;">M8 8 <li style="margin-bottom: 5px;">M8 Plastic 8P <li style="margin-bottom: 5px;">M10.5 105 <li style="margin-bottom: 5px;">M12, M12 (I-Style) 12 <li style="margin-bottom: 5px;">M12 LED 12L <li style="margin-bottom: 5px;">M12 Plastic, M12 I-Style Plastic 12P <li style="margin-bottom: 5px;">M12 Shielded 12S <li style="margin-bottom: 5px;">M12 B-Coded 12B 	<ul style="list-style-type: none"> <li style="margin-bottom: 5px;">M12 B-Coded LED SBL <li style="margin-bottom: 5px;">M12 B-Coded Plastic SBP <li style="margin-bottom: 5px;">M12 B-Coded Shielded SBS <li style="margin-bottom: 5px;">M12 D-Coded 12D <li style="margin-bottom: 5px;">M12 D-Coded LED SDL <li style="margin-bottom: 5px;">M12 D-Coded Plastic SDP <li style="margin-bottom: 5px;">M12 D-Coded Shielded SDS
2	Number of Contacts	02, 03, ..., 08	
3	Connector Type	<ul style="list-style-type: none"> <li style="margin-bottom: 5px;">Panel P <li style="margin-bottom: 5px;">With SR A <li style="margin-bottom: 5px;">Without SR B 	
4	Connector Gender	<ul style="list-style-type: none"> <li style="margin-bottom: 5px;">Male M <li style="margin-bottom: 5px;">Female F 	
5	Contact Gender	<ul style="list-style-type: none"> <li style="margin-bottom: 5px;">Male M <li style="margin-bottom: 5px;">Female F <li style="margin-bottom: 5px;">I-Style I 	
6	Assembly Style	<ul style="list-style-type: none"> <li style="margin-bottom: 5px;">PCB 180° P <li style="margin-bottom: 5px;">PCB 90° R <li style="margin-bottom: 5px;">Solder S <li style="margin-bottom: 5px;">Molded with Cable M <li style="margin-bottom: 5px;">Field Installable (Solder Pins) A <li style="margin-bottom: 5px;">Field Installable (Screw Pins) B <li style="margin-bottom: 5px;">Field Installable (IDC Pins) C 	
7	Mating Style	<ul style="list-style-type: none"> <li style="margin-bottom: 5px;">Lock L <li style="margin-bottom: 5px;">Screw S <li style="margin-bottom: 5px;">Quick Q 	
8	Backshell	<ul style="list-style-type: none"> <li style="margin-bottom: 5px;">Circular C <li style="margin-bottom: 5px;">Front Mount Hexagonal Flange F <li style="margin-bottom: 5px;">Rear Mount Hexagonal Flange H <li style="margin-bottom: 5px;">Straight L <li style="margin-bottom: 5px;">Right R 	
9	Waterproof Rating	<ul style="list-style-type: none"> <li style="margin-bottom: 5px;">IP66 6 <li style="margin-bottom: 5px;">IP67 7 <li style="margin-bottom: 5px;">IP68 8 	
10	Version	Without Cable 001,...	
or 10	Standard Cable	<ul style="list-style-type: none"> <li style="margin-bottom: 5px;">UL2464 PVC Jacket A <li style="margin-bottom: 5px;">PU B 	
11	Cable Length (L)	01 to 99 meters 01...99	

CONTACT PIN ARRANGEMENTS

SENSOR CONNECTOR

SENSOR

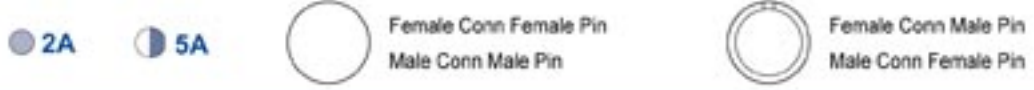
M8	3 Contact	4 Contact		
				
M10.5	2 Contact	3 Contact	4 Contact	5 Contact
				
M12	3 Contact	4 Contact	5 Contact	8 Contact
				
				

SENSOR CONNECTOR: M12 B-CODE

Current Rating	Item Number	Number of Contacts	DESCRIPTION	Page	Old Item Number
5A	Panel				
	LTW12B-PMMS-SH8001	04 to 05	B-Code. Rear Mount. Solder. Male Connector. Hexagonal Backshell.	194	New Product
	LTW12B-PFFS-SH8001	04 to 05	B-Code. Rear Mount. Solder. Female Connector. Hexagonal Backshell.	195	New Product
	LTW12B-PMM-SF8001	04 to 05	B-Code. Front Mount. PCB 180° or Solder. Male Connector. Hexagonal Backshell.	196	New Product
	LTW12B-PFF-SF8001	04 to 05	B-Code. Front Mount. PCB 180° or Solder. Female Connector. Hexagonal Backshell.	197	New Product
	Molded with Cable				
	LTW12B-BFFM-S8888	04 to 05	B-Code. Without SR. Molded with Cable. Female Connector. Straight or Right.	198	New Product
	LTW12B-BMMM-S8888	04 to 05	B-Code. Without SR. Molded with Cable. Male Connector. Straight or Right.	199	New Product
	LTWSBP-BFFM-S8888	04 to 05	B-Code Plastic. Without SR. Molded with Cable. Female Connector. Straight or Right.	200	New Product
	LTWSBP-BMMM-S8888	04 to 05	B-Code Plastic. Without SR. Molded with Cable. Male Connector. Straight or Right.	201	New Product
	Field Installable				
	LTW12B-BFFA-SL8001	04 to 05	B-Code. Without SR. Solder or Screw Pins. Female Connector. Straight.	202	New Product
	LTW12B-BMMA-SL8001	04 to 05	B-Code. Without SR. Solder or Screw Pins. Male Connector. Straight.	203	New Product
	LTWSBP-BFFA-SL8001	04 to 05	B-Code Plastic. Without SR. Solder or Screw Pins. Female Connector. Straight.	204	New Product
	LTWSBP-BMMA-SL8001	04 to 05	B-Code Plastic. Without SR. Solder or Screw Pins. Male Connector. Straight.	205	New Product

B-Coded Sensor Connector (5A) : Panel Mount (Male)

LTW12B- Δ 2 PMMS-SH8001

New Product



Material

Pin : Copper Alloy, 6u" Gold Plated
 Connector Body : Nylon + GF, UL Recognized
 Shield : Zn Alloy or Copper Alloy, Nickel Plated
 Temperature Range : -25 °C to 90 °C

Specifications

DESCRIPTION	DETAILS	CODE
1 Connector Size	M12 B-Coded	12B
Δ 2 Number of Contacts	4 to 5	04 to 05
3 Connector Type	Panel	P
4 Connector Gender	Male	M
5 Contact Gender	Male	M
6 Assembly Style	Solder	S
7 Mating Style	Screw	S
8 Backshell	Hexagonal Rear Mount	H
9 Waterproof Rating	IP68	8
10 Version	Without Cable	001

Recommended Panel Cut-Out

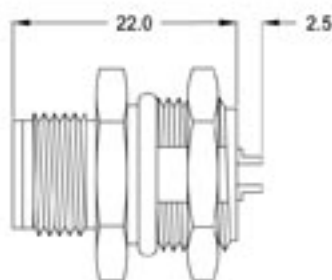
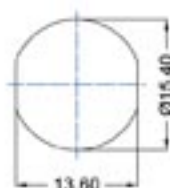

*Waterproof Rating: IP68 (unmated)

Pin Configurations



04 pins



05 pins

Mating Parts



LTW12B- Δ BFFM-S Δ 8 Δ Δ

See Item List



LTW12B- Δ BFFA-SL8001

See Item List

Accessories



See Item List

B-Coded Sensor Connector (5A) : Panel Mount (Female)

LTW12B- \triangle 2 PFFS-SH8001

New Product



Material

Pin : Copper Alloy, 6u" Gold Plated
 Connector Body : Nylon + GF, UL Recognized
 Shield : Zn Alloy or Copper Alloy, Nickel Plated
 Temperature Range : -25 °C to 90 °C

Specifications

DESCRIPTION	DETAILS	CODE
1 Connector Size	M12 B-Coded	12B
\triangle Number of Contacts	4 to 5	04 to 05
3 Connector Type	Panel	P
4 Connector Gender	Female	F
5 Contact Gender	Female	F
6 Assembly Style	Solder	S
7 Mating Style	Screw	S
8 Backshell	Hexagonal Rear Mount	H
9 Waterproof Rating	IP68	8
10 Version	Without Cable	001

Recommended Panel Cut-Out

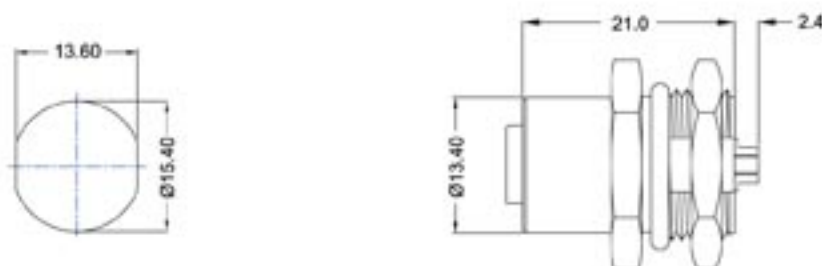

*Waterproof Rating: IP68 (unmated)

Pin Configurations



04 pins



05 pins

Mating Parts



LTW12B- \triangle BMMM-S \triangle 8 \triangle \triangle

See Item List



LTW12B- \triangle BMMA-SL8001

See Item List

Accessories



See Item List

B-Coded Sensor Connector (5A) : Panel Mount (Male)

LTW12B- \triangle 2 PMM \triangle 6-SF8001

New Product



Specifications

DESCRIPTION	DETAILS	CODE
1 Connector Size	M12 B-Coded	12B
\triangle 2 Number of Contacts	4 to 5	04 to 05
3 Connector Type	Panel	P
4 Connector Gender	Male	M
5 Contact Gender	Male	M
\triangle 6 Assembly Style	PCB 180° or Solder	P or S
7 Mating Style	Screw	S
8 Backshell	Hexagonal Front Mount	F
9 Waterproof Rating	IP68	8
10 Version	Without Cable	001

Material

Pin : Copper Alloy, 6u" Gold Plated
 Connector Body : Nylon + GF, UL Recognized
 Shield : Zn Alloy or Copper Alloy, Nickel Plated
 Temperature Range : -25 °C to 90 °C

Recommended Panel Cut-Out

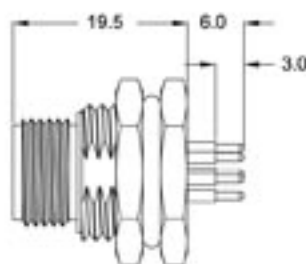
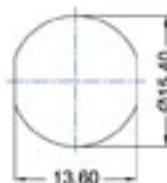

\triangle 6 PCB (P)

*Waterproof Rating: IP68 (unmated)

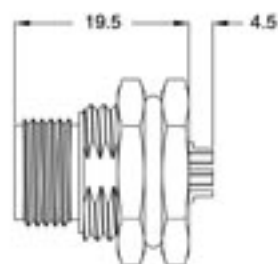

\triangle 6 Solder (S)

*Waterproof Rating: IP68 (unmated)

Pin Configurations and PCB Layouts



04 pins

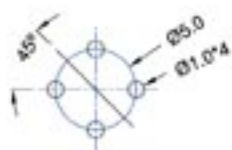

05 pins

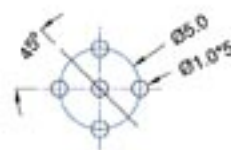

Mating Parts



LTW12B- \triangle BFFM-S \triangle 8 \triangle \triangle

See Item List



LTW12B- \triangle BFFA-SL8001

See Item List

Accessories



See Item List

B-Coded Sensor Connector (5A) : Panel Mount (Female)

LTW12B- \triangle 2 PFF \triangle 6-SF8001

New Product



Material

Pin : Copper Alloy, 6u" Gold Plated
 Connector Body : Nylon + GF, UL Recognized
 Shield : Zn Alloy or Copper Alloy, Nickel Plated
 Temperature Range : -25 °C to 90 °C

Specifications

DESCRIPTION	DETAILS	CODE
1 Connector Size	M12 B-Coded	12B
\triangle Number of Contacts	4 to 5	04 to 05
3 Connector Type	Panel	P
4 Connector Gender	Female	F
5 Contact Gender	Female	F
\triangle Assembly Style	PCB 180° or Solder	P or S
7 Mating Style	Screw	S
8 Backshell	Hexagonal Front Mount	F
9 Waterproof Rating	IP68	8
10 Version	Without Cable	001

Recommended Panel Cut-Out

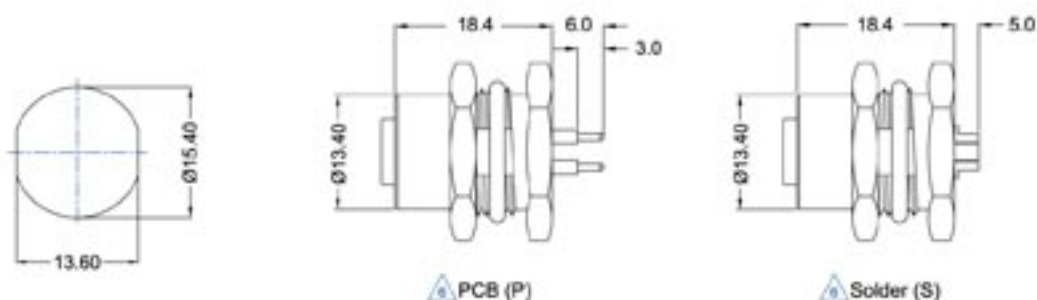

*Waterproof Rating: IP68 (unmated)

*Waterproof Rating: IP68 (unmated)

Pin Configurations and PCB Layouts

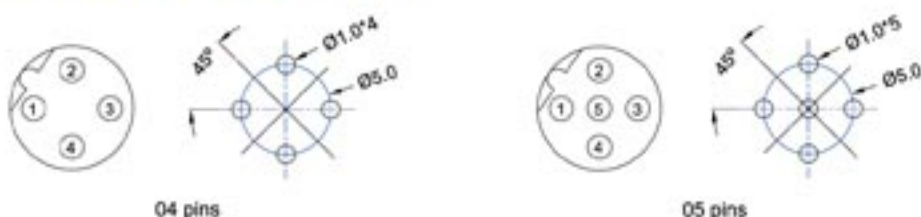

04 pins

05 pins

Mating Parts



LTW12B- \triangle BMMM-S \triangle 8 \triangle \triangle \triangle

See Item List



LTW12B- \triangle BMMA-SL8001

See Item List

Accessories



See Item List

Sensor B-Code

B-Coded Sensor Connector (5A) : Molded with Cable (Female)

LTW12B-²BFFM-S⁸8¹⁰11

New Product



Material

Pin : Copper Alloy, 6u" Gold Plated
 Connector Body : PU, UL Recognized
 Cable Temperature : -25 °C to 90 °C (PU)
 : -20 °C to 80 °C (PVC)

Specifications

DESCRIPTION	DETAILS	CODE
1 Connector Size	M12 B-Coded	12B
² Number of Contacts	4 to 5	04 to 05
3 Connector Type	Without SR	B
4 Connector Gender	Female	F
5 Contact Gender	Female	F
6 Assembly Style	Molded with Cable	M
7 Mating Style	Screw	S
⁸ Backshell	Straight or Right	L or R
9 Waterproof Rating	IP68	8
¹⁰ Standard Cable	UL2464 or PU	A or B
¹¹ Cable Length (L)	1 to 99	01,...,99

SR= Strain Relief

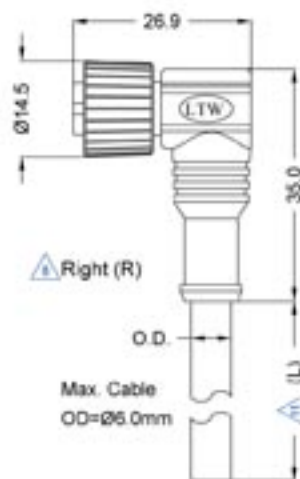
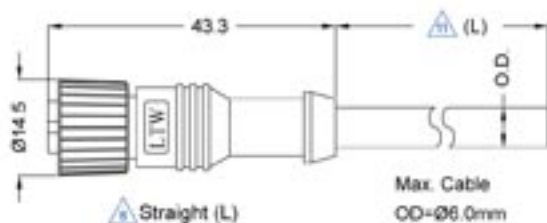

Pin Configurations



04 pins



05 pins

¹⁰ LTW Standard Cable:

No. of Pins	Part no.	Type	Color	OD(mm)
04	WCA0571UV01	PVC	Black	5.0
	WCA00010062	PU	Black	4.8
05	WCA0521UV01	PVC	Black	5.5
	WCA00010061	PU	Black	5.0

Note: Please see Cable Index for further details

Mating Parts



LTW12B-²PMMS-SH8001

See Item List



LTW12B-²BMMA-SL8001

See Item List



LTW12B-²PMM-SF8001

See Item List



LTW12B-²BMMM-S⁸¹⁰¹¹

See Item List

Accessories



See Item List

B-Coded Sensor Connector (5A) : Molded with Cable (Male)

LTW12B- Δ 2 BMMM-S Δ 8 Δ 8 Δ 10 Δ 11

New Product



Specifications

DESCRIPTION	DETAILS	CODE
1 Connector Size	M12 B-Coded	12B
Δ Number of Contacts	4 to 5	04 to 05
3 Connector Type	Without SR	B
4 Connector Gender	Male	M
5 Contact Gender	Male	M
6 Assembly Style	Molded with Cable	M
7 Mating Style	Screw	S
Δ Backshell	Straight or Right	L or R
9 Waterproof Rating	IP68	8
Δ Standard Cable	UL2464 or PU	A or B
Δ Cable Length (L)	1 to 99	01,...,99

SR= Strain Relief

Material

Pin : Copper Alloy, 6u" Gold Plated
 Connector Body : PU, UL Recognized
 Cable Temperature : -25 °C to 90 °C (PU)
 : -20 °C to 80 °C (PVC)

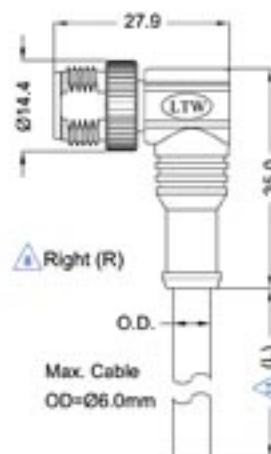
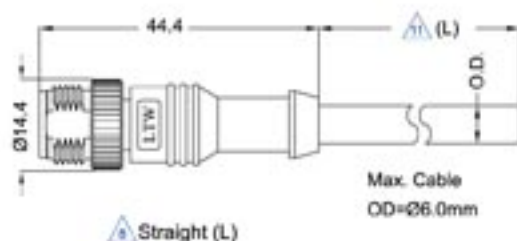

Pin Configurations



04 pins



05 pins

Δ 10 LTW Standard Cable:

No. of Pins	Part no.	Type	Color	OD(mm)
04	WCA0571UV01	PVC	Black	5.0
	WCA00010062	PU	Black	4.8
05	WCA0521UV01	PVC	Black	5.5
	WCA00010061	PU	Black	5.0

Note: Please see Cable Index for further details

Mating Parts



LTW12B- Δ PFFS-SH8001
See Item List



LTW12B- Δ BFFA-SL8001
See Item List



LTW12B- Δ PFF Δ -SF8001
See Item List



LTW12B- Δ BFFM-S Δ 8 Δ 8 Δ 10 Δ 11
See Item List

Accessories



See Item List

Plastic B-Coded Sensor Connector (5A) : Molded with Cable (Female)

LTWSBP-²BFFM-S⁸8¹⁰11

New Product



Specifications

DESCRIPTION	DETAILS	CODE
1 Connector Size	M12 B-Coded (Plastic)	SBP
² Number of Contacts	4 to 5	04 to 05
3 Connector Type	Without SR	B
4 Connector Gender	Female	F
5 Contact Gender	Female	F
6 Assembly Style	Molded with Cable	M
7 Mating Style	Screw	S
⁸ Backshell	Straight or Right	L or R
9 Waterproof Rating	IP68	8
¹⁰ Standard Cable	UL2464 or PU	A or B
¹¹ Cable Length (L)	1 to 99	01,...,99

SR= Strain Relief

Material

Pin : Copper Alloy, 6u" Gold Plated
 Connector Body : PU, UL Recognized
 Cable Temperature : -25 °C to 90 °C (PU)
 : -20 °C to 80 °C (PVC)

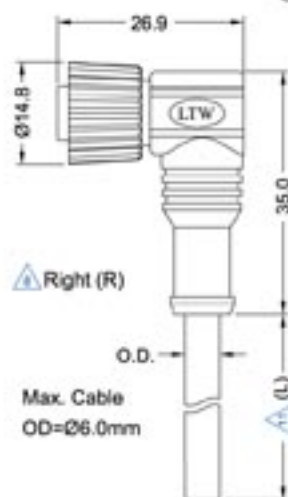
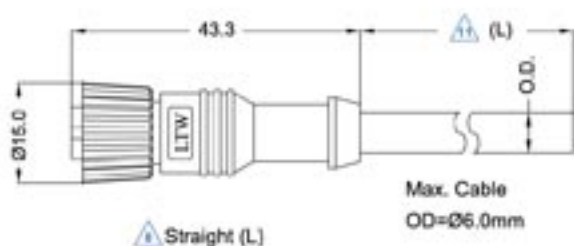

Pin Configurations



04 pins



05 pins

¹⁰ LTW Standard Cable:

No. of Pins	Part no.	Type	Color	OD(mm)
04	WCA0571UV01	PVC	Black	5.0
	WCA00010062	PU	Black	4.8
05	WCA0521UV01	PVC	Black	5.5
	WCA00010061	PU	Black	5.0

Note: Please see Cable Index for further details

Mating Parts



LTWSBP-²BMMM-S⁸8¹⁰11

See Item List



LTWSBP-²BMMA-SL8001

See Item List



See Item List

Accessory

Plastic B-Coded Sensor Connector (5A) : Molded with Cable (Male)

LTWSBP-²BMMM-S⁸8¹⁰¹¹

New Product



Material

Pin : Copper Alloy, 6u" Gold Plated
 Connector Body : PU, UL Recognized
 Cable Temperature : -25 °C to 90 °C (PU)
 : -20 °C to 80 °C (PVC)

Specifications

DESCRIPTION	DETAILS	CODE
1 Connector Size	M12 B-Coded (Plastic)	SBP
² Number of Contacts	4 to 5	04 to 05
3 Connector Type	Without SR	B
4 Connector Gender	Male	M
5 Contact Gender	Male	M
6 Assembly Style	Molded with Cable	M
7 Mating Style	Screw	S
⁸ Backshell	Straight or Right	L or R
9 Waterproof Rating	IP68	8
¹⁰ Standard Cable	UL2464 or PU	A or B
¹¹ Cable Length (L)	1 to 99 meters	01,...,99

SR = Strain Relief

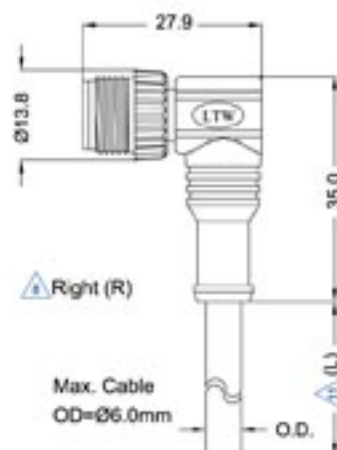
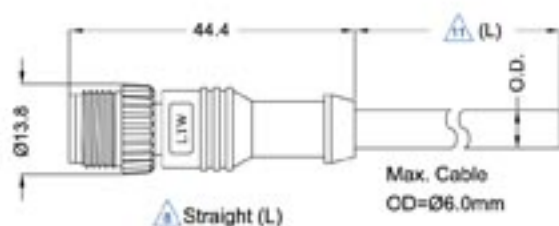

Pin Configurations



04 pins



05 pins

¹⁰ LTW Standard Cable:

No. of Pins	Part no.	Type	Color	OD(mm)
04	WCA0571UV01	PVC	Black	5.0
	WCA00010062	PU	Black	4.8
05	WCA0521UV01	PVC	Black	5.5
	WCA00010061	PU	Black	5.0

Note: Please see Cable Index for further details

Mating Parts



LTWSBP-²BFFM-S⁸8¹⁰¹¹

See Item List



LTWSBP-²BFFA-SL8001

See Item List



See Item List

Accessory

B-Coded Sensor Connector (5A) : Field Installable (Female)

LTW12B- Δ 2 BFFA-SL8001

New Product



Specifications

DESCRIPTION	DETAILS	CODE
1 Connector Size	M12 B-Coded	12B
Δ 2 Number of Contacts	4 to 5	04 to 05
3 Connector Type	Without SR	B
4 Connector Gender	Female	F
5 Contact Gender	Female	F
6 Assembly Style	Field Installable (Solder Pin)	A
7 Mating Style	Screw	S
8 Backshell	Straight	L
9 Waterproof Rating	IP68	8
10 Version	Without Cable	001

Material

Pin : Copper Alloy, 6u" Gold Plated
 Connector Body : Nylon + GF, UL Recognized
 Temperature Range : -25 °C to 90 °C

SR= Strain Relief

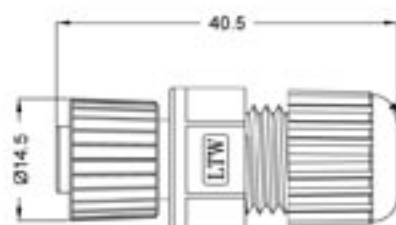

Seals for Cable OD: \varnothing 4.5mm- \varnothing 6.5mm

Pin Configurations



04 pins



05 pins

Mating Parts



LLTW12B- Δ PMMS-SH8001
 See Item List



LTW12B- Δ PMM Δ -SF8001
 See Item List



LTW12B- Δ BMMA-SL8001
 See Item List



LTW12B- Δ BMMM-S Δ 8 Δ Δ Δ
 See Item List

Accessories



See Item List

B-Coded Sensor Connector (5A) : Field Installable (Male)

LTW12B- Δ 2 BMMA-SL8001

New Product



Specifications

DESCRIPTION	DETAILS	CODE
1 Connector Size	M12 B-Coded	12B
Δ Number of Contacts	4 to 5	04 to 05
3 Connector Type	Without SR	B
4 Connector Gender	Male	M
5 Contact Gender	Male	M
6 Assembly Style	Field Installable (Solder Pin)	A
7 Mating Style	Screw	S
8 Backshell	Straight	L
9 Waterproof Rating	IP68	8
10 Version	Without Cable	001

Material

Pin : Copper Alloy, 6u" Gold Plated
 Connector Body : Nylon + GF, UL Recognized
 Temperature Range : -25 °C to 90 °C

SR= Strain Relief

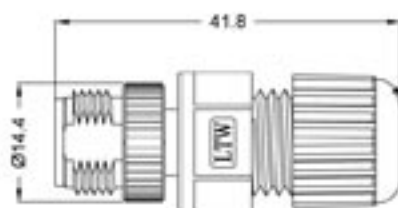

Seals for Cable OD: \varnothing 4.5mm- \varnothing 6.5mm

Pin Configurations



04 pins



05 pins

Mating Parts



LTW12B- Δ PFFS-SH8001
See Item List



LTW12B- Δ BFFA-SL8001
See Item List



LTW12B- Δ PFF- Δ SF8001
See Item List



LTW12B- Δ BFFM-S- Δ 8- Δ
See Item List

Accessories



See Item List

Plastic B-Coded Sensor Connector (5A) : Field Installable (Female)

LTWSBP-²BFFA-SL8001

New Product



Specifications

DESCRIPTION	DETAILS	CODE
1 Connector Size	M12 B-Coded Plastic	SBP
² Number of Contacts	4 to 5	04 to 05
3 Connector Type	Without SR	B
4 Connector Gender	Female	F
5 Contact Gender	Female	F
6 Assembly Style	Field Installable (Solder Pin)	A
7 Mating Style	Screw	S
8 Backshell	Straight	L
9 Waterproof Rating	IP68	8
10 Version	Without Cable	001

Material

Pin : Copper Alloy, 6u" Gold Plated
 Connector Body : Nylon + GF, UL Recognized
 Temperature Range : -25 °C to 90 °C

SR= Strain Relief

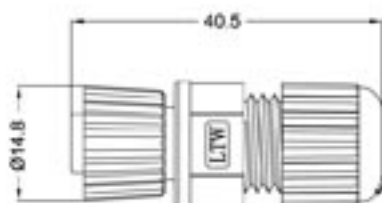

Seals for Cable OD: Ø4.5mm~Ø6.5mm

Pin Configurations



04 pins



05 pins

Mating Parts



LTWSBP-²BMMM-S²³⁴⁵⁶⁷⁸⁹¹⁰

See Item List



LTWSBP-²BMMA-SL8001

See Item List

Accessory



See Item List

Plastic B-Coded Sensor Connector (5A) : Field Installable (Male)

LTWSBP-[△]₂BMMA-SL8001

New Product



Specifications

DESCRIPTION	DETAILS	CODE
1 Connector Size	M12 B-Coded Plastic	SBP
[△] Number of Contacts	4 to 5	04 to 05
3 Connector Type	Without SR	B
4 Connector Gender	Male	M
5 Contact Gender	Male	M
6 Assembly Style	Field Installable (Solder Pin)	A
7 Mating Style	Screw	S
8 Backshell	Straight	L
9 Waterproof Rating	IP68	8
10 Version	Without Cable	001

Material

Pin : Copper Alloy, 6u" Gold Plated
 Connector Body : Nylon + GF, UL Recognized
 Temperature Range : -25 °C to 90 °C

SR= Strain Relief

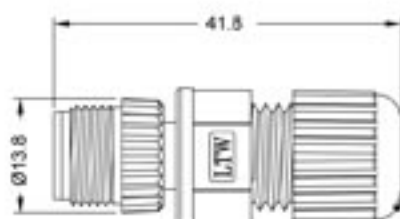

Seals for Cable OD: Ø4.5mm-Ø6.5mm

Pin Configurations



04 pins



05 pins

Mating Parts



LTWSBP-[△]₂BFFM-S[△]₆[△]₈[△]₁₁

See Item List



LTWSBP-[△]₂BFFA-SL8001

See Item List

Accessory



See Item List