

Vent Connector



## CATALOGUE

# Vent Connector



## Range Overview

## Ordering Information

### Receptacle

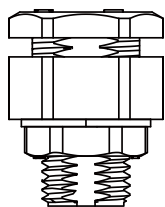

M12\*1.25

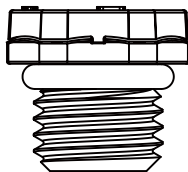

M12\*1.5

1 - 2 3

#### Specification

(VENT) Vent

#### Type

(BD) M12 x 1.25 (BJ) M12 x 1.5

#### More Information

(001), (002)

## Specification

Identifications	M12 Vent Connector
Material	PBT+PC (M12 x 1.25) / M-PPE (M12 x 1.5)
Waterproof Rating	IP67 (M12 x 1.25) / IP69K (M12 x 1.5)
Temperature Range	Receptacle: -20°C ~ +105°C (M12 x 1.25) -40°C ~ +105°C (M12 x 1.5)
More to know	Thermal Shock: EIA 364-32 or IEC 60512-11d UV Resistant: F1

# Physical Dimension

## Receptacle

M12\*1.25  
Panel Cut-Out

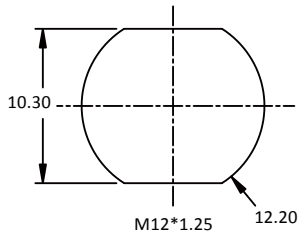

Connector Dimension

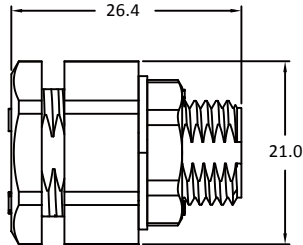

M12\*1.5  
Panel Section

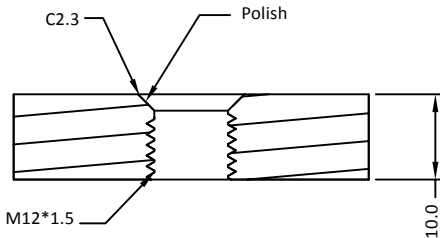

Connector Dimension

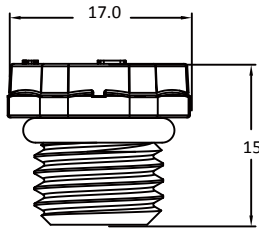

# Find Our Standard Products

## Receptacle

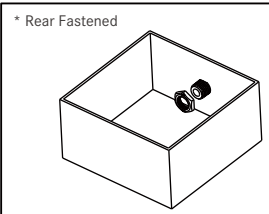
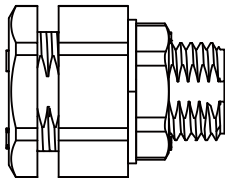

M12\*1.25

VENT-BD001  
VENT-BD002

Different air permeability: 1.VENT-BD001:Air permeability: 12sec/100cm<sup>3</sup>  
2.VENT-BD002:Air permeability: 10sec/100cm<sup>3</sup>

## Receptacle

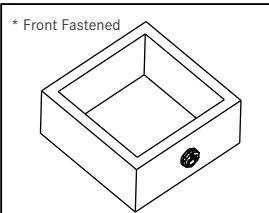
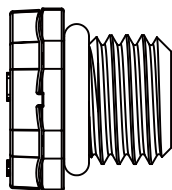

M12\*1.5

VENT-BJ001

Note: VENT-BJ001:Air permeability: 10sec/cm<sup>3</sup>

\* Design and specification are subject to change without notice.

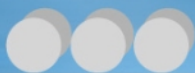

**B.C.E. S.r.l.** - Via Regina Pacis, 54/c - I 41049 Sassuolo (MO), Italy

Tel: (+39) 0536 811616 Fax: (+39) 0536 811500 E-mail: [bce@bce.it](mailto:bce@bce.it) Web: [www.bce.it](http://www.bce.it)

