

DVI Connector



CATALOGUE

DVI Connector



Range Overview

∟ Receptacle to Overmolded with Cable

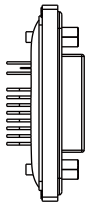

Receptacle

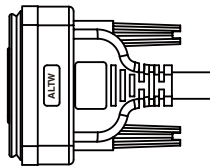

Overmolded with Cable

∟ Accessories

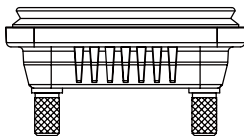

Waterproof Cap

Specification

Identifications	DVI-D Single Link (DDS) : Digital DVI-D Dual Link (DDD) : Digital DVI-I Single Link (DIS) : Digital and Analog DVI-I Dual Link (DID) : Digital and Analog
Description	Receptacle Overmolded with Cable
Current Rating / Data	1.5A
Material	Contacts: Cooper Alloy, Gold Plated Connector Body (Housing): Nylon + GF, UL Recognized Shell: Steel, Nickel Plated
Waterproof Rating	Receptacle: IP68 Overmolded with Cable: IP67
Temperature Range	Receptacle: -20°C~80°C Overmolded with Cable: -20°C~80°C
Contact Resistance	≤ 20mΩ
Insulation Resistance	≥ 1000MΩ at DC500V
Durability	100 cycles
Breakdown Voltage	≥ AC 500V / 1 minute
More to know	Standard Cable Length: 01~05M

【Note】 Design and specification are subject to change without notice.

Ordering Information



Specification	
(DIS) DVI-I Single Link	(DDS) DVI-D Single Link
(DID) DVI-I Dual Link	(DDD) DVI-D Dual Link
* For digital and analog, please choose DVI-I	
* For digital only, please choose DVI-D	
Number of Contacts	
19, 23, 25, 29... Contacts	
e.g. 19 Pin = (19)	
Connector Body (Style)	
> <u>For Receptacle</u>	> <u>For Overmolded with Cable</u>
(P) Front Fastened	(A) With Strain Relief
Connector (Housing) Gender	
(M) Male	(F) Female
Contact Gender	
(M) Male	(F) Female
Assemble Style	
> <u>For Receptacle</u>	> <u>For Overmolded with Cable</u>
(S) Solder Type (P) Front Fastened	(M) Overmolded with Cable
Mating Style	
(S) Screw Thread	
Backshell	
> <u>For Receptacle</u>	> <u>For Overmolded with Cable</u>
(L) Straight / Without Board Lock	(L) Straight
Waterproof Rating	
(7) IP 67	
(8) IP 68	
More Information	
> <u>For Receptacle</u>	> <u>For Overmolded with Cable</u>
(001), (002).....	(□)+(■) : Cable Type + Cable Length
Without Cable : Different Versions	e.g. (A01) = UL20276 Cable + 1M
	(□) : Cable Type (■) : Cable Length
(A) UL20276	From 1M to 5M
28AWG/PVC	e.g. (01) = 1M

Physical Dimension

Receptacle

Terminal: Solder Type

Panel Cut-Out

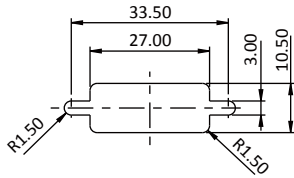

Connector Dimension

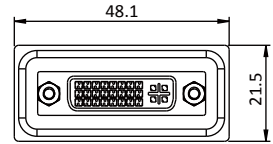
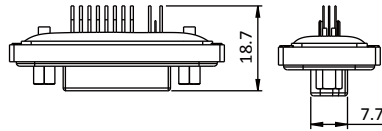

Terminal: PCB Type

Panel Cut-Out

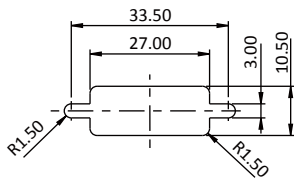

Connector Dimension

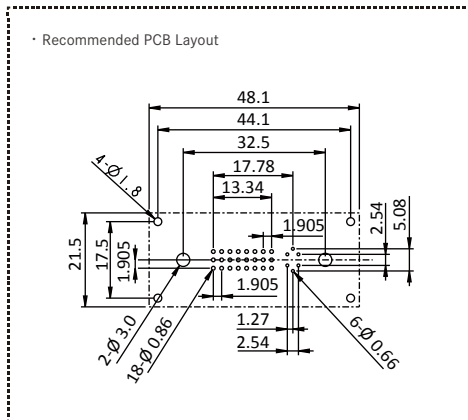
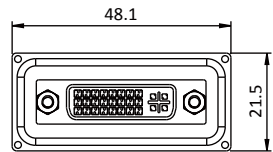
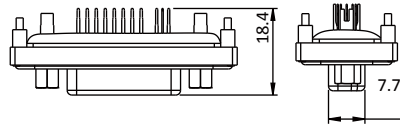

* Unit: mm

* The dimension is feasible for DVI-D Single Link(DDS), DVI-D Dual Link(DDD), DVI-D Single Link(DIS), and DVI-D Dual Link(DID)

Overmolded with Cable

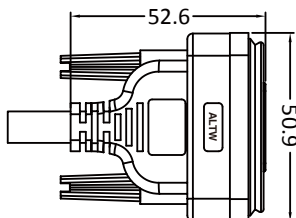

* Unit: mm

* The dimension is feasible for DVI-D Single Link(DDS), DVI-D Dual Link(DDD), DVI-D Single Link(DIS), and DVI-D Dual Link(DID)

【Note】 Design and specification are subject to change without notice.

Contact Configuration

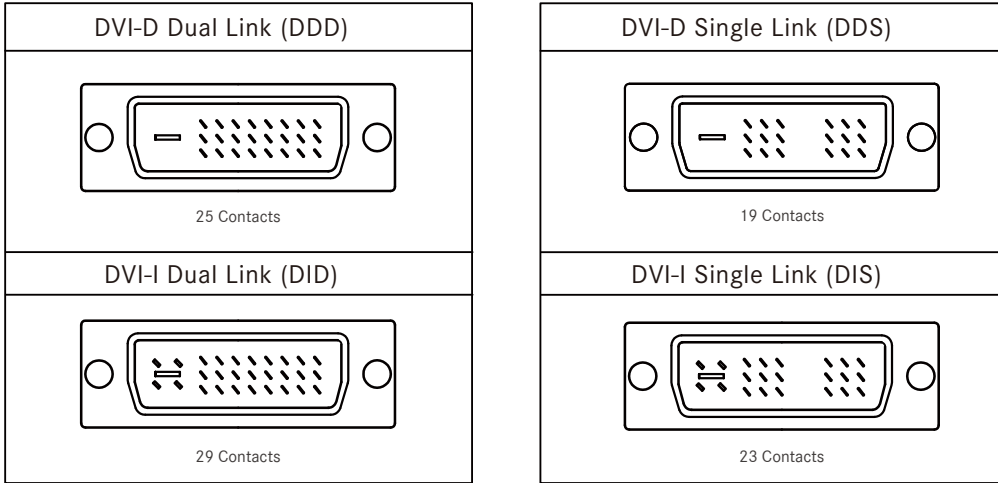

Product Features

Receptacle

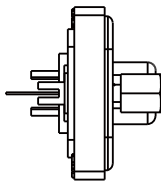

Backshell 8



Mating Style 7



Screw Thread (S)

Connector Body(Style) 3

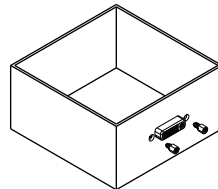

Front Fastened (P)

Overmolded with Cable

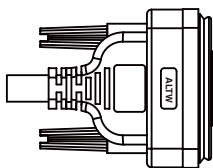

Backshell 8



Mating Style 7



Screw Thread (S)

Connector Body(Style) 3

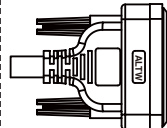

With Strain Relief (A)

Find Our Standard Products

▾ Receptacle and Mating Pair

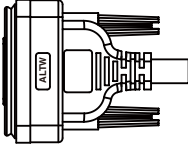
<ul style="list-style-type: none"> • Female Connector (Housing) • Female Contacts • Screw Thread • Terminal: Solder Type 	Receptacle 	Overmolded with Cable 	Field Installable
Code	Female Connector (F) Female Contacts (F)	Male Connector (M) Male Contacts (M)	Male Connector (M) Male Contacts (M)
DVI-D Single Link (DDS)	DDS-19PFFS-SL8001	DDS-19AMMM-SL7A <u>XX</u> *	-
DVI-D Dual Link (DDD)	DDD-25PFFS-SL8001	DDD-25AMMM-SL7A <u>XX</u> *	-
DVI-I Single Link (DIS)	DIS-23PFFS-SL8001	DIS-23AMMM-SL7A <u>XX</u> *	-
DVI-I Dual Link (DID)	DID-29PFFS-SL8001	DID-29AMMM-SL7A <u>XX</u> *	-

【Note】 For digital and analog, please choose DVI-I
 For digital only, please choose DVI-D

* XX: Choose UL20276 cable and select the cable length from 01~05m

▾ Receptacle and Mating Pair

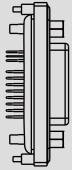
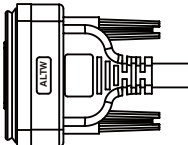
<ul style="list-style-type: none"> • Female Connector (Housing) • Female Contacts • Screw Thread • Terminal: PCB Type 	Receptacle 	Overmolded with Cable 	Field Installable
Code	Female Connector (F) Female Contacts (F)	Male Connector (M) Male Contacts (M)	Male Connector (M) Male Contacts (M)
DVI-D Single Link (DDS)	DDS-19PFFP-SL8001	DDS-19AMMM-SL7A <u>XX</u> *	-
DVI-D Dual Link (DDD)	DDD-25PFFP-SL8001	DDD-25AMMM-SL7A <u>XX</u> *	-
DVI-I Single Link (DIS)	DIS-23PFFP-SL8001	DIS-23AMMM-SL7A <u>XX</u> *	-
DVI-I Dual Link (DID)	DID-29PFFP-SL8001	DID-29AMMM-SL7A <u>XX</u> *	-

【Note】 For digital and analog, please choose DVI-I
 For digital only, please choose DVI-D

* XX: Choose UL20276 cable and select the cable length from 01~05m

【Note】 Design and specification are subject to change without notice.

Accessories

Waterproof Cap

■ Customized - Upon Request

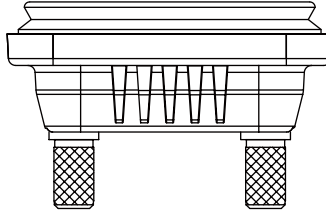

Type	Mating Pairs	Mating Style	Mating Pair (Gender)	P/N
DVI	Receptacle	Screw Thread	Male & Female	CAP-WDVCSPA1



B.C.E. S.r.l. - Via Regina Pacis, 54/c - I 41049 Sassuolo (MO), Italy

Tel: (+39) 0536 811616 Fax: (+39) 0536 811500 E-mail: bce@bce.it Web: www.bce.it

