

**SBT simplifies Burn-in and Test Challenges down to 0.4mm pitch**

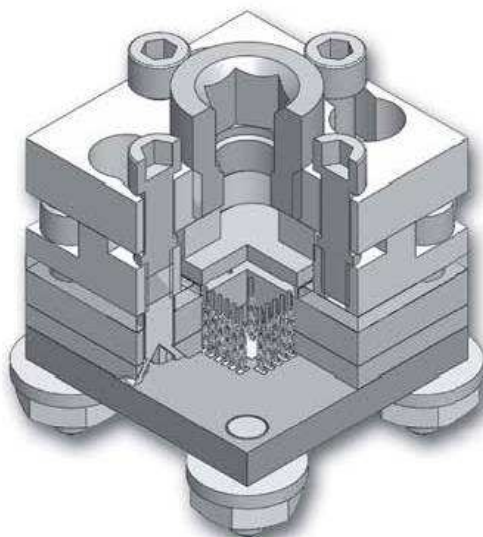

Ironwood Electronics' SBT sockets are small footprint sockets. The socket needs about 2.5mm extra space around the chip than the actual chip size, utilizing only very small PCB real estate. A clamshell lid with a wave spring provides the compression force. This mechanism provides easy chip replacement and compatible with an automated handler system also. If heat dissipation is of concern, a heat sink can be integrated in the middle of the clamshell lid to dissipate up to 100 watts.

The 0.4mm pitch SBT socket uses innovative contact technology for high endurance and wide temperature applications. The 0.4mm pitch SBT Contact is an etched contact with outside spring that provides a robust solution for Burn-in & Test applications. Solutions are available for 0.4mm to 1.27mm LGA, BGA, QFN, QFP, SOIC and other packages. The SBT contact technology has 3 part system which includes top plunger, bottom plunger and a spring. The BeCu alloy plungers are etched/stamped, plated and assembled to a stainless steel gold plated spring inside a high temperature plastic cavity eliminating the need for an external shell or barrel.

Typical specifications for the 0.4mm SBT contact technology include:

- Over 34GHz bandwidth @-1dB
- Contact resistance under 50mΩ
- Loop inductance under 0.95nH
- Capacitance under 0.06pF
- Operating temperature range -55C to +155C
- Insertion/Extraction life over 500, 000 cycles
- Current rating at ambient is 2.6 Amps per pin

There are three options available to mount these sockets. The socket can be mounted using hardware and needs holes for screws and can be positioned on the target board. If the holes cannot be drilled on the target board, epoxy mount sockets are the alternate option. Epoxy mount sockets use epoxy and special mechanism to mount the socket on the target board. The third option is using SMT emulator base. The SMT emulator base has balls on the bottom side that precisely matches the device array and has hardware for socket mounting.

We can accommodate Kelvin applications using these new 0.4mm pitch SBT technology which uses offset plunger tips. Visit our web site for technical documents and socket drawings.



**DOWNLOAD**

Download complete Catalogue or Tech. Specifications from our website: [www.bce.it](http://www.bce.it)

(October, 2011)